

PROJECT INFORMATION		
JOB NAME		TYPE
ORDERING CODE		

NU essentials

4" Round & Square Wall Wash Standard White



WW BEAM		
(Note: Specifications are subject to change without notice)		
14mm COB PERFORMANCE DATA		
LED LIGHT ENGINE	NOMINAL DELIVERED LUMENS	SYSTEM WATTAGE
07LM	620LM @30K/90CRI	10.5W
10LM	890LM @30K/90CRI	15.5W
13LM	1150LM @30K/90CRI	20.5W
Notes	Delivered lumens based on WW optic (see page 2)	



FEATURES

- Economical choice for budget projects
- Thermally optimized for LED longevity
- Fully casted assembly
- Packaging material consists of 60-80% post-consumer recycled fiber

DIMMING AND CONTROLS

- Flicker free 0-10V dimming to 1%
- Leading & trailing edge (Triac/ELV) dimming to 1%

CONSTRUCTION

- Aluminum trim and bezel
- Electrocoated 16-gauge cold-rolled steel construction
- Accommodates ceiling thickness from 1/8" to 1-5/8"

LED

- 90 CRI: SDCM = 2-step MacAdam Ellipse, Lumen Maintenance: $L_{70} > 66,000$ hrs

LISTING

- ULus Listed to UL1598 & UL2108; cUL Listed to CSA C22.2 #250.0
- NSF/ANSI-2 with lens (Non-Food and Splash Zones)
- IP44 with lens - suitable for wet location with lens - suitable damp location without lens
- 5 Year Limited warranty

ELECTRICAL

- 120V-277V, 120 only Triac / ELV
- Power factory ≥ 0.9
- 2kV driver input surge protection
- 10W (T20 CEC) EM 90min battery
- Max. ambient installation temperature 104°F (40°C)

FIXTURE HEIGHT

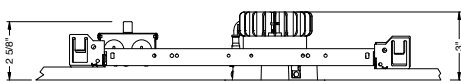

ROUND

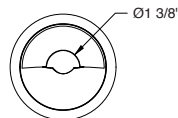

ceiling cutout
4" diameter
ceiling thickness
1/4" to 1"

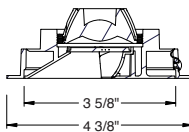

aperture dimensions

SQUARE

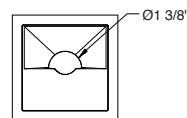

ceiling cutout
4" x 4" square
ceiling thickness
1/4" to 1"

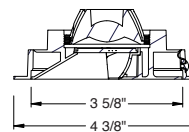

aperture dimensions

alphabet

PROJECT INFORMATION		
JOB NAME		TYPE
ORDERING CODE		

WW BEAM ORDERING CODE		
SERIES	NUE4	NUE
TYPE	RW	round wall wash
	QW	square wall wash
LED	SW	standard white
DELIVERED LUMENS	07LM	620 lm
	10LM	890 lm
	13LM	1150 lm
Standard Configuration: 3000K 90CRI WW		
CCT	27K	2700K
	30K	3000K
	35K	3500K
	40K	4000K
CRI	90	90 CRI
OPTIC & LM MULTIPLIER SEE PAGE 3	WW	wall wash
TRIM COLOR	WH	white
BEZEL COLOR	WH	white (1.00)

WW BEAM ORDERING CODE		
MOUNTING OPTIONS SEE PAGE 4, 5	NC	new construction with ceiling fitting plate
	NCIC²	new construction with ceiling fitting plate, insulation contact rated (no housing required)
	IC¹	insulation contact housing
	ICAT¹	insulation contact/airtight housing
	CP	chicago plenum housing
	RET	retrofit, no ceiling fitting plate
	RETIC²	retrofit, no ceiling fitting plate, insulation contact rated (no housing required)
VOLTAGE	120	120V
	UNV	120V-277V
DIMMING	DIM10	0-10V dimming to 1%
	ELV1³	leading & trailing edge (Triac/ELV) dimming to 1%
ELECTRICAL OPTIONS	EM10CA20	emergency battery backup, 90 minutes at 10W to LED, CA title 20

ADDITIONAL MOUNTING INFO	
New Construction Bar Hangers (included)	Mounting Length: 14-3/4" to 26"
Extension Kit p/n: K20266 (ordered separately, 1 per fixture)	Extends a pair of Bar Hangers Total Mounting Length: 29" to 48"

YOUR COMPLETED ORDERING CODE
Follow the steps to specify your fixture, example:
NUE4 - RW - SW - 10LM - 30K - 90 - WW - WH - WH - NC - UNV - DIM10

NOTES

1. WW lens options with IC or ICAT housing are JA8 compliant.
2. NCIC & RETIC available in 07LM, rated for insulation contact (IC), no "IC-housing" required.
3. ELV1 available in 120V.

PROJECT INFORMATION		
JOB NAME		TYPE
ORDERING CODE		

PHOTOMETRIC DATA CHARTS

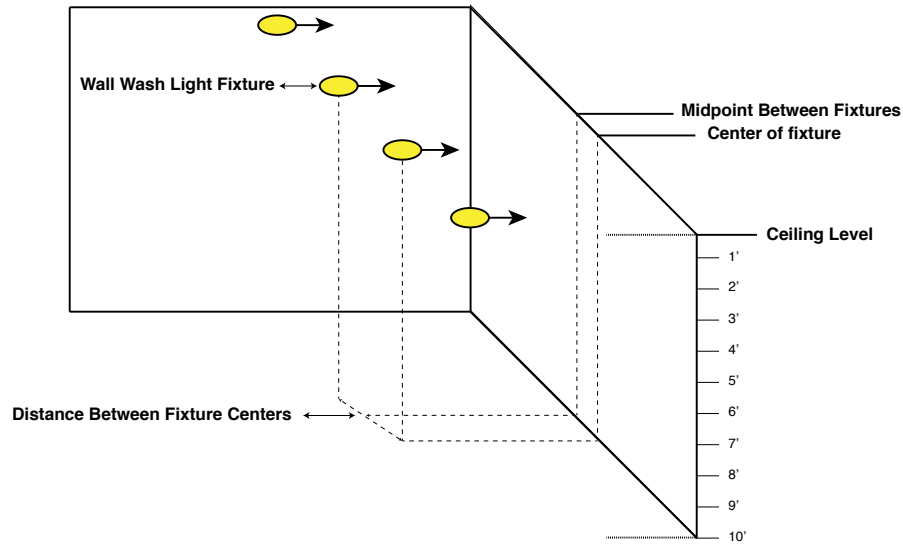

FOOT CANDLE MEASUREMENT

Static White Wall Wash 13LM, 90CRI, 3000K												
MOUNTING DISTANCE	2' FROM WALL				3' FROM WALL				4' FROM WALL			
FIXTURE SPACING	2' ON CENTER		3' ON CENTER		3' ON CENTER		4' ON CENTER		4' ON CENTER		5' ON CENTER	
DISTANCE FROM CEILING	CENTER	MID POINT	CENTER	MID POINT	CENTER	MID POINT	CENTER	MID POINT	CENTER	MID POINT	CENTER	MID POINT
1'	44.1	42.3	34.1	24.4	15.3	14.3	12.8	9.6	6.7	6.2	5.8	4.5
2'	41.1	40.2	30.6	25.5	20.4	20.2	16.3	14.6	11	10.6	9.4	8
3'	34.5	33.9	26.2	22	18.3	17.9	14.8	13.1	11.3	11.1	9.4	8.8
4'	29.7	29.5	22.3	19.6	16.1	15.8	13.1	11.7	10.3	10.1	8.7	7.9
5'	24.6	24.8	18.2	17	14.6	14.4	11.9	10.8	9.3	9.1	7.9	7.3
6'	19.7	19.9	14.4	14.1	13.2	13.1	10.7	10	8.6	8.5	7.3	6.8
7'	15.5	15.7	11.5	11.4	11.7	11.7	9.4	9	8	7.9	6.8	6.4
8'	12.2	12.4	9.2	9.2	10.2	10.3	8.2	8	7.4	7.4	6.3	6
9'	9.6	9.8	7.4	7.5	8.7	8.8	7	7	6.8	6.8	5.7	5.6
10'	7.7	7.8	6	6.1	7.5	7.6	6	6	6.1	6.2	5.2	5.1
11'	6.2	6.3	4.9	5	6.3	6.5	5.2	5.2	5.5	5.6	4.7	4.6
12'	5.1	5.2	4.1	4.2	5.4	5.5	4.5	4.5	4.9	5	4.2	4.2

Static White Wall Wash 10LM, 90CRI, 3000K												
MOUNTING DISTANCE	2' FROM WALL				3' FROM WALL				4' FROM WALL			
FIXTURE SPACING	2' ON CENTER		3' ON CENTER		3' ON CENTER		4' ON CENTER		4' ON CENTER		5' ON CENTER	
DISTANCE FROM CEILING	CENTER	MID POINT	CENTER	MID POINT	CENTER	MID POINT	CENTER	MID POINT	CENTER	MID POINT	CENTER	MID POINT
1'	34.3	32.9	26.4	18.9	11.9	11.1	9.9	7.4	5.2	4.8	4.5	3.5
2'	31.9	31.2	23.8	19.8	15.8	15.7	12.6	11.3	8.6	8.2	7.3	6.2
3'	26.7	26.3	20.3	17.1	14.2	13.9	11.5	10.2	8.8	8.6	7.3	6.8
4'	23	22.9	17.3	15.2	12.5	12.3	10.2	9.1	8	7.8	6.7	6.2
5'	19.1	19.2	14.1	13.2	11.3	11.2	9.2	8.4	7.2	7.1	6.1	5.7
6'	15.3	15.4	11.2	11	10.2	10.2	8.3	7.7	6.7	6.6	5.7	5.3
7'	12	12.2	8.9	8.9	9.1	9.1	7.3	7	6.2	6.2	5.3	5
8'	9.4	9.6	7.1	7.2	7.9	8	6.3	6.2	5.8	5.7	4.9	4.7
9'	7.5	7.6	5.7	5.8	6.8	6.9	5.5	5.4	5.3	5.3	4.5	4.3
10'	6	6.1	4.7	4.7	5.8	5.9	4.7	4.7	4.8	4.8	4	4
11'	4.8	4.9	3.8	3.9	4.9	5	4	4.1	4.3	4.3	3.6	3.6
12'	3.9	4	3.2	3.3	4.2	4.3	3.5	3.5	3.8	3.9	3.2	3.2

NOTE

1. Performance based on typical reflectance values and room dimensions. IES files available at ledrabrands.com

PROJECT INFORMATION		
JOB NAME		TYPE
ORDERING CODE		

PHOTOMETRIC DATA CHARTS (CONTINUED)

Static White Wall Wash 07LM, 90CRI, 3000K												
MOUNTING DISTANCE	2' FROM WALL				3' FROM WALL				4' FROM WALL			
FIXTURE SPACING	2' ON CENTER		3' ON CENTER		3' ON CENTER		4' ON CENTER		4' ON CENTER		5' ON CENTER	
DISTANCE FROM CEILING	CENTER	MID POINT	CENTER	MID POINT	CENTER	MID POINT	CENTER	MID POINT	CENTER	MID POINT	CENTER	MID POINT
1'	23.9	22.9	18.4	13.2	8.3	7.7	6.9	5.2	3.6	3.3	3.1	2.4
2'	22.2	21.8	16.5	13.8	11	10.9	8.8	7.9	6	5.7	5.1	4.3
3'	18.6	18.3	14.2	11.9	9.9	9.7	8	7.1	6.1	6	5.1	4.7
4'	16	16	12	10.6	8.7	8.6	7.1	6.4	5.5	5.4	4.7	4.3
5'	13.3	13.4	9.8	9.2	7.9	7.8	6.4	5.9	5	4.9	4.3	3.9
6'	10.6	10.8	7.8	7.6	7.1	7.1	5.8	5.4	4.7	4.6	4	3.7
7'	8.4	8.5	6.2	6.2	6.3	6.3	5.1	4.9	4.3	4.3	3.7	3.5
8'	6.6	6.7	5	5	5.5	5.6	4.4	4.3	4	4	3.4	3.2
9'	5.2	5.3	4	4	4.7	4.8	3.8	3.8	3.7	3.7	3.1	3
10'	4.1	4.2	3.2	3.3	4	4.1	3.3	3.3	3.3	3.3	2.8	2.8
11'	3.3	3.4	2.7	2.7	3.4	3.5	2.8	2.8	3	3	2.5	2.5
12'	2.7	2.8	2.2	2.3	2.9	3	2.4	2.4	2.7	2.7	2.2	2.2

NOTE
1. Performance based on typical reflectance values and room dimensions. IES files available at ledrabrands.com

MOUNTING OPTIONS

FIXTURE HEIGHT

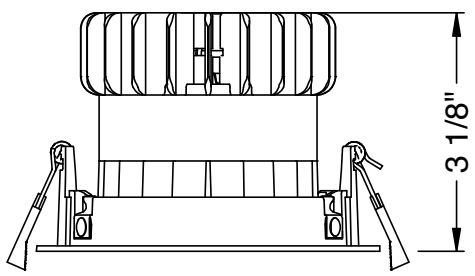

NC - NEW CONSTRUCTION

TRIM

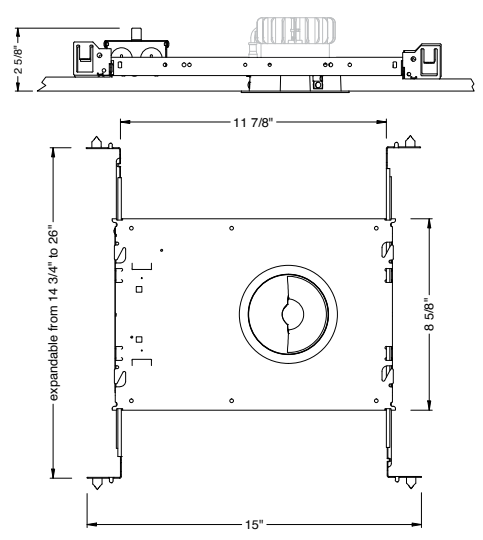

ROUND

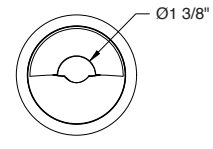

ceiling cutout
4" diameter
ceiling thickness
1/4" to 1"

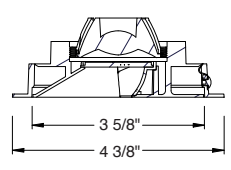

aperture dimensions

SQUARE

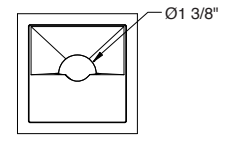

ceiling cutout
4" x 4" square
ceiling thickness
1/4" to 1"

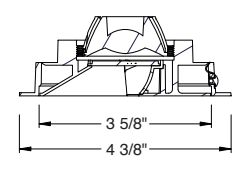

aperture dimensions

PROJECT INFORMATION		
JOB NAME		TYPE
ORDERING CODE		

MOUNTING OPTIONS (CONTINUED)

NC - RET - NCIC - RETIC

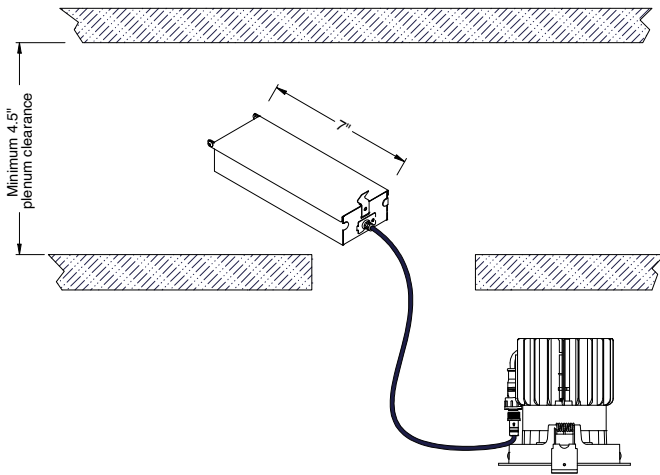

IC - INSULATION CONTACT HOUSING ICAT - INSULATION CONTACT / AIR TIGHT CP - CHICAGO PLENUM

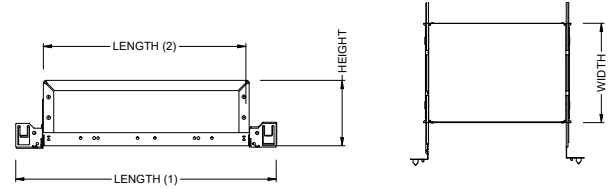

BOX SIZE	L 1	L 2	W	H
A	15 - 7/16"	11 - 3/4"	8 - 1/2"	6 - 3/4"

RATINGS / CERTIFICATIONS	NC	RET	IC	ICAT	CP	NCIC	RETIC
TYPE NON-IC	✓	✓					
TYPE IC			✓	✓		✓	✓
CHICAGO PLENUM (CCEA)					✓		
SUITABLE FOR AIR HANDLING PLENUMS	✓	✓	✓	✓	✓	✓	✓

BOX TYPE / LUMEN OUTPUT - STANDARD BEAMS (WW)			
LUMEN OUTPUT	BOX - A		
	IC	ICAT	CP
07LM	✓	✓	✓
10LM	✓	✓	✓
13LM	✓	✓	✓

CEILING THICKNESS	
FIXTURE TYPE	MOUNTING TYPE
	STANDARD CEILING THICKNESS
TRIM	1/4" to 1"

PROJECT INFORMATION		
JOB NAME		TYPE
ORDERING CODE		

BATTERY OPTIONS

EMERGENCY BATTERY

IOTA's ILB Battery Backups are UL Listed LED emergency drivers that allow the same LED fixture to be used for both normal and emergency operation. In the event of a power failure, the ILB switches to the emergency mode and operates the existing fixture for 90 minutes. The unit contains a battery, charger, and converter circuit in a single can. The Constant Power design of the ILB maintains the output wattage to the LED array even as the system voltage diminishes. UL 924 Listed for U.S. and Canada. UL 1310 Certified, Output Class 2 Compliant. Includes single-piece TBTS test switch and charge indicator accessory kit. For use with switched and unswitched fixtures, and includes Two-wire universal AC input. Meets or exceeds all National Electric Code and Life Safety Code Emergency Lighting Requirements. Rated for use in Plenum, Damp Location, Recessed Type IC, and Enclosed and Gasketed Luminares.

REMOTE TEST SWITCH

The Remote Test Switch may be mounted adjacent to the LED Fixture by others.

EMERGENCY BATTERY ACCESS

Above ceiling access is required.

REMOTE LOCATION

Maximum remote mounting distance of the emergency driver shall be 50 feet. Remote location wiring provided by others. Follow all Local and National Electric/ Building Codes.

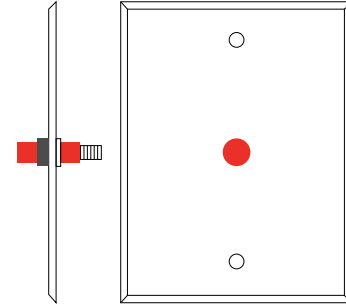

Remote Test Switch

EM MODE OUTPUT (DELIVERED LUMENS)	
LUMEN ORDERING CODE	EM10
10 LM OPTION	990LM
Notes: Based on 30K, 90CRI	

NC - NEW CONSTRUCTION WITH EM BATTERY (REMOTE TEST SWITCH)

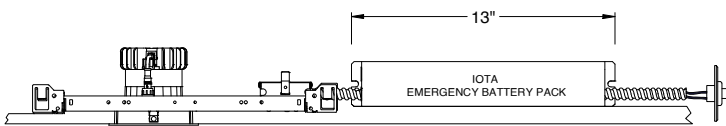

IC / ICAT / CP - INSULATION CONTACT HOUSING WITH EM BATTERY (REMOTE TEST SWITCH)

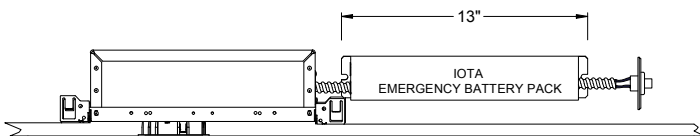

RET - RETROFIT WITH EM BATTERY (REMOTE TEST SWITCH)

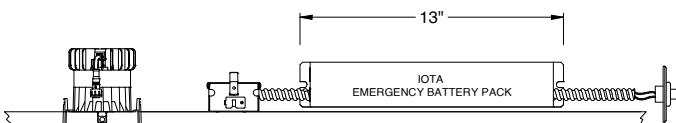

Accessory

76066 Optional T-Grid Mounting Kit¹

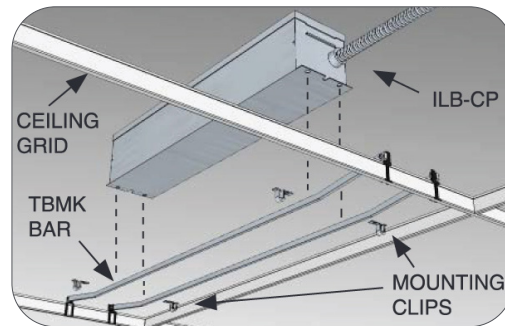

1. Can be used with any of the Emergency Battery Backups. Must be ordered as a separate line item.