

PROJECT INFORMATION		
JOB NAME		TYPE
ORDERING CODE		

NU essentials

4" Round & Square Adjustable Standard White



30° - 80° BEAM (Note: Specifications are subject to change without notice)		
14mm COB PERFORMANCE DATA		
LED LIGHT ENGINE	NOMINAL DELIVERED LUMENS	SYSTEM WATTAGE
10LM	1070LM @30K/90CRI	11W
13LM	1360LM @30K/90CRI	14W
15LM	1560LM @30K/90CRI	16W
20LM	2000LM @30K/90CRI	21W
Notes	Delivered lumens based 40D with no lens (see page 2)	



FEATURES

- Economical choice for budget projects
- Thermally optimized for LED longevity
- 30° tilt, tool-less hot aiming
- Fully casted assembly
- 30° - 80° optical beam control
- Packaging material consists of 60-80% post-consumer recycled fiber

LED

- 90 CRI: SDCM = 2-step MacAdam Ellipse, Lumen Maintenance: $L_{70} > 66,000$ hrs

DIMMING AND CONTROLS

- Flicker free 0-10V dimming to 1%
- Leading & trailing edge (Triac/ELV) dimming to 1%

LISTING

- ULus Listed to UL1598; cUL Listed to CSA C22.2 #250.0
- NSF/ANSI-2 with lens (Non-Food and Splash Zones)
- IP44 with lens - suitable for wet location with lens - suitable damp location without lens
- 5 Year Limited warranty

CONSTRUCTION

- Aluminum trim and bezel
- Electrocoated 16-gauge cold-rolled steel construction
- Accommodates ceiling thickness from 1/8" to 1-5/8"

ELECTRICAL

- 120V-277V, 120 only Triac / ELV
- Power factory ≥ 0.9
- 2kV driver input surge protection
- 10W (T20 CEC) EM 90min battery
- Max. ambient installation temperature 104°F (40°C)

FIXTURE HEIGHT

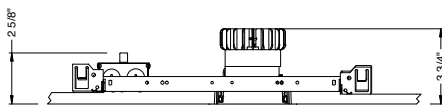

ROUND

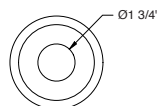

ceiling cutout
4" diameter
ceiling thickness
1/4" to 1"

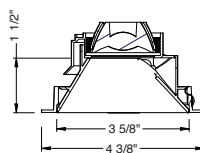

aperture dimensions

SQUARE

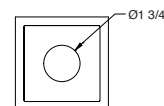

ceiling cutout
4" x 4" square
ceiling thickness
1/4" to 1"

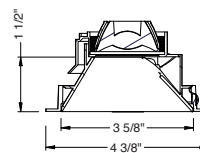

aperture dimensions

alphabet

PROJECT INFORMATION		
JOB NAME		TYPE
ORDERING CODE		

30°- 80° BEAM ORDERING CODE

SERIES	NUE4	NUE					
TYPE	RA	round adjustable					
	QA	square adjustable					
LED	SW	standard white					
DELIVERED LUMENS	10LM	1070 lm					
	13LM	1360 lm					
	15LM	1560 lm					
	20LM	2000 lm					
Standard Configuration: 3000K 90CRI 40D NL							
Calculated Delivered Lumens = [Delivered Lumen Value] x [CCT Multiplier] x [Reflector Multiplier]							
CCT	27K	2700K	CCT	2700K	3000K	3500K	4000K
	30K	3000K	CRI	90+	90+	90+	90+
	35K	3500K	CCT MULTIPLIER FOR LUMEN OUTPUT	.96	1	1.03	1.06
	40K	4000K					
CRI	90	90 CRI					
OPTIC & LM MULTIPLIER SEE PAGE 3	30D	30 degrees					(0.95)
	40D	40 degrees					(1.00)
	60D	60 degrees					(1.00)
For 80° choose '60D' + 'DL' lens.							
LENS	NL¹	no lens					(1.00)
	CL²	clear lens					(0.95)
	DL²	diffused lens					(0.76)
	HET²	high efficiency textured lens, similar to Solite™					(0.92)
	HCL³	honeycomb louver					(0.64)
TRIM COLOR	WH	white					
BEZEL COLOR	WH	white					(1.00)

30°- 80° BEAM ORDERING CODE

MOUNTING OPTIONS SEE PAGE 4, 6	NC	new construction with ceiling fitting plate
	NCIC⁴	new construction with ceiling fitting plate, insulation contact rated (no housing required)
	IC²	insulation contact housing
	ICAT²	insulation contact/airtight housing
	CP	chicago plenum housing
	RET	retrofit, no ceiling fitting plate
	RETIC⁴	retrofit, no ceiling fitting plate, insulation contact rated (no housing required)
VOLTAGE	I20	120V
	UNV	120V-277V
DIMMING	DIM10	0-10V dimming to 1%
	ELV1⁵	leading & trailing edge (Triac/ELV) dimming to 1%
ELECTRICAL OPTIONS	EM10CA20	emergency battery backup, 90 minutes at 10W to LED, CA title 20

ADDITIONAL MOUNTING INFO

New Construction Bar Hangers (included)	Mounting Length: 14-3/4" to 26"
Extension Kit p/n: K20266 (ordered separately, 1 per fixture)	Extends a pair of Bar Hangers Total Mounting Length: 29" to 48"

YOUR COMPLETED ORDERING CODE

Follow the steps to specify your fixture, example:
NUE4 - RA - SW - 20LM - 30K - 90 - 30D - NL - WH - WH - NC - UNV - DIM10

NOTES

- NL lens option does not meet requirements for WET/NSF listings.
- CL/DL/HET lens options with IC or ICAT housing are JA8 compliant.
- HCL cannot be used with lens (max 1 media).
- NCIC/RETIC are available in 10LM/13LM rated for insulation contact (IC), no "IC-Housing" required.
- ELV1 available in 120V.

alphabet

PROJECT INFORMATION		
JOB NAME		TYPE
ORDERING CODE		

TRIM OPTIONS

TRIM/BEZEL COLORS

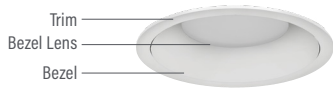

WH

OPTICAL OPTIONS

- UGR calculation based on CIE 117-1995; room size: 4H X 8H, reflectance: 70/50/20;
- UGR calculation based on 15LM fixtures, unless otherwise noted.

HCL

Honeycomb Louver



OPTIC	BEAM ANGLE	UGR
30D	30	8.5
40D	37	7.7
60D	47	13.9

NL

No Lens



OPTIC	BEAM ANGLE	UGR
30D	31	14
40D	41	11
60D	58	17.9

CL

Clear Lens



OPTIC	BEAM ANGLE	UGR
30D	32	13.4
40D	42	11.9
60D	58	17.9

DL

Diffused Lens



OPTIC	BEAM ANGLE	UGR
30D	65	21.2
40D	70	22.3
60D	80	23.2

HET

High Efficiency Textured Lens



OPTIC	BEAM ANGLE	UGR
30D	34	13.5
40D	41	13.9
60D	56	18.8

alphabet

PROJECT INFORMATION		
JOB NAME		TYPE
ORDERING CODE		

PHOTOMETRIC DATA

10LM CCT MULTIPLIERS

	90CRI
2700K	0.96
3000K	1
3500K	1.03
4000K	1.06

FC Formula = CBCP / Distance²

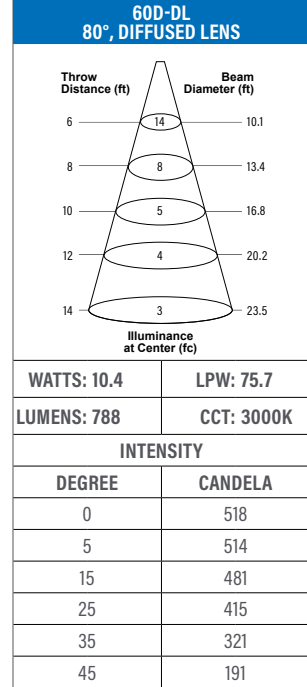
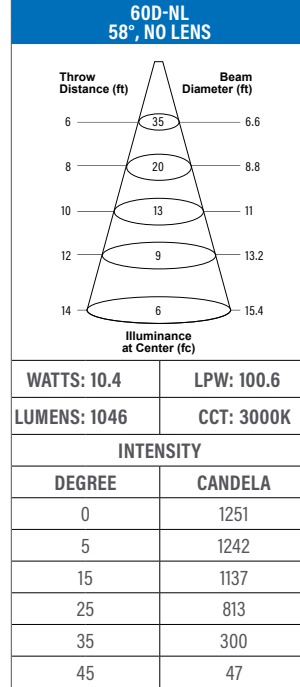
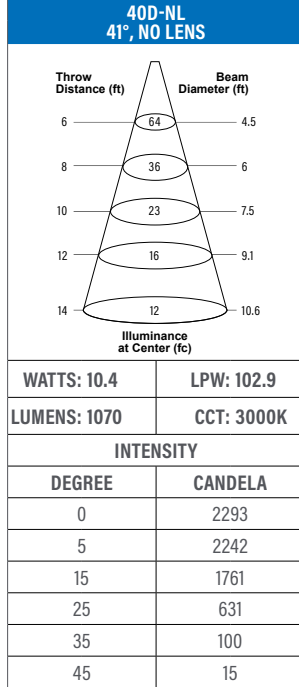
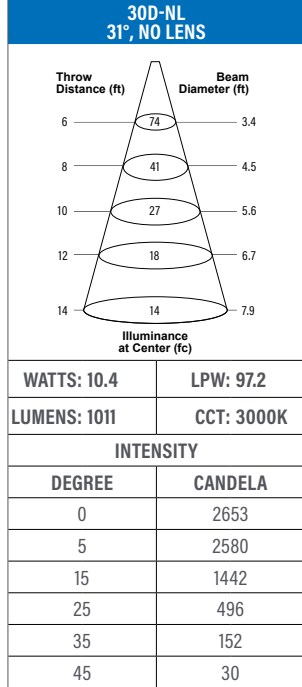

20LM CCT MULTIPLIERS

	90CRI
2700K	0.96
3000K	1
3500K	1.03
4000K	1.06

FC Formula = CBCP / Distance²

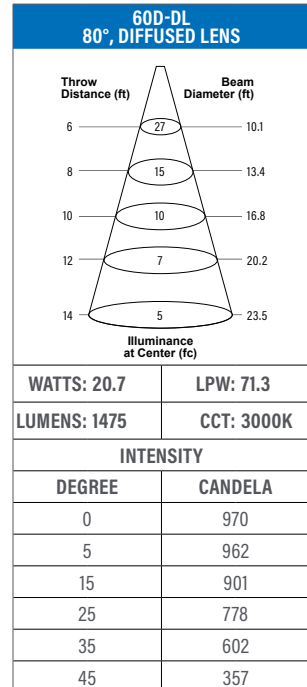
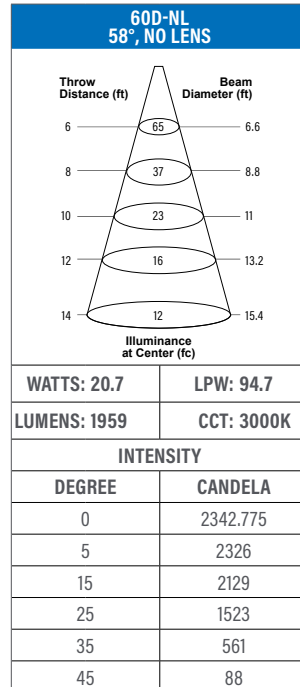
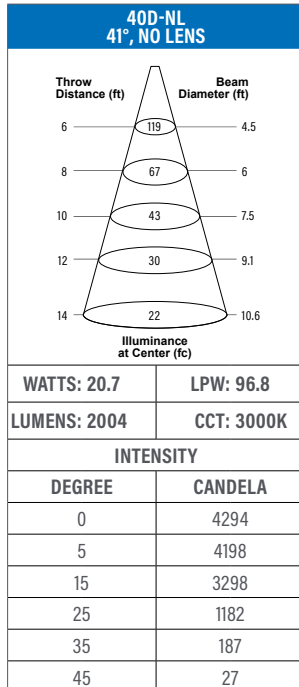
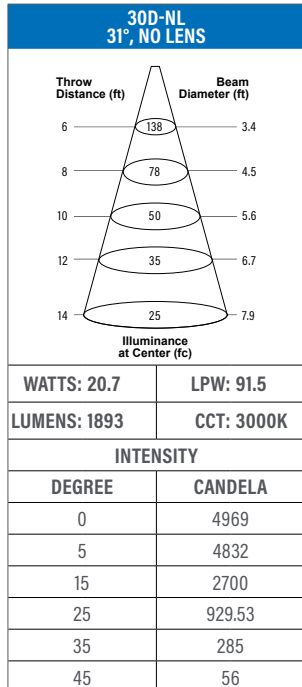

alphabet

PROJECT INFORMATION		
JOB NAME		TYPE
ORDERING CODE		

MOUNTING OPTIONS

FIXTURE HEIGHT

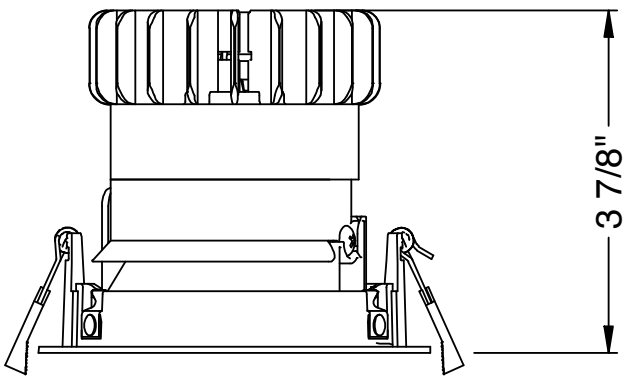

NC - NEW CONSTRUCTION

TRIM

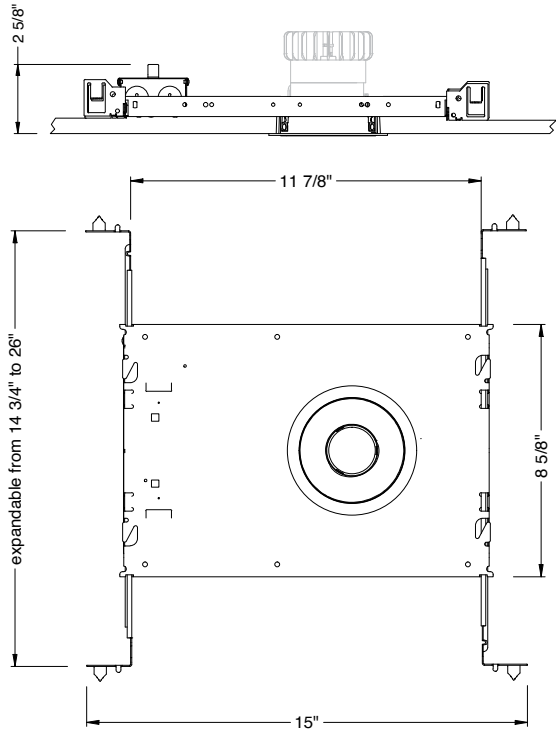

ROUND

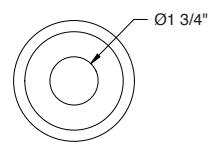

ceiling cutout
4" diameter
ceiling thickness
1/4" to 1"

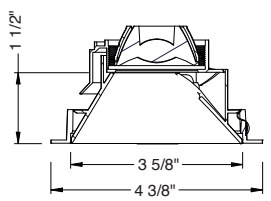

aperture dimensions

SQUARE

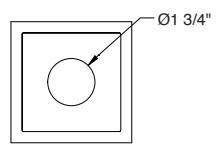

ceiling cutout
4" x 4" square
ceiling thickness
1/4" to 1"

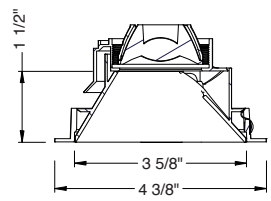

aperture dimensions

PROJECT INFORMATION		
JOB NAME		TYPE
ORDERING CODE		

MOUNTING OPTIONS (CONTINUED)

NC - RET - NCIC - RETIC

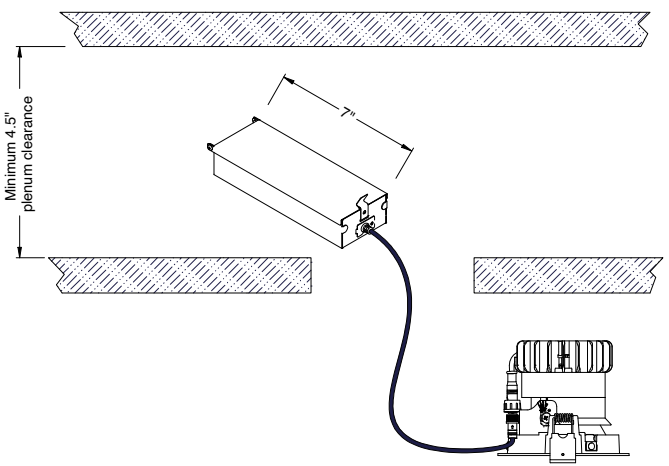

RATINGS / CERTIFICATIONS	NC	RET	IC	ICAT	CP	NCIC	RETIC
TYPE NON-IC	✓	✓					
TYPE IC			✓	✓		✓	✓
CHICAGO PLENUM (CCEA)					✓		
SUITABLE FOR AIR HANDLING PLENUMS	✓	✓	✓	✓	✓	✓	✓

CEILING THICKNESS	
FIXTURE TYPE	MOUNTING TYPE
	STANDARD CEILING THICKNESS
TRIM	1/4" to 1"

IC - INSULATION CONTACT HOUSING ICAT - INSULATION CONTACT / AIR TIGHT CP - CHICAGO PLENUM

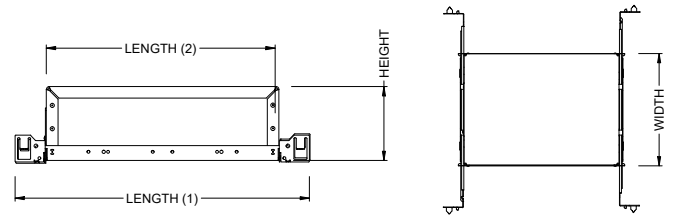

BOX SIZE	L 1	L 2	W	H
A	15 - 7/16"	11 - 3/4"	8 - 1/2"	6 - 3/4"

BOX TYPE / LUMEN OUTPUT - STANDARD BEAMS (30° - 80)			
LUMEN OUTPUT	BOX - A		
	IC	ICAT	CP
10LM	✓	✓	✓
15LM	✓	✓	✓
20LM	✓	✓	✓

PROJECT INFORMATION		
JOB NAME		TYPE
ORDERING CODE		

BATTERY OPTIONS

EMERGENCY BATTERY

IOTA's ILB Battery Backups are UL Listed LED emergency drivers that allow the same LED fixture to be used for both normal and emergency operation. In the event of a power failure, the ILB switches to the emergency mode and operates the existing fixture for 90 minutes. The unit contains a battery, charger, and converter circuit in a single can. The Constant Power design of the ILB maintains the output wattage to the LED array even as the system voltage diminishes. UL 924 Listed for U.S. and Canada. UL 1310 Certified, Output Class 2 Compliant. Includes single-piece TBTS test switch and charge indicator accessory kit. For use with switched and unswitched fixtures, and includes Two-wire universal AC input. Meets or exceeds all National Electric Code and Life Safety Code Emergency Lighting Requirements. Rated for use in Plenum, Damp Location, Recessed Type IC, and Enclosed and Gasketed Luminares.

REMOTE TEST SWITCH

The Remote Test Switch may be mounted adjacent to the LED Fixture by others.

EMERGENCY BATTERY ACCESS

Above ceiling access is required.

REMOTE LOCATION

Maximum remote mounting distance of the emergency driver shall be 50 feet. Remote location wiring provided by others. Follow all Local and National Electric/ Building Codes.

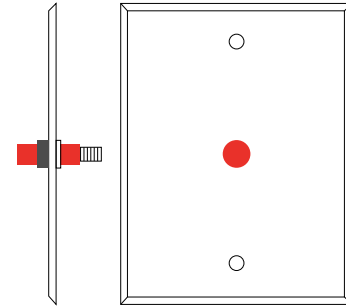

Remote Test Switch

EM MODE OUTPUT (DELIVERED LUMENS)	
LUMEN ORDERING CODE	EM10
10 LM OPTION	990LM
Notes: Based on 30K, 90CRI	

NC - NEW CONSTRUCTION WITH EM BATTERY (REMOTE TEST SWITCH)

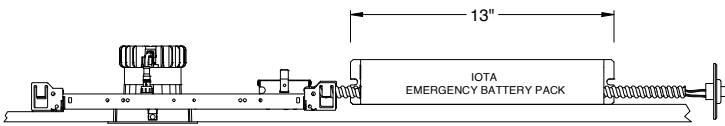

IC / ICAT / CP - INSULATION CONTACT HOUSING WITH EM BATTERY (REMOTE TEST SWITCH)

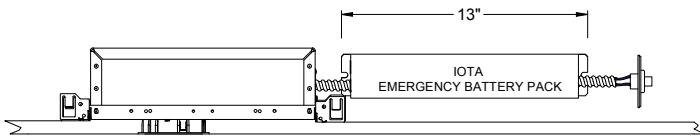

RET - RETROFIT WITH EM BATTERY (REMOTE TEST SWITCH)

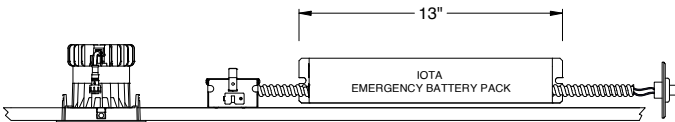

Accessory

76066 Optional T-Grid Mounting Kit¹

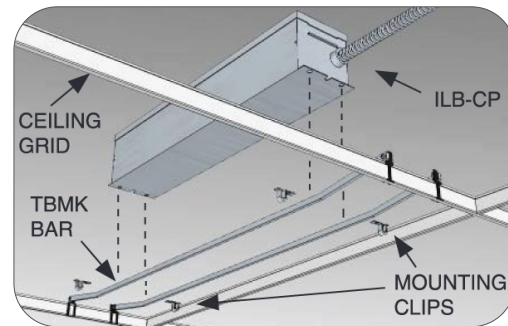

1. Can be used with any of the Emergency Battery Backups. Must be ordered as a separate line item.