

PROJECT INFORMATION		
JOB NAME		TYPE
ORDERING CODE		

## NU4

### 4" Round Downlight RGBW LiteOptics

20° - 40° BEAM (Note: Specifications are subject to change without notice)		
22mm COLOR TUNING MODULE PERFORMANCE DATA		
LED LIGHT ENGINE	NOMINAL DELIVERED LUMENS	SYSTEM WATTAGE
10LM	800LM @30K/90CRI	25W
Notes	Delivered lumens based on CQR-S20, (see page 2)	

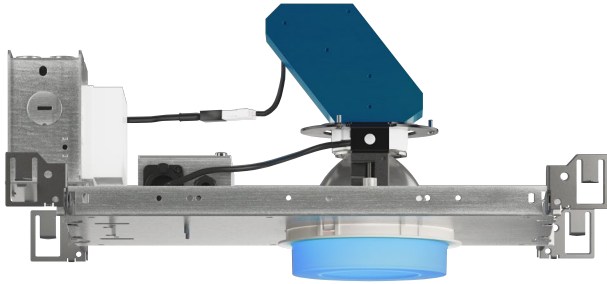

#### FEATURES

- RGB (W) five white CCT options available.
- On-board, closed-loop optical feedback measures the lumen depreciation of each channel and re-balances the color model to ensure color consistency over the life of LED array.
- 20° - 40° optical beam control
- Multiple mounting, trims and finishes available

#### DIMMING AND CONTROLS

- DMX512-A-RDM control, 8 bit channel control with 256 grey bit scale
- BLE mesh network control, profile allows color mixing on Casambi app

#### CONSTRUCTION

- Shatter proof acrylic bezel lens LEXAN™ (PC)
- Optimal connectivity for wireless control signal. Impact and chemical resistant at the highest level. With stands temperatures up to 240°F.
- Electrocoated 16-gauge cold-rolled steel construction
- Accommodates ceiling thickness from 1/8" to 1-5/8"

#### LED

- Lumiled LUXEON C Color Line
- SDCM = 2-step MacAdam Ellipse, Duv +/- 0.002, Lumen Maintenance: L<sub>70</sub> > 50,000 hrs

#### LISTING

- ULus Listed to UL1598 & UL2108; cUL Listed to CSA C22.2 #250.0
- Suitable for dry and damp locations
- Made in the USA - meets the requirements of the Buy American provision within the ARRA
- NSF/ANSI-2 with lens (Non-Food and Splash Zones)
- 5 Year Limited warranty

#### ELECTRICAL

- 120-277VAC 50/60Hz input
- Power factor > 0.9
- Max ambient temperature 35°C
- Battery Backup not offered. Emergency Generator/Inverter/Controls-Override Device supplied by others.

#### FIXTURE HEIGHT

NU4RD OPTIC DPR

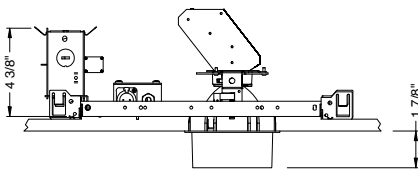

NU4RD OPTIC CQR

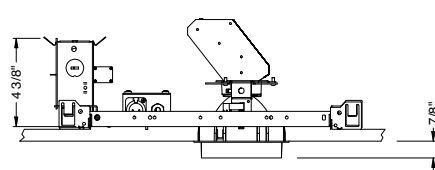

#### TRIMMED

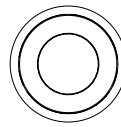

ceiling cutout  
4-3/8" diameter  
ceiling thickness  
1/8" to 1-5/8"

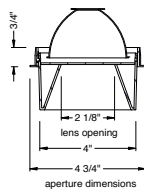

DPR

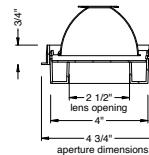

CQR

# alphabet

PROJECT INFORMATION		
JOB NAME		TYPE
ORDERING CODE		

## 20°- 40° BEAM ORDERING CODE

<b>SERIES</b>	<b>NU4</b>	NU4
<b>TYPE</b>	<b>RD</b>	round downlight
<b>LED</b>	<b>RGBW</b>	4 channel color module
<b>DELIVERED LUMENS</b>	<b>10LM</b>	800 lm
	Standard Configuration: 3000K 90CRI CQR-S20 Calculated Delivered Lumens = [Delivered Lumen Value] x [CCT Multiplier] x [Optic Multiplier]	
<b>CCT</b>	<b>27K</b>	RGBW with white at 2700K
	<b>30K</b>	RGBW with white at 3000K
	<b>35K</b>	RGBW with white at 3500K
	<b>43K</b>	RGBW with white at 4300K
	<b>65K</b>	RGBW with white at 6500K
<b>CRI</b>	<b>90</b>	90 CRI
<b>OPTIC &amp; LM MULTIPLIER</b>	<b>CQR-S20</b>	20° CIRQUE RING with clear lens
	<b>CQR-HE40</b>	40° CIRQUE RING with diffused lens
	<b>DPR-S20</b>	20° DROP RING with clear lens
	<b>DPR-HE40</b>	40° DROP RING with diffused lens
EXAMPLE: "CQR-S20" @ "10LM" = 1017 lm x (1.00) = 1017 lm		
<b>TRIM</b>	<b>WH</b>	white
	<b>MC</b>	matte chrome
	<b>BK</b>	black
	<b>BZ</b>	bronze
	<b>WT</b>	wheat
Not applicable to trimless option. Do not include in trimless ordering code.		

## 20°- 40° BEAM ORDERING CODE

<b>MOUNTING OPTIONS</b> SEE PAGE 4	<b>NC</b>	new construction with ceiling fitting plate
	<b>IC<sup>2</sup></b>	insulation contact housing
	<b>ICAT<sup>2</sup></b>	insulation contact/airtight housing
	<b>RET</b>	retrofit, no ceiling fitting plate
	<b>CP<sup>2</sup></b>	chicago plenum housing
<b>VOLTAGE</b>	<b>UNV</b>	120V-277V
<b>DIMMING</b>	<b>DMX-RJ45</b>	DMX control dimming to 0.1% with RJ45 connection
	<b>DMX-XLR</b>	DMX control dimming to 0.1% with XLR 5pin connection
	<b>DMX-WL</b>	DMX control dimming to 0.1% with wire lead connection
	<b>CAS</b>	Casambi Bluetooth control with flicker free 1% dimming

## ADDITIONAL MOUNTING INFO

New Construction Bar Hangers (included)	Mounting Length: 14-3/4" to 26"
Extension Kit p/n: K20266 (ordered separately, 1 per fixture)	Extends a pair of Bar Hangers Total Mounting Length: 29" to 48"

## YOUR COMPLETED ORDERING CODE

Follow the steps to specify your fixture, example:
<b>NU4-RD-RGBW-10LM-30K-90-CQR-S20-WH-NC-UNV-DMX-RJ45</b>

## NOTES

- NL option does not meet requirement for dead-front, airtight, wet and NSF. It is damp location rated.
- For servicing DMX cable, access above the ceiling is required.

# alphabet

PROJECT INFORMATION		
JOB NAME		TYPE
ORDERING CODE		

## PHOTOMETRIC DATA

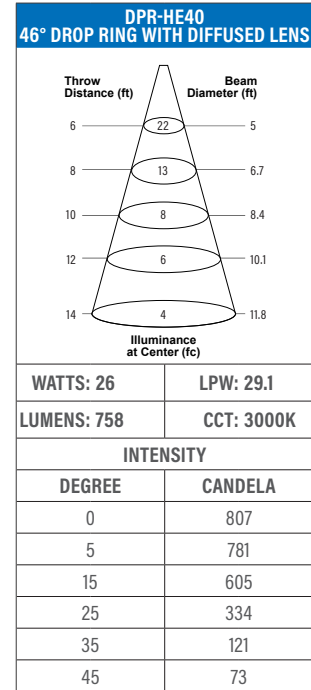
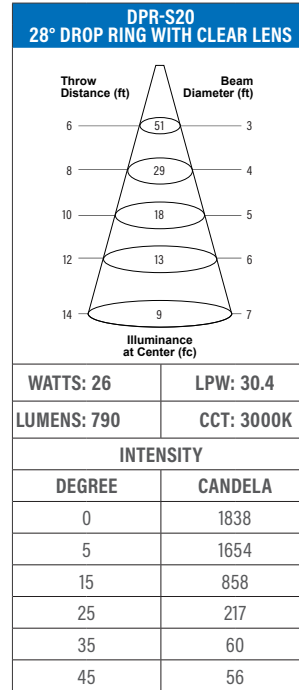
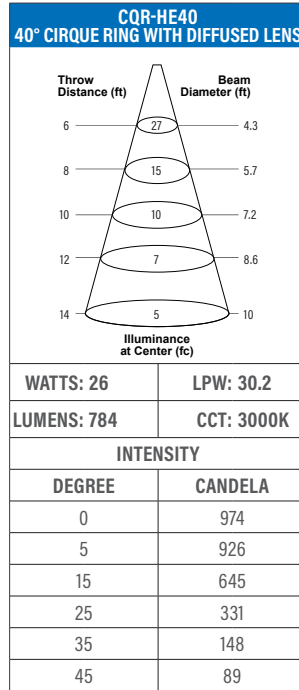
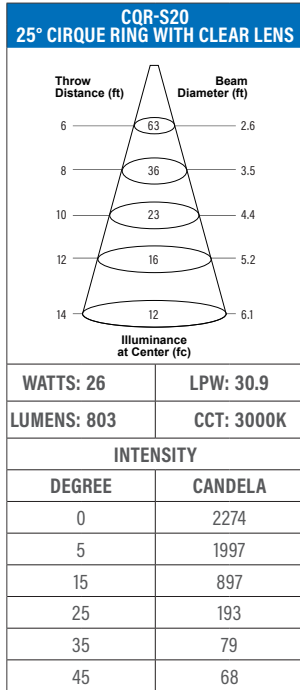

PROJECT INFORMATION		
JOB NAME		TYPE
ORDERING CODE		

## RGBW DATA

DOMINANT WAVELENGTH	
	MEASURED
R	623.9
G	524.2
B	461.9

### RGB SPECTRAL PLOT

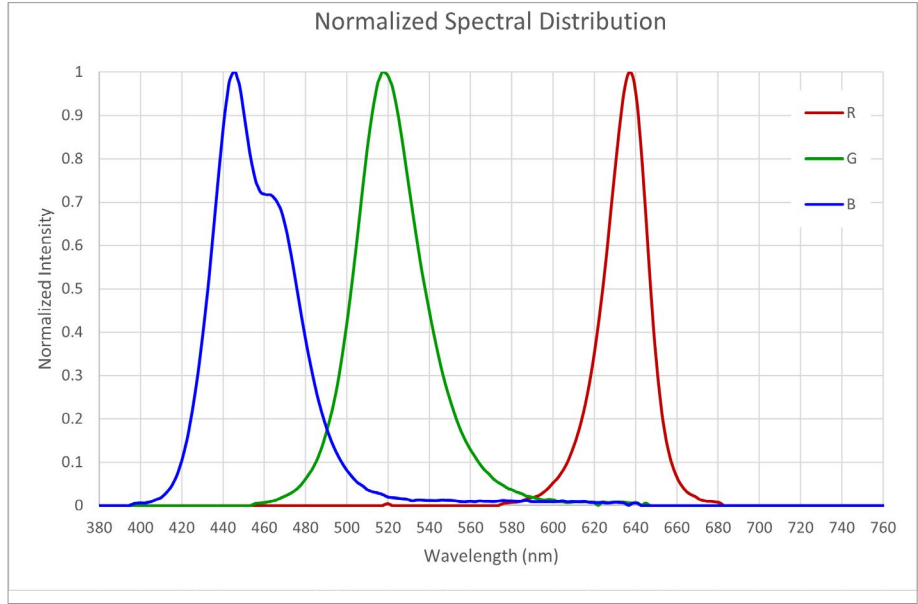

### COLOR GAMUT PLOT

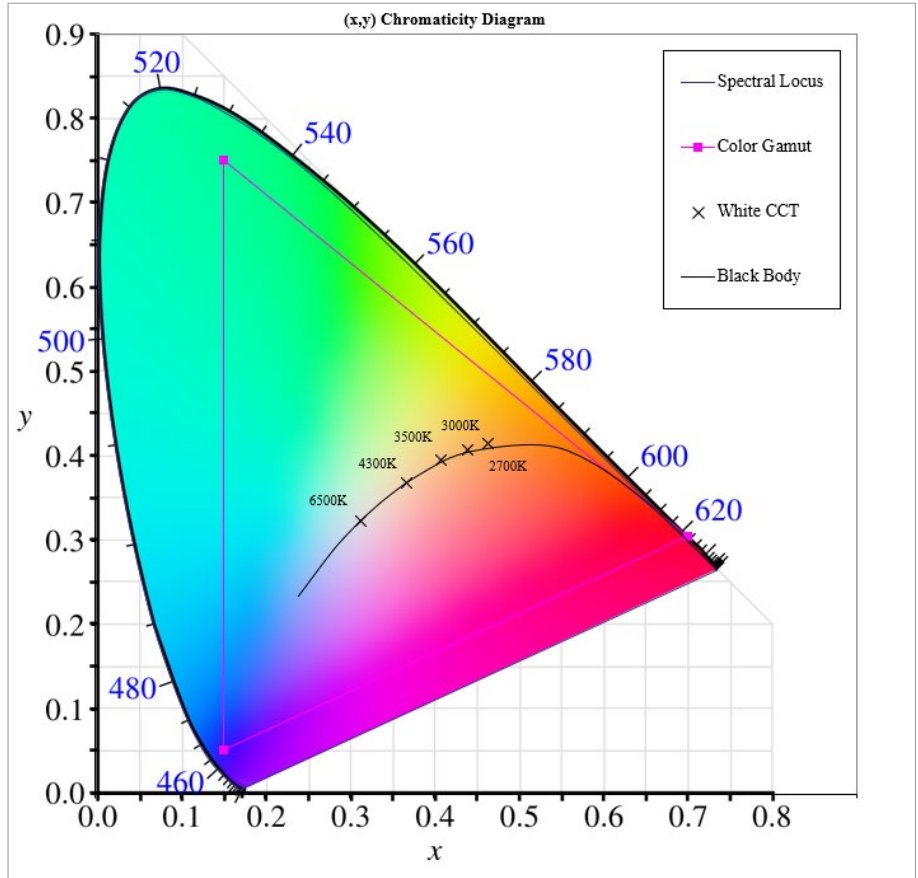

# alphabet

PROJECT INFORMATION		
JOB NAME		TYPE
ORDERING CODE		

## MOUNTING OPTIONS

### FIXTURE HEIGHT

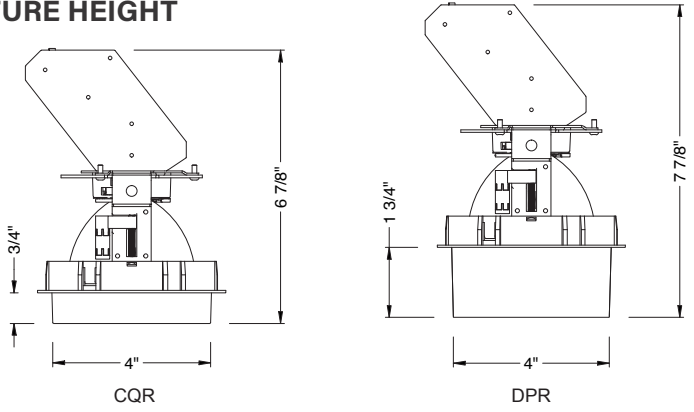

### NC - NEW CONSTRUCTION

#### TRIM

#### TRIMMED (STANDARD)

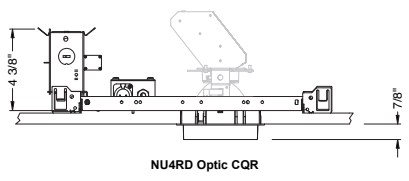

NU4RD Optic CQR

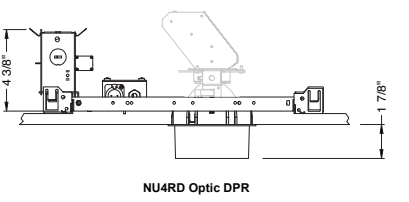

NU4RD Optic DPR

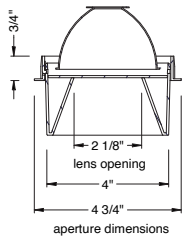
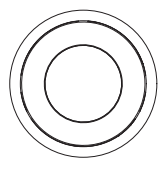
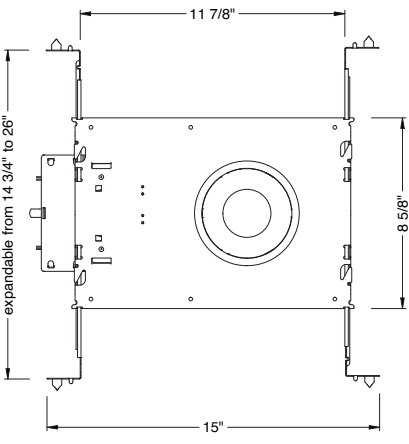

DPR

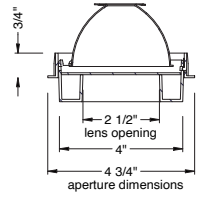

CQR

PROJECT INFORMATION		
JOB NAME		TYPE
ORDERING CODE		

## MOUNTING OPTIONS (CONTINUED)

### RET - RETRO TRIM/TRIMLESS

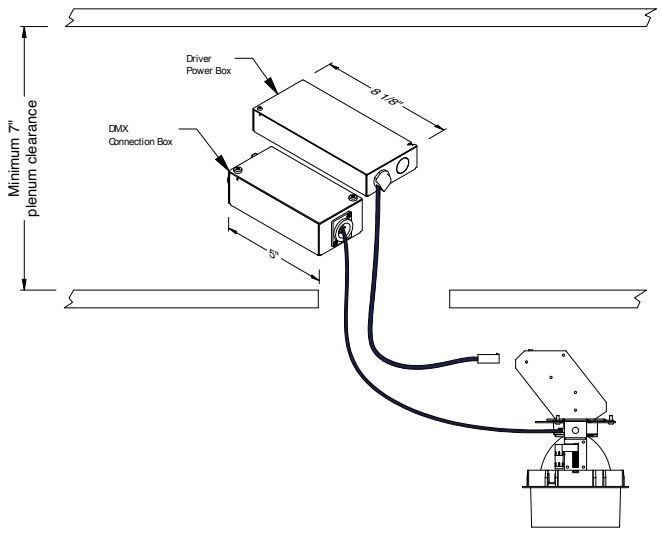

### IC - INSULATION CONTACT HOUSING ICAT - INSULATION CONTACT / AIR TIGHT CP - CHICAGO PLENUM

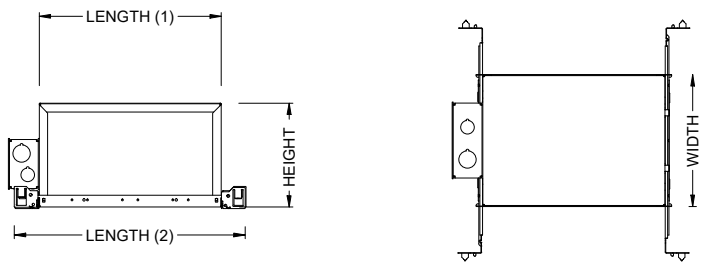

BOX SIZE	L 1	L 2	W	H
A	18 - 1/4"	14 - 7/8"	12 - 1/8"	6 - 3/4"

RATINGS / CERTIFICATIONS	NC	RET	IC	ICAT	CP
TYPE NON-IC	✓	✓			
TYPE IC			✓	✓	✓
CHICAGO PLENUM (CCEA)					✓
SUITABLE FOR AIR HANDLING PLENUMS	✓	✓	✓	✓	✓
REDUCED AIRFLOW (WITH LENS) ASTM E283	✓	✓	✓	✓	✓

BOX TYPE / LUMEN OUTPUT - STANDARD BEAMS (35° - 50°)			
LUMEN OUTPUT	BOX - A		
	CP	IC	ICAT
10LM	✓	✓	✓

CEILING THICKNESS	
FIXTURE TYPE	MOUNTING TYPE
	STANDARD CEILING THICKNESS
TRIM	1/8" to 1-5/8"
TRIMLESS	3/8" to 1-3/4"
MILLWORK (TRIMLESS)	1/2" to 1-3/4"