

PROJECT INFORMATION		
JOB NAME		TYPE
ORDERING CODE		

NU4

4" Square Adjustable Tamper Resistant Standard White

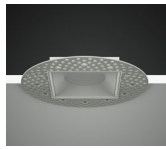
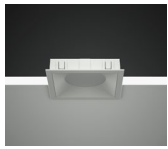
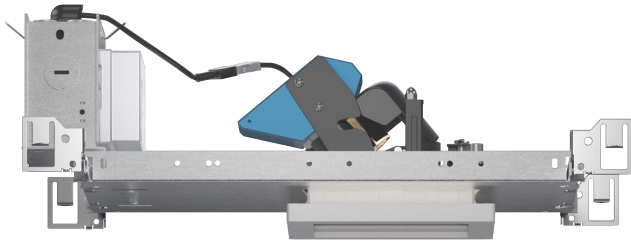

20° - 55° BEAM (Note: Specifications are subject to change without notice)		
9mm COB PERFORMANCE DATA		
LED LIGHT ENGINE	NOMINAL DELIVERED LUMENS	SYSTEM WATTAGE
10LM	880LM @30K/80CRI	9W
15LM	1280LM @30K/80CRI	13W
20LM	1670LM @30K/80CRI	17W
25LM	2020LM @30K/80CRI	22W
30LM	2410LM @30K/80CRI	27W
35LM	2840LM @30K/80CRI	34W
40LM	3180LM @30K/80CRI	40W
10LM	740LM @30K/90CRI	9W
15LM	1080LM @30K/90CRI	13W
20LM	1410LM @30K/90CRI	17W
25LM	1710LM @30K/90CRI	22W
30LM	2030LM @30K/90CRI	27W
35LM	2410LM @30K/90CRI	34W
40LM	2710LM @30K/90CRI	40W
Notes	Delivered lumens based on 35D optic with no lens, (see page 2)	

15° BEAM (Note: Specifications are subject to change without notice)		
6mm COB PERFORMANCE DATA		
LED LIGHT ENGINE	NOMINAL DELIVERED LUMENS	SYSTEM WATTAGE
10LM	870LM @30K/80CRI	11W
15LM	1220LM @30K/80CRI	19W
20LM	1550LM @30K/80CRI	31W
10LM	730LM @30K/90CRI	11W
15LM	1025LM @30K/90CRI	19W
20LM	1310LM @30K/90CRI	31W
Notes	Delivered lumens based on 15D optic with no lens, (see page 2)	

9.5° BEAM (Note: Specifications are subject to change without notice)		
4.5mm COB PERFORMANCE DATA		
LED LIGHT ENGINE	NOMINAL DELIVERED LUMENS	SYSTEM WATTAGE
10LM	705LM @30K/80CRI	17.5W
10LM	595LM @30K/90CRI	17.5W
Notes	Delivered lumens based on 9D optic with SBL lens, (see page 2)	



FEATURES

- Designed to meet NYS-OMH rigorous requirements
- Spun aluminum frame with stainless steel tamper resistant screws
- Polycarbonate (3mm) shatter proof lensing
- Optical beam control 9.5° to 55°
- UGR <5
- Antimicrobial (Microban®) painted finishes

DIMMING AND CONTROLS

- eldoLED flicker free 0-10V dimming to 0% and 1%
- eldoLED flicker free DALI dimming to 0% and 1%
- DMX dim to zero
- Lutron Hi-lumen 2-Wire (Eco System) dimming to 0.1% and 1%
- Leading & trailing edge (Triac/ELV) dimming to 1%
- Casambi bluetooth dimming to 1%
- NLight control interface dimming to 0%

CONSTRUCTION

- Aluminum 6061 lensing frame
- 18-8 stainless steel tamper resistant screws
- Shatter resistant Polycarbonate (PC) lensing
- Electrocoated 16-gauge cold rolled steel construction
- Accommodates ceiling thickness from 1/8" to 1-5/8"

LED

- 90 CRI: SDCM = 2-step MacAdam Ellipse, Lumen Maintenance: L₇₀ > 66,000 hrs
- 80 CRI: SDCM = 2-step MacAdam Ellipse, Lumen Maintenance: L₇₀ > 66,000 hrs

LISTING

- ULus Listed to UL1598 & UL2108; cUL Listed to CSA C22.2 #250.0
- IP65 with lens - Suitable for wet locations
- NSF/ANSI-2 with lens
- NYSOMH - New York State Office of Mental Health compliant
- 5 Year Limited warranty

ELECTRICAL

- 120V-277V, 120 only Triac / ELV
- Power factory ≥ 0.9
- 2kV driver input surge protection
- Remote emergency test switch
- 7W, 10W (T20 CEC) and 12W EM 90min battery
- Max. ambient installation temperature 95°F (35°C)

FIXTURE HEIGHT

LED LIGHT ENGINE: 10LM - 30LM

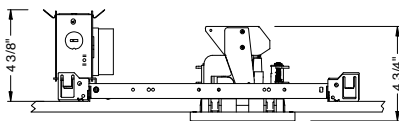

LED LIGHT ENGINE: 35LM - 40LM

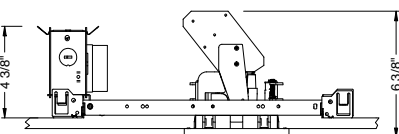

TAMPER RESISTANT

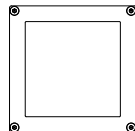

ceiling cutout
4-1/4" square
ceiling thickness
1/8" to 1-5/8"

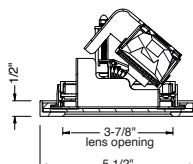

alphabet

PROJECT INFORMATION		
JOB NAME		TYPE
ORDERING CODE		

9°- 55° BEAM ORDERING CODE

SERIES	NU4	NU4								
TYPE	QATR	square adjustable tamper resistant								
LED	SW	standard white								
DELIVERED LUMENS	10LM	880 lm								
	15LM	1280 lm								
	20LM	1670 lm								
	25LM	2020 lm								
	30LM	2410 lm								
	35LM	2840 lm								
	40LM	3180 lm								
Standard Configuration: 3000K 80CRI 35D NL										
Calculated Delivered Lumens = [Delivered Lumen Value] x [CCT Multiplier] x [Reflector Multiplier]										
CCT	27K	2700K								
	30K	3000K								
	35K	3500K								
	40K	4000K								
			CCT MULTIPLIER FOR LUMEN OUTPUT	0.96	0.81	1.00	0.85	1.03	0.88	1.06
CRI	80	80 CRI								
	90	90 CRI								
OPTIC & LM MULTIPLIER SEE PAGE 3	9D	9.5 degrees								(0.80)
	15D	15 degrees								(1.05)
	20D	20 degrees								(0.93)
	25D	25 degrees								(0.96)
	35D	35 degrees								(1.00)
	55D	55 degrees								(0.97)
TIR OPTIC ACCESSORY SEE PAGE 3	NA	no accessory								(1.00)
	HETA	high efficiency textured lens, similar to Solite™								(0.90)
BEZEL LENS SEE PAGE 3	CL	clear lens								(0.98)
	DL	diffused lens								(0.91)
	HET	high efficiency textured lens, similar to Solite™								(0.92)
	SBL	smoothing beam lens								(0.92)
TRIM COLOR SEE PAGE 3	BK	black								
	WH	white								
	MC	matte chrome								
Antimicrobial finish, add AM to black, white or matte chrome i.e. BKAM.										
Includes shatter proof lens and tamper resistant screws.										
BEZEL COLOR SEE PAGE 3	BK	black								(0.98)
	WH	white								(1.00)
	MC	matte chrome								(0.99)
Antimicrobial finish, add AM to black, white or matte chrome i.e. BKAM.										

9°- 55° BEAM ORDERING CODE

MOUNTING OPTIONS SEE PAGE 6	NC	new construction with ceiling fitting plate
	RET	retrofit, no ceiling fitting plate
VOLTAGE	120	120V
	UNV	120V-277V
DIMMING	DIM10	eldoLED flicker free 0-10V dimming to 1%
	DIM10Z	eldoLED flicker free 0-10V dimming to 0%
	DALI	eldoLED flicker free DALI 2 dimming to 1%
	DALIZ	eldoLED flicker free DALI 2 dimming to 0%
	DMXZ	DMX dim to zero
	LUT	Lutron Hi-lume Ecosystem dimming to 1%, Soft-on & Fade-to-Black
	LUTP ¹	Lutron Hi-lume Premier Ecosystem dimming to 0.1%, Soft-on & Fade-to-Black
	ELV1 ²	leading & trailing edge (Triac/ELV) dimming to 1%
	NLT	nLight control interface: standard Cat-5/RJ45 connection (female), dim to off
	CAS	Casambi Bluetooth control with flicker free 1% dimming
ELECTRICAL OPTIONS	EM7	emergency battery backup, 90 minutes at 7W to LED
	EM12	emergency battery backup, 90 minutes at 12W to LED
	EM10CA20	remote emergency battery backup, 90 minutes at 10W to LED, CA title 20

ADDITIONAL MOUNTING INFO

New Construction Bar Hangers (included)	Mounting Length: 14-3/4" to 26"
Extension Kit p/n: K20266 (ordered separately, 1 per fixture)	Extends a pair of Bar Hangers Total Mounting Length: 29" to 48"

YOUR COMPLETED ORDERING CODE

Follow the steps to specify your fixture, example:
NU4 - QALP - SW - 20LM - 35K - 90 - 35D - NA - HET - WH - WH - NC - UNV - DIM10 - EM7 - TC

NOTES

- LUTP not available in 25LM/30LM/40LM.
- ELV1 (120V) not available in 10LM.

* EldoLED driver uses logarithmic dimming curve as standard. For linear dimming curve add "LIN" after dimming code, i.e. DIM10LIN.

alphabet

PROJECT INFORMATION		
JOB NAME		TYPE
ORDERING CODE		

TRIM OPTIONS

TRIM COLORS

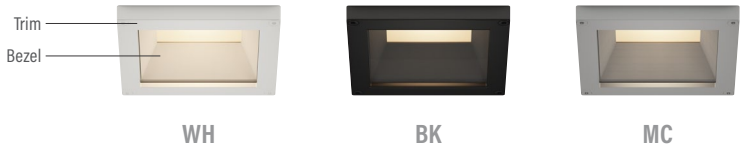

OPTICAL OPTIONS

- UGR calculation based on CIE 117-1995; room size: 4H X 8H, reflectance: 70/50/20;
- UGR calculation based on 15LM fixtures, unless otherwise noted.



OPTIC	BEAM ANGLE	UGR
15D	13.7	≤5
20D	20.1	≤5
25D	25.5	≤5
35D	34.4	7.5
55D	52.9	14



OPTIC	BEAM ANGLE	UGR
20D	38.3	15.7
25D	41.5	17.2
35D	45	18.2
55D	57.8	20.9



OPTIC	BEAM ANGLE	UGR
20D	24.9	≤5
25D	28.7	8.8
35D	34	9.9
55D	51.6	15.7



OPTIC	BEAM ANGLE	UGR
9D*	9.5	8.2
15D	17	≤5
20D	21	≤5
25D	26.5	6.3
35D	33.3	8.1
55D	52.8	14.8

* UGR Calculation based on 10LM for 9D.

GLARE CONTROL

CUT-OFF ANGLE

Visual comfort is achieved with a lower cut-off angle due to improved glare control. The smaller the cut-off angle, the easier it is on the eye.

Alphabet downlights have been thoughtfully engineered to eliminate glare while still delivering functional illumination.

- Cutoff angle of NL and CL is 45.5 degrees;

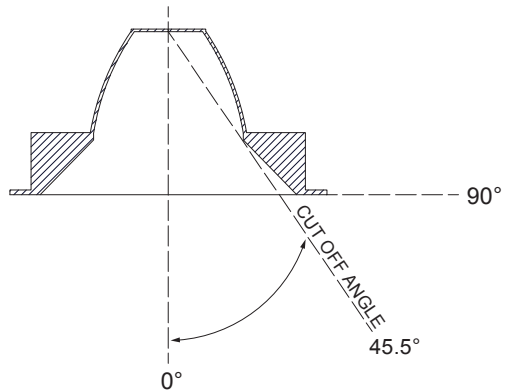

alphabet

PROJECT INFORMATION		
JOB NAME		TYPE
ORDERING CODE		

PHOTOMETRIC DATA

20LM CCT MULTIPLIERS		
	80CRI	90CRI
2700K	0.96	0.81
3000K	1	0.85
3500K	1.03	0.88
4000K	1.06	0.91
FC Formula = CBCP / Distance ²		

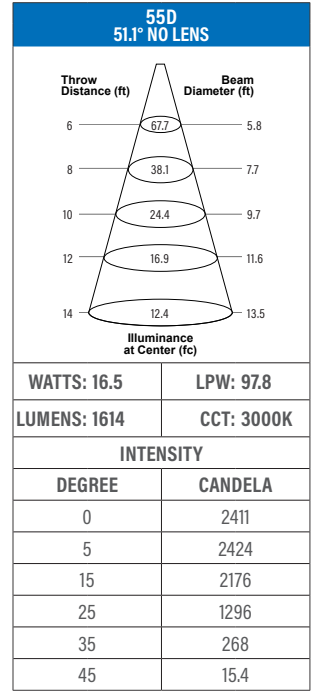
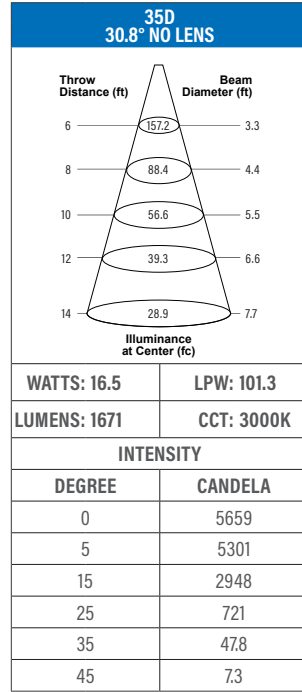
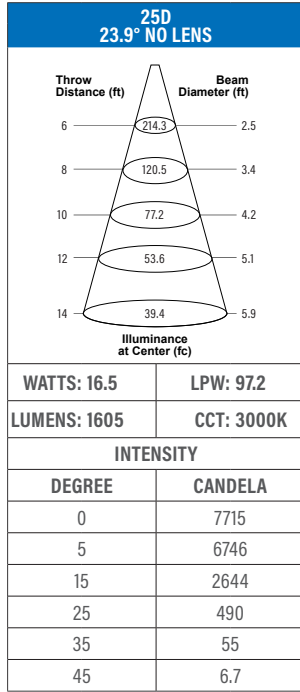
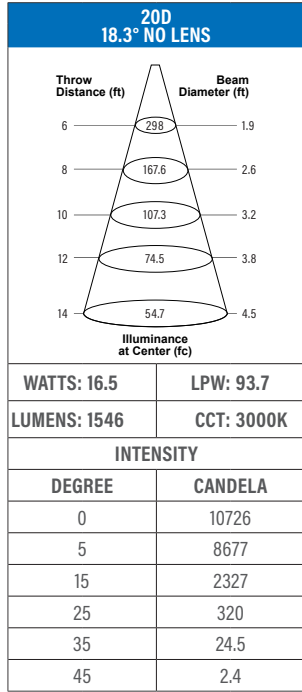

40LM CCT MULTIPLIERS		
	80CRI	90CRI
2700K	0.96	0.81
3000K	1	0.85
3500K	1.03	0.88
4000K	1.06	0.91
FC Formula = CBCP / Distance ²		

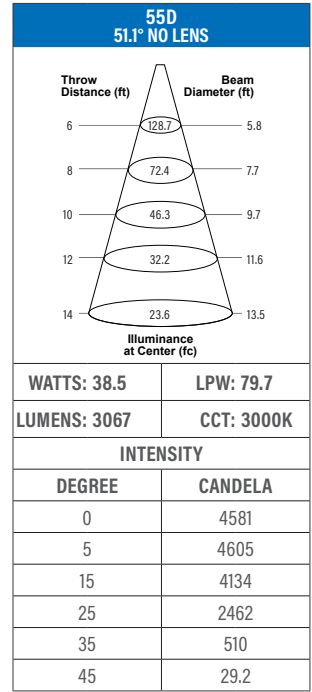
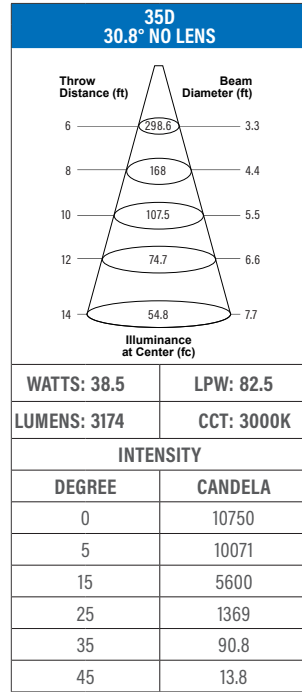
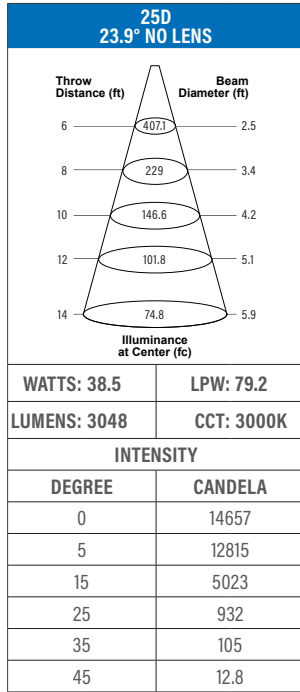
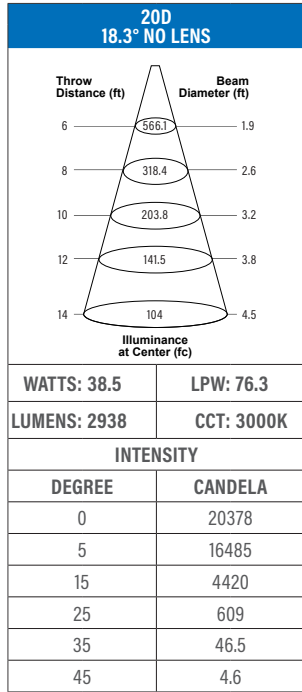

alphabet

PROJECT INFORMATION		
JOB NAME		TYPE
ORDERING CODE		

PHOTOMETRIC DATA

10LM CCT MULTIPLIERS		
	80CRI	90CRI
2700K	0.96	0.81
3000K	1	0.85
3500K	1.03	0.88
4000K	1.06	0.91
FC Formula = CBCP / Distance ²		

**15D
13.5° NO LENS**

Throw Distance (ft)	Beam Diameter (ft)
6	299
8	168
10	108
12	75
14	55

Illuminance at Center (fc)

WATTS: 11.5	LPW: 75.4
LUMENS: 868	CCT: 3000K
INTENSITY	
DEGREE	CANDELA
0	10779
5	7316
15	942
25	53.6
35	6.2
45	0.7

**9D
9.5° SMOOTHING BEAM LENS**

Throw Distance (ft)	Beam Diameter (ft)
6	389
8	219
10	140
12	97
14	71

Illuminance at Center (fc)

WATTS: 17.1	LPW: 40.4
LUMENS: 692	CCT: 3000K
INTENSITY	
DEGREE	CANDELA
0	14002
5	6549
15	392
25	146
35	53.2
45	15.8

20LM CCT MULTIPLIERS		
	80CRI	90CRI
2700K	0.96	0.81
3000K	1	0.85
3500K	1.03	0.88
4000K	1.06	0.91
FC Formula = CBCP / Distance ²		

**15D
13.5° NO LENS**

Throw Distance (ft)	Beam Diameter (ft)
6	535
8	301
10	192
12	134
14	98.2

Illuminance at Center (fc)

WATTS: 30.5	LPW: 50.8
LUMENS: 1549	CCT: 3000K
INTENSITY	
DEGREE	CANDELA
0	19249
5	13063
15	1682
25	95.6
35	11
45	1.3

PROJECT INFORMATION		
JOB NAME	TYPE	
ORDERING CODE		

MOUNTING OPTIONS

FIXTURE HEIGHT

10LM-30LM CONFIGURATIONS

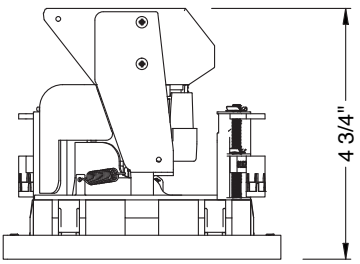

35LM-40LM CONFIGURATIONS

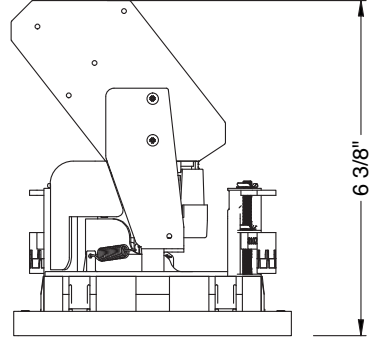

NC - NEW CONSTRUCTION

LED LIGHT ENGINE 10LM-30LM

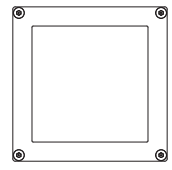
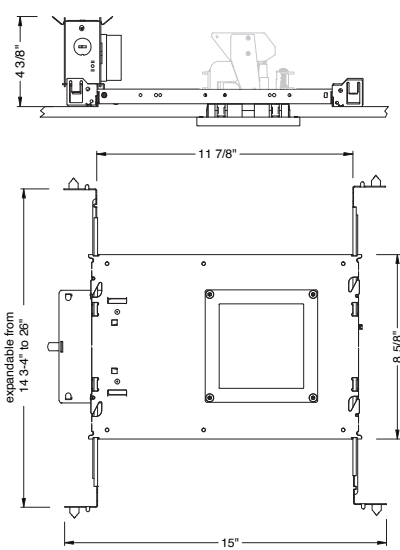

ceiling cutout
4-1/4" square
ceiling thickness
1/8" to 1-5/8"

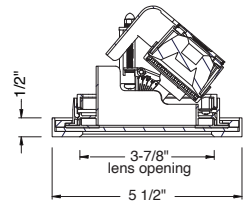

LED LIGHT ENGINE 35LM-40LM

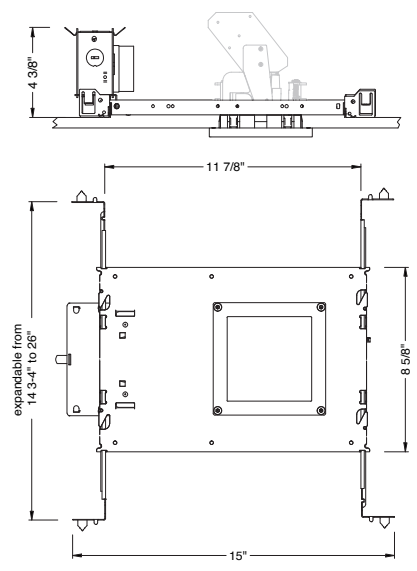

PROJECT INFORMATION		
JOB NAME		TYPE
ORDERING CODE		

MOUNTING OPTIONS (CONTINUED)

RET - RETRO TRIM/TRIMLESS

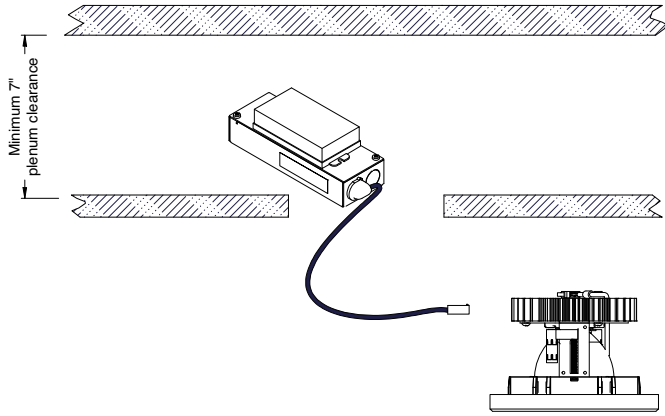

RATINGS / CERTIFICATIONS	NC	RET
TYPE NON-IC	✓	✓
TYPE IC		
CHICAGO PLENUM (CECA)		
SUITABLE FOR AIR HANDLING PLENUMS	✓	✓
REDUCED AIRFLOW (WITH LENS) ASTM E283	✓	✓

CEILING THICKNESS	
FIXTURE TYPE	MOUNTING TYPE
	STANDARD CEILING THICKNESS
TRIM	0.3" to 1.0"

PROJECT INFORMATION		
JOB NAME		TYPE
ORDERING CODE		

BATTERY OPTIONS

EMERGENCY BATTERY

IOTA's ILB Battery Backups are UL Listed LED emergency drivers that allow the same LED fixture to be used for both normal and emergency operation. In the event of a power failure, the ILB switches to the emergency mode and operates the existing fixture for 90 minutes. The unit contains a battery, charger, and converter circuit in a single can. The Constant Power design of the ILB maintains the output wattage to the LED array even as the system voltage diminishes. UL 924 Listed for U.S. and Canada. UL 1310 Certified, Output Class 2 Compliant. Includes single-piece TBTS test switch and charge indicator accessory kit. For use with switched and unswitched fixtures, and includes Two-wire universal AC input. Meets or exceeds all National Electric Code and Life Safety Code Emergency Lighting Requirements. Rated for use in Plenum, Damp Location, Recessed Type IC, and Enclosed and Gasketed Luminaires.

REMOTE TEST SWITCH

The Remote Test Switch may be mounted adjacent to the LED Fixture by others.

EMERGENCY BATTERY ACCESS

Above ceiling access is required for service. An access panel in the ceiling (or other form of access) adjacent to the installation location of the Emergency Battery is required.

REMOTE LOCATION

Maximum remote mounting distance of the emergency driver shall be 50 feet. Remote location wiring provided by others. Follow all Local and National Electric/ Building Codes.

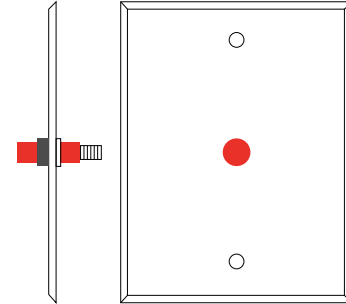

Remote Test Switch

EM MODE OUTPUT (DELIVERED LUMENS)		
LUMEN ORDERING CODE	EM10	EM12
ALL OPTIONS (10LM TO 40LM)	880LM	1055LM
Notes: Based on 30K, 80CRI		

NC - NEW CONSTRUCTION WITH EM BATTERY (REMOTE TEST SWITCH)

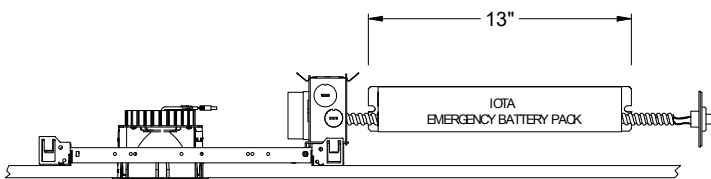

Accessory

76066 Optional T-Grid Mounting Kit†

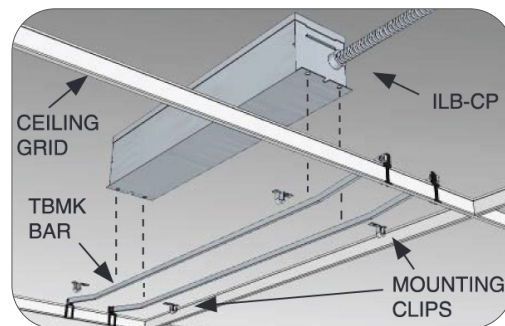

1. Can be used with any of the Emergency Battery Backups. Must be ordered as a separate line item.