

PROJECT INFORMATION			
JOB NAME		TYPE	
ORDERING CODE			

NU3

3" Round Wall Wash Hospitality CCTs



WW BEAM		
(Note: Specifications are subject to change without notice)		
9mm COB PERFORMANCE DATA		
LED LIGHT ENGINE	NOMINAL DELIVERED LUMENS	SYSTEM WATTAGE
10LM	880LM @24K/90CRI	13W
15LM	1520LM @24K/90CRI	23W
20LM	2060LM @24K/90CRI	35W
Notes	Delivered lumens based on 20D optic with no lens, (see page 2)	

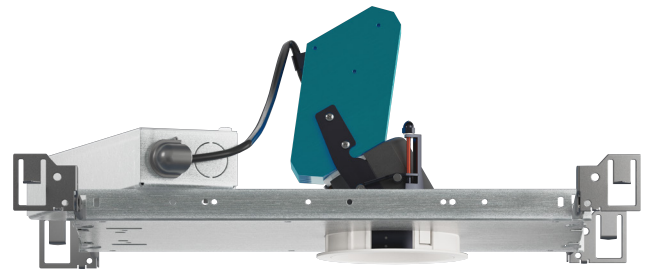

Trim

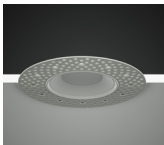

Trimless



Trimless Millwork

FEATURES

- An asymmetric reflector with highly efficient BrightView angle bending lens produces excellent wall washing with no scalloping
- 4' set back with 6' on center spacing - 15 FC average
- 3/4" bezel regress with 1/16" micro flange
- Custom finishes available
- Microban® antimicrobial finish available on all exposed painted surfaces

DIMMING AND CONTROLS

- eldoLED flicker free 0-10V dimming to 0% and 1%
- eldoLED flicker free DALI dimming to 0% and 1%
- Lutron Hi-lume 0.1% Ecosystem
- Lutron athena wireless node
- Leading & trailing edge (Triac/ELV) dimming to 1%
- Casambi dimming to 1%
- NLight control interface dimming to 0%

CONSTRUCTION

- Lexan™ (PC) highly resistant to impact and heat (240°F)
- Optimal material for wireless signal connectivity
- Shatter proof acrylic bezel lens
- Electrocoated 16-gauge cold-rolled steel construction
- Accommodates ceiling thickness from 1/8" to 5/8"

LED

- 90 CRI: SDCM = 2-step MacAdam Ellipse, Lumen Maintenance: L₇₀ > 66,000 hrs

LISTING

- ULus Listed to UL1598 & UL2108; cUL Listed to CSA C22.2 #250.0
- IP65 with lens - Suitable for wet locations with lens - Suitable for damp locations without lens
- Non-conductive, dead-front construction (Shower Approved)
- NSF/ANSI-2 with lens (Non-Food and Splash Zones)
- **Declare.** - LBC Red List Approved
- 5 Year Limited warranty

ELECTRICAL

- 120V-277V, 120 only Triac / ELV
- Power factor ≥ 0.9
- 2kV driver input surge protection
- Remote emergency test switch
- 7W, 10W (T20 CEC) and 12W EM 90min battery
- Max. ambient installation temperature 95°F (35°C)

FIXTURE HEIGHT

10LM-15LM LOW LUMENS

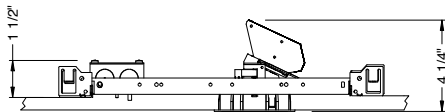

20LM HIGH LUMENS

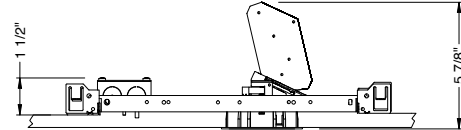

TRIMMED

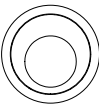

ceiling cutout
3-3/8" diameter
ceiling thickness
1/8" to 5/8"

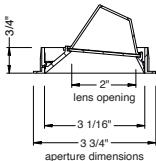

TRIMLESS

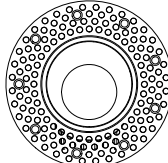

ceiling cutout
3-1/2" diameter
ceiling thickness
3/8" to 5/8"

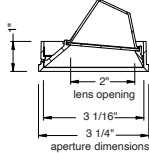

MILLWORK

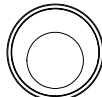

ceiling cutout
3-1/2" diameter
ceiling thickness
1/2" to 5/8"

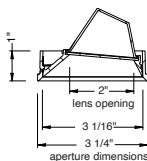

alphabet

15°- 55° BEAM ORDERING CODE					
SERIES	NU3	NU3			
TYPE	RW	round wall wash			
	RWT	round wall wash trimless			
	RWTMW	round wall wash trimless millwork			
LED	SW	standard white			
DELIVERED LUMENS	10LM	880 lm			
	15LM	1520 lm			
	20LM	2060 lm			
	Standard Configuration: 2400K 90CRI NL Calculated Delivered Lumens = [Delivered Lumen Value] x [CCT Multiplier] x [Optic Multiplier] x [Lens Multiplier]				
CCT	22K	2200K 2400K	CCT	2200K	
	24K		CRI	90+	90+
	CCT MULTIPLIER FOR LUMEN OUTPUT		0.94	1	
CRI	90	90 CRI			
OPTIC & LM MULTIPLIER SEE PAGE 3	WW	wall wash with diffused angle bending lens			
TRIM COLOR SEE PAGE 3	BK	black			
	WH	white			
	MC	matte chrome			
	BZ	bronze			
	WT	wheat			
	CC¹	custom color, consult factory for details			
Antimicrobial finish, add AM to black, white or matte chrome i.e. BKAM.					
Not applicable to trimless option. Do not include in trimless ordering code.					
BEZEL COLOR SEE PAGE 3	BK	black	(0.98)		
	WH	white	(1.00)		
	BZ	bronze	(0.99)		
	MC	matte chrome	(0.98)		
	WT	wheat	(0.99)		
	CC¹	custom color, consult factory for details			
Antimicrobial finish, add AM to black, white or matte chrome i.e. BKAM.					

PROJECT INFORMATION			
JOB NAME		TYPE	
ORDERING CODE			

15°- 55° BEAM ORDERING CODE		
MOUNTING OPTIONS SEE PAGE 5, 6	NC	new construction with ceiling fitting plate
	IC²	insulation contact housing
	ICAT²	insulation contact/airtight housing
	CP²	chicago plenum housing
	RET	retrofit, no ceiling fitting plate
VOLTAGE	I20	120V
	UNV	120V-277V
DIMMING	DIM10	eldoLED flicker free 0-10V dimming to 1%
	DIM10Z	eldoLED flicker free 0-10V dimming to 0%
	DALI	eldoLED flicker free DALI-2 dimming to 1%
	DALIZ	eldoLED flicker free DALI-2 dimming to 0%
	ELV1	leading & trailing edge (Triac/ELV) dimming to 1%
	LUTP	Lutron Hi-lume Premier Ecosystem dimming to 0.1%, Soft-on & Fade-to-Black
	NLT²	nLight control interface: standard Cat-5/RJ45 connection (female), dim to off
	CAS	Casambi control with flicker free 1% dimming
	AWN³	lutron athena wireless node
ELECTRICAL OPTIONS	EM7	emergency battery backup, 90 minutes at 7W to LED
	EM12	emergency battery backup, 90 minutes at 12W to LED
	EM10CA20	remote emergency battery backup, 90 minutes at 10W to LED, CA title 20

ADDITIONAL MOUNTING INFO	
New Construction Bar Hangers (included)	Mounting Length: 14-3/4" to 26"
Extension Kit p/n: K20266 (ordered separately, 1 per fixture)	Extends a pair of Bar Hangers Total Mounting Length: 29" to 48"

YOUR COMPLETED ORDERING CODE
Follow the steps to specify your fixture, example:
NU3 - RA - SW - 20LM - 24K - 90 - 20D - NA - NL - WH - WH - NC - UNV - DIM10 - EM7

NOTES

- Custom set up fee plus minimum quantity required per color.
- For servicing access above ceiling is required.
- AWN reference page 9 for product specifications on Athena wireless node.

*EldoLED uses logarithmic dimming curve as standard.
For linear dimming curve, add "LIN" after dimming code, i.e. DIM10LIN.

alphabet

PROJECT INFORMATION			
JOB NAME		TYPE	
ORDERING CODE			

TRIM OPTIONS

TRIM/BEZEL COLORS



PHOTOMETRIC DATA DIAGRAM

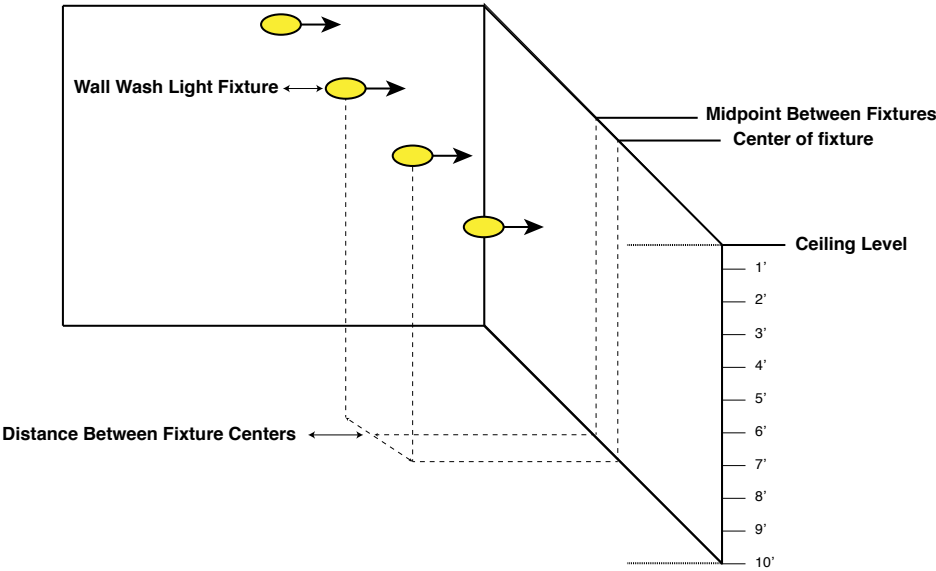

PHOTOMETRIC DATA CHARTS

FOOT CANDLE MEASUREMENT

STANDARD WHITE WALL WASH 20LM 90CRI 2400K																		
Mounting Distance	2' from wall						3' from wall						4' from wall					
Fixture Spacing	2' on center		3' on center		4' on center		2' on center		3' on center		4' on center		3' on center		4' on center		6' on center	
Distance from Ceiling	Center	Mid Point	Center	Mid Point	Center	Mid Point	Center	Mid Point	Center	Mid Point	Center	Mid Point	Center	Mid Point	Center	Mid Point	Center	Mid Point
1'	20	19.8	14.8	12.3	13.2	7.4	6.9	7.1	5	4.8	4.1	3.4	2.2	2.2	1.8	1.6	1.4	0.9
2'	72.6	76.7	48.9	52.6	40.2	35	20.2	20.8	14.4	15	11.3	11	6.3	6.5	5	5	3.7	3.1
3'	85.5	88.4	61.3	61.6	46.3	46.3	44.6	46.3	32.3	34.1	24.3	26.3	13.8	14.1	10.7	11.1	7.6	7.2
4'	69.4	72.2	52.3	52.8	40.4	39.8	50.4	52.4	39	39.5	30.2	30.8	23.2	23.9	18.1	19.2	12.2	13.2
5'	50.9	52.7	39.8	40.9	31.5	31.4	45.5	46.6	36	37.7	29.3	29.5	26.5	27.3	21.7	22	14.7	15.5
6'	36.5	37.6	29.6	30.4	23.8	24.2	37.6	38.4	30.8	32.1	25.3	26.1	25.7	26.7	21.4	22.1	15.3	15.4
7'	26.3	27	21.9	22.5	18	18.5	30	30.5	25.2	26.1	21.1	21.9	23.3	23.9	19.6	20.5	14.6	14.5
8'	19.2	19.6	16.4	16.8	13.8	14.2	23.6	23.9	20.2	20.9	17.3	17.9	20.2	20.6	17.3	18.1	13.1	13.2
9'	14.3	14.6	12.5	12.8	10.7	11	18.5	18.8	16.2	16.7	14.1	14.5	17.2	17.5	14.9	15.5	11.5	11.7
10'	10.8	11	9.6	9.8	8.4	8.6	14.6	14.8	13	13.4	11.5	11.8	14.4	14.7	12.7	13.2	9.9	10.2

NOTE

1. Performance based on typical reflectance values and room dimensions. IES files available at [ledrabrands.com](#)

PROJECT INFORMATION			
JOB NAME		TYPE	
ORDERING CODE			

PHOTOMETRIC DATA CHARTS

FOOT CANDLE MEASUREMENT

STANDARD WHITE WALL WASH 15LM 90CRI 2400K																		
Mounting Distance	2' from wall						3' from wall						4' from wall					
Fixture Spacing	2' on center		3' on center		4' on center		2' on center		3' on center		4' on center		3' on center		4' on center		6' on center	
Distance from Ceiling	Center	Mid Point	Center	Mid Point	Center	Mid Point	Center	Mid Point	Center	Mid Point	Center	Mid Point	Center	Mid Point	Center	Mid Point	Center	Mid Point
1'	14.7	14.6	10.9	9.1	9.7	5.4	5.1	5.2	3.7	3.6	3	2.5	1.6	1.6	1.3	1.2	1.1	0.7
2'	53.6	56.6	36.1	38.8	29.7	25.8	14.9	15.4	10.7	11.1	8.4	8.1	4.7	4.8	3.7	3.7	2.7	2.3
3'	63.1	65.2	45.2	45.5	34.2	34.2	32.9	34.2	23.8	25.1	17.9	19.4	10.2	10.4	7.9	8.2	5.6	5.3
4'	51.2	53.3	38.6	39	29.8	29.3	37.2	38.7	28.8	29.1	22.2	22.8	17.1	17.6	13.4	14.1	9	9.7
5'	37.6	38.9	29.3	30.2	23.3	23.2	33.6	34.4	26.6	27.8	21.6	21.8	19.6	20.1	16	16.2	10.9	11.4
6'	26.9	27.8	21.8	22.4	17.6	17.9	27.8	28.3	22.7	23.7	18.7	19.3	19	19.7	15.8	16.3	11.3	11.4
7'	19.4	19.9	16.2	16.6	13.3	13.7	22.1	22.5	18.6	19.3	15.6	16.2	17.2	17.6	14.5	15.1	10.8	10.7
8'	14.2	14.5	12.1	12.4	10.2	10.5	17.4	17.7	14.9	15.5	12.8	13.2	14.9	15.2	12.8	13.3	9.6	9.7
9'	10.5	10.7	9.2	9.4	7.9	8.1	13.7	13.9	12	12.3	10.4	10.7	12.7	12.9	11	11.4	8.5	8.7
10'	8	8.1	7.1	7.3	6.2	6.4	10.8	10.9	9.6	9.9	8.5	8.7	10.6	10.8	9.4	9.7	7.3	7.5

STANDARD WHITE WALL WASH 10LM 90CRI 2400K																		
Mounting Distance	2' from wall						3' from wall						4' from wall					
Fixture Spacing	2' on center		3' on center		4' on center		2' on center		3' on center		4' on center		3' on center		4' on center		6' on center	
Distance from Ceiling	Center	Mid Point	Center	Mid Point	Center	Mid Point	Center	Mid Point	Center	Mid Point	Center	Mid Point	Center	Mid Point	Center	Mid Point	Center	Mid Point
1'	8.5	8.5	6.3	5.3	5.6	3.1	2.9	3	2.1	2.1	1.7	1.4	0.9	0.9	0.8	0.7	0.6	0.4
2'	31	32.8	20.9	22.5	17.2	15	8.6	8.9	6.2	6.4	4.8	4.7	2.7	2.8	2.1	2.1	1.6	1.3
3'	36.6	37.8	26.2	26.3	19.8	19.8	19.1	19.8	13.8	14.6	10.4	11.2	5.9	6	4.6	4.8	3.3	3.1
4'	29.6	30.9	22.4	22.6	17.3	17	21.5	22.4	16.7	16.9	12.9	13.2	9.9	10.2	7.8	8.2	5.2	5.6
5'	21.8	22.5	17	17.5	13.5	13.4	19.5	19.9	15.4	16.1	12.5	12.6	11.3	11.7	9.3	9.4	6.3	6.6
6'	15.6	16.1	12.6	13	10.2	10.4	16.1	16.4	13.2	13.7	10.8	11.2	11	11.4	9.1	9.4	6.5	6.6
7'	11.2	11.5	9.4	9.6	7.7	7.9	12.8	13	10.8	11.2	9	9.4	10	10.2	8.4	8.8	6.2	6.2
8'	8.2	8.4	7	7.2	5.9	6.1	10.1	10.2	8.7	9	7.4	7.6	8.6	8.8	7.4	7.7	5.6	5.6
9'	6.1	6.2	5.3	5.5	4.6	4.7	7.9	8	6.9	7.2	6	6.2	7.3	7.5	6.4	6.6	4.9	5
10'	4.6	4.7	4.1	4.2	3.6	3.7	6.2	6.3	5.6	5.7	4.9	5	6.2	6.3	5.4	5.6	4.2	4.4

NOTE

1. Performance based on typical reflectance values and room dimensions. IES files available at ledrabrands.com

PROJECT INFORMATION		
JOB NAME		TYPE
ORDERING CODE		

MOUNTING OPTIONS

FIXTURE HEIGHT

10LM - 15LM LOW LUMENS

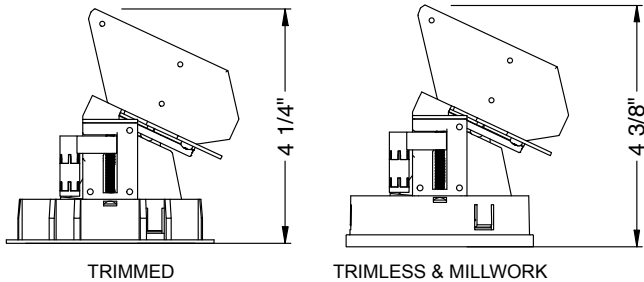

20LM HIGH LUMENS

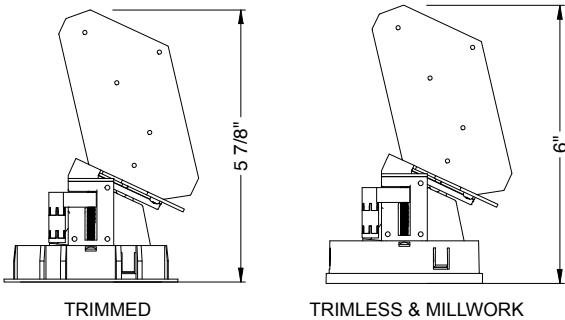

NC - NEW CONSTRUCTION

TRIM

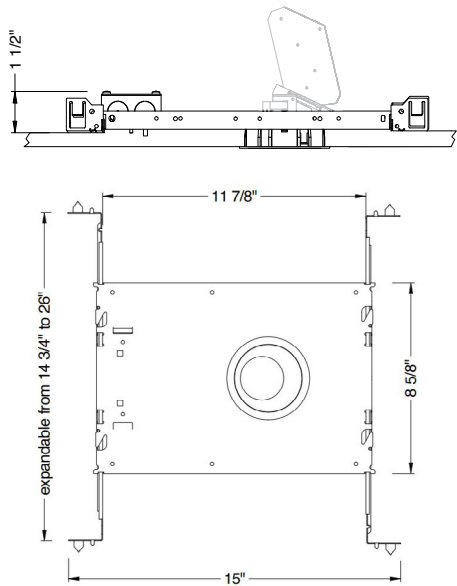

TRIM

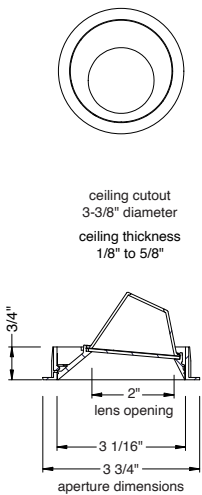

TRIMLESS

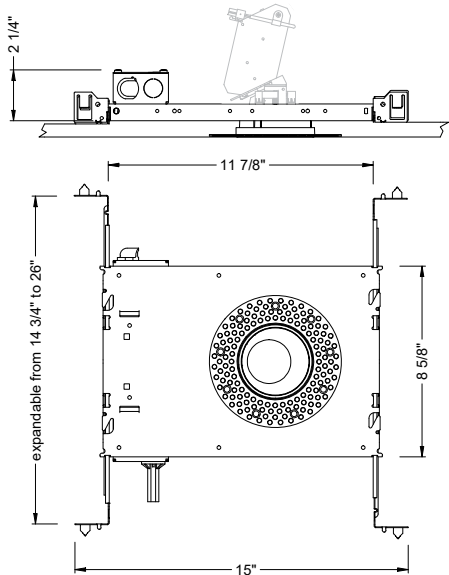

TRIMLESS

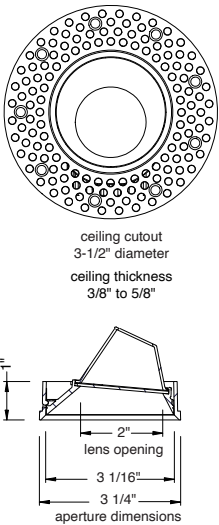

TRIMLESS/MILLWORK

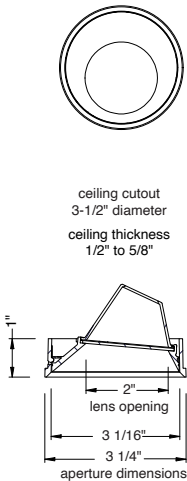

PROJECT INFORMATION			
JOB NAME		TYPE	
ORDERING CODE			

MOUNTING OPTIONS (CONTINUED)

RET - RETRO TRIM/TRIMLESS

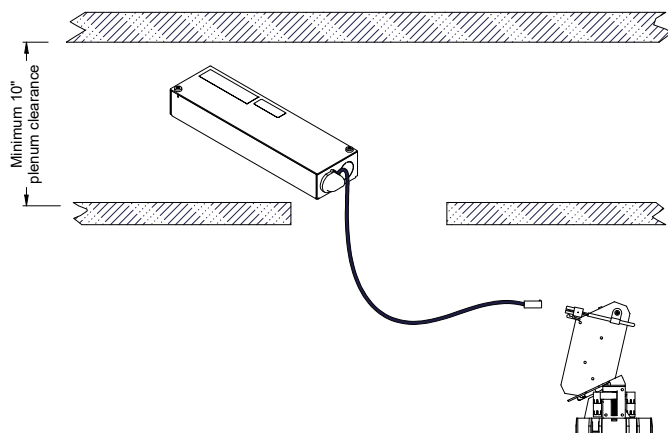

RATINGS / CERTIFICATIONS	NC	RET	IC	ICAT	CP
TYPE NON-IC	✓	✓			
TYPE IC			✓	✓	✓
CHICAGO PLENUM (CCEA)					✓
SUITABLE FOR AIR HANDLING PLENUMS	✓	✓	✓	✓	✓
REDUCED AIRFLOW (WITH LENS) ASTM E283	✓	✓	✓	✓	✓

CEILING THICKNESS	
FIXTURE TYPE	MOUNTING TYPE
	NC, IC, ICAT, CP, RET
	STANDARD CEILING THICKNESS
TRIM	1/8" to 5/8"
TRIMLESS	3/8" to 5/8"
MILLWORK (TRIMLESS)	1/2" to 5/8"

IC - INSULATION CONTACT HOUSING

ICAT - INSULATION CONTACT / AIR TIGHT

CP - CHICAGO PLENUM

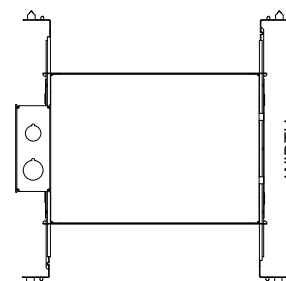
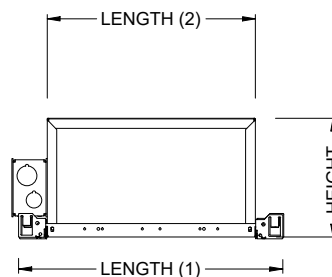

BOX SIZE	L 1	L 2	W	H
A	15 - 7/16"	11 - 3/4"	8 - 1/2"	6 - 3/4"

BOX TYPE / LUMEN OUTPUT - STANDARD BEAMS (WW)			
LUMEN OUTPUT	BOX - A		
	CP	IC	ICAT
10LM	✓	✓	✓
15LM	✓	✓	✓
20LM			

PROJECT INFORMATION			
JOB NAME		TYPE	
ORDERING CODE			

BATTERY OPTIONS

EMERGENCY BATTERY

IOTA's ILB Battery Backups are UL Listed LED emergency drivers that allow the same LED fixture to be used for both normal and emergency operation. In the event of a power failure, the ILB switches to the emergency mode and operates the existing fixture for 90 minutes. The unit contains a battery, charger, and converter circuit in a single can. The Constant Power design of the ILB maintains the output wattage to the LED array even as the system voltage diminishes. UL 924 Listed for U.S. and Canada. UL 1310 Certified, Output Class 2 Compliant. Includes single-piece TBTS test switch and charge indicator accessory kit. For use with switched and unswitched fixtures, and includes Two-wire universal AC input. Meets or exceeds all National Electric Code and Life Safety Code Emergency Lighting Requirements. Rated for use in Plenum, Damp Location, Recessed Type IC, and Enclosed and Gasketed Luminaires.

REMOTE TEST SWITCH

The Remote Test Switch may be mounted adjacent to the LED Fixture by others..

EMERGENCY BATTERY ACCESS

Above ceiling access is recommended for ease of service, but LED Fixture Sizes of 4" and Larger are capable of below ceiling access. IC/ICAT/CP Box and ITS option require an access panel in the ceiling (or other form of access) adjacent to the installation location of the Emergency Battery.

REMOTE LOCATION

Maximum remote mounting distance of the emergency driver shall be 50 feet. Remote location wiring provided by others. Follow all Local and National Electric/ Building Codes.

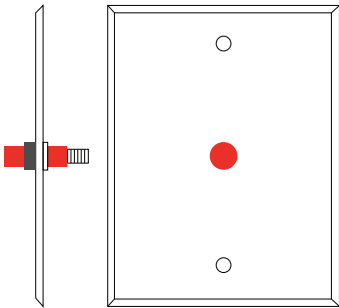

Remote Test Switch

EM MODE OUTPUT (DELIVERED LUMENS)			
LUMEN ORDERING CODE	EM7	EM10	EM12
ALL OPTIONS (10LM TO 20LM)	805LM	688LM	940LM
Notes: Based on 24K, 90CRI			

NC - NEW CONSTRUCTION
WITH EM BATTERY (REMOTE TEST SWITCH)

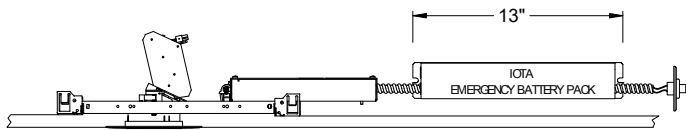

IC / ICAT / CP - INSULATION CONTACT HOUSING
WITH EM BATTERY (REMOTE TEST SWITCH)

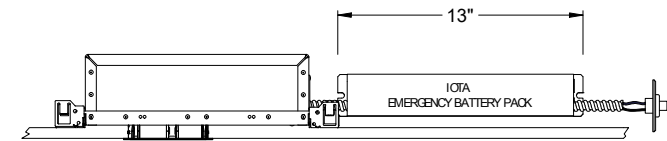

RET - RETROFIT
WITH EM BATTERY (REMOTE TEST SWITCH)

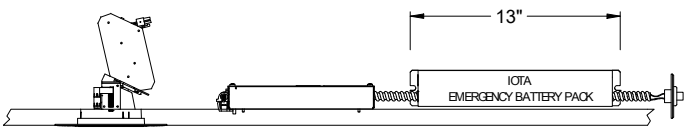

Accessory
76066 Optional T-Grid Mounting Kit¹

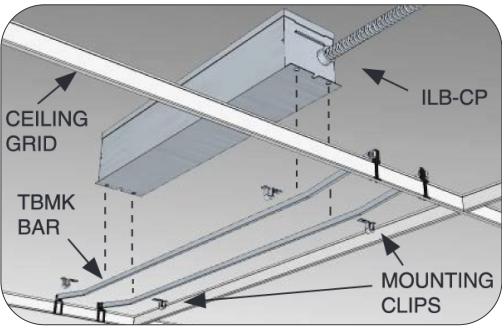

1. Can be used with any of the Emergency Battery Backups. Must be ordered as a separate line item.

PROJECT INFORMATION			
JOB NAME		TYPE	
ORDERING CODE			

AWNRR OPTIONS

Athena Wireless Node

The Athena wireless node is a radio frequency (RF) device that enables simple, digital control of individual light fixtures in an Athena control system.



Athena Wireless Node RF

AWNRR

Plenum rated and can be installed above the ceiling for wireless control of a fixture without any impact on fixture aesthetics.

FEATURES

- Enables individual, wireless control of each fixture in an Athena control system. Accommodates zone and control changes without rewiring.
- Installed at factory – no wiring required on-site. Fixture is ready to communicate wirelessly once power is connected.
- All drivers on the link are controlled as a single zone.

REGULATORY APPROVALS

- cULus Listed (UL916)
- Complies with requirements for use in other spaces used for environmental air (plenums) per NEC® 2014 300.22(C)(3).
- FCC compliant with the limits for a Class B digital device.
- IC (Industry Canada)
- ANSI C137.1 0-10 V- Electronic Off

POWER / LOAD

- IEC SELV/NEC® Class 2
- 1 Watt

ENVIRONMENTAL

- Ambient operating temperature (immediate vicinity of Athena wireless node): **32 °F to 131 °F** (0 °C to 55 °C), 0% to 90% humidity.

BATTERY OPTIONS

- For EM options please consult factory.

Note: Default behavior prior to programming

- Light level 100%
- Athena wireless node performs an unprogrammed startup sequence on every power up until the device is added to an Athena system.
- Each Athena wireless node should be installed within 25 ft (7.62 m) of two or more Athena wireless nodes or other Clear Connect – Type X devices.
- For Chicago plenum installations, the Athena wireless node may not be installed in the plenum space. It must be installed in the occupied space.

For servicing the driver/j-box, access above ceiling is required. (NC Mounting)

IC/ICAT/CP not available in AWNRR.

NC - NEW CONSTRUCTION

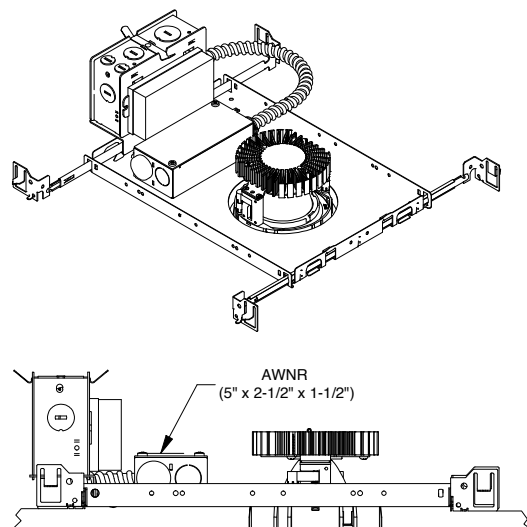

RET - RETRO FIT

