

alphabet

PROJECT INFORMATION		
JOB NAME		TYPE
ORDERING CODE		

NU3

3" Round Downlight Deep Regress Tunable White



Trim



Trimless



Trimless Millwork

20° - 45° BEAM (Note: Specifications are subject to change without notice)		
18mm LUMINUS COB PERFORMANCE DATA		
LED LIGHT ENGINE	NOMINAL DELIVERED LUMENS	SYSTEM WATTAGE
20LM	1570LM @35K/95CRI	23W
Notes	Delivered lumens based on 45D optic with no lens, (see page 2)	

20° - 50° BEAM (Note: Specifications are subject to change without notice)		
14mm LUMINUS COB PERFORMANCE DATA		
LED LIGHT ENGINE	NOMINAL DELIVERED LUMENS	SYSTEM WATTAGE
13LM	980LM @35K/95CRI	15W
Notes	Delivered lumens based on 35D optic with no lens, (see page 2)	

20° - 50° BEAM (Note: Specifications are subject to change without notice)		
18mm NICHIA COB PERFORMANCE DATA		
LED LIGHT ENGINE	NOMINAL DELIVERED LUMENS	SYSTEM WATTAGE
10LM	1370LM @35K/85CRI	15W
20LM	1630LM @35K/85CRI	18W
30LM	2400LM @35K/85CRI	32W
Notes	Delivered lumens based on 30D optic with no lens, (see page 3)	



FEATURES

- Quiet Ceiling Achieved Through 2" Deep Regress
- Superior 32.5° Cut Off Angle
- 1/16" micro flange
- UGR <5
- 20° - 50° Optical Beam Control
- Multiple Mounting, Glare Control Options, Trims, And Finishes Available

LED

- Luminus tunable white COB from 2700K - 6500K: 95 CRI, R9 > 70; SDCM = 4-step MacAdam Ellipse; Lumen Maintenance: L₇₀ > 54,000 hrs
- Nichia tunable white COB from 2700K to 5000K: 80 CRI, R9 > 0; SDCM = 3-step MacAdam Ellipse; Lumen Maintenance: L₉₀ > 33,000 hrs

DIMMING AND CONTROLS

- eldoLED flicker free 0-10V dimming to 0%
- eldoLED flicker free DALI dimming to 0%
- Casambi bluetooth dimming to 0%
- NLight control interface dimming to 0%

LISTING

- ULus Listed to UL1598 & UL2108; cUL Listed to CSA C22.2 #250.0
- IP65 with lens - Suitable for wet locations with lens - Suitable for damp locations without lens
- Non-conductive, dead-front construction (Shower Approved)
- NSF/ANSI-2 Listed, with lens (Non-Food and Splash Zones)
- <5 Year Limited warranty

CONSTRUCTION

- Lexan™ (PC) highly resistant to impact and heat (240°F)
- Optimal material for wireless BLE signal connectivity
- Shatter proof acrylic bezel lens
- Electrocoated 16-gauge cold-rolled steel construction
- Accommodates ceiling thickness from 1/8" to 1-5/8"

ELECTRICAL

- 120V-277V
- Power factor ≥ 0.9
- 2kV driver input surge protection
- Max. ambient installation temperature 95°F (35°C)
- Battery Backup not offered. Emergency Generator/Inverter/Controls-Override Device supplied by others

FIXTURE HEIGHT

LUMINUS: LED LIGHT ENGINE: 1300LM
NICHIA: LED LIGHT ENGINE: 1000LM - 2000LM

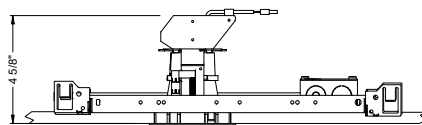

LUMINUS: LED LIGHT ENGINE: 2000LM
NICHIA: LED LIGHT ENGINE: 3000LM

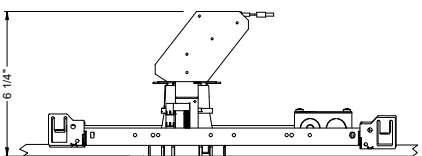

TRIMMED

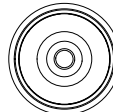

ceiling cutout
3-3/8" diameter
ceiling thickness
1/8" to 1-5/8"

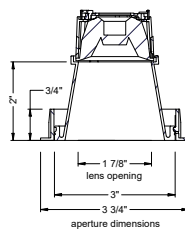

TRIMLESS

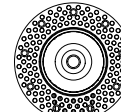

ceiling cutout
3-1/2" diameter
ceiling thickness
3/8" to 1-3/4"

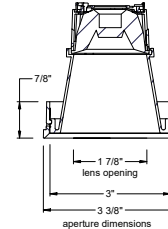

MILLWORK

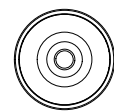

ceiling cutout
3-1/2" diameter
ceiling thickness
1/2" to 1-3/4"

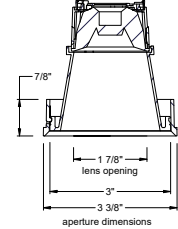

alphabet

PROJECT INFORMATION		
JOB NAME		TYPE
ORDERING CODE		

20°- 50° BEAM ORDERING CODE

SERIES	NU3	NU3																							
TYPE	RDDR	round downlight deep regress																							
	RDTDR	round downlight trimless deep regress																							
	RDTM-WDR	round downlight trimless millwork deep regress																							
LED	TW	tunable white (Luminus)																							
DELIVERED LUMENS	13LM ¹	980 lm																							
	20LM ²	1570 lm																							
Standard Configuration: 3500K 40D NL Calculated Delivered Lumens = [Delivered Lumen Value] x [CCT Multiplier] x [Optic Multiplier] x [Lens Multiplier]																									
CCT	2765	2700K to 6500K tunable white																							
		<table border="1"> <thead> <tr> <th>CCT</th> <th>2700K</th> <th>3000K</th> <th>3500K</th> <th>4000K</th> <th>5000K</th> <th>5700K</th> <th>6500K</th> </tr> </thead> <tbody> <tr> <td>CCT MULTIPLIER FOR LUMEN OUTPUT</td> <td>0.91</td> <td>0.98</td> <td>1.00</td> <td>0.99</td> <td>1.00</td> <td>1.01</td> <td>1.02</td> </tr> <tr> <td>EML RATIO</td> <td>0.49</td> <td>0.57</td> <td>0.68</td> <td>0.79</td> <td>0.96</td> <td>1.04</td> <td>1.12</td> </tr> </tbody> </table>	CCT	2700K	3000K	3500K	4000K	5000K	5700K	6500K	CCT MULTIPLIER FOR LUMEN OUTPUT	0.91	0.98	1.00	0.99	1.00	1.01	1.02	EML RATIO	0.49	0.57	0.68	0.79	0.96	1.04
	CCT	2700K	3000K	3500K	4000K	5000K	5700K	6500K																	
	CCT MULTIPLIER FOR LUMEN OUTPUT	0.91	0.98	1.00	0.99	1.00	1.01	1.02																	
EML RATIO	0.49	0.57	0.68	0.79	0.96	1.04	1.12																		
1840	1800K to 4000K tunable white																								
	<table border="1"> <thead> <tr> <th>CCT</th> <th>1800K</th> <th>2000K</th> <th>2400K</th> <th>2700K</th> <th>3000K</th> <th>3500K</th> <th>4000K</th> </tr> </thead> <tbody> <tr> <td>CCT MULTIPLIER FOR LUMEN OUTPUT</td> <td>0.67</td> <td>0.74</td> <td>0.8</td> <td>0.85</td> <td>0.88</td> <td>0.95</td> <td>1.01</td> </tr> <tr> <td>EML RATIO</td> <td>0.21</td> <td>0.33</td> <td>0.46</td> <td>0.53</td> <td>0.59</td> <td>0.67</td> <td>0.73</td> </tr> </tbody> </table>	CCT	1800K	2000K	2400K	2700K	3000K	3500K	4000K	CCT MULTIPLIER FOR LUMEN OUTPUT	0.67	0.74	0.8	0.85	0.88	0.95	1.01	EML RATIO	0.21	0.33	0.46	0.53	0.59	0.67	0.73
CCT	1800K	2000K	2400K	2700K	3000K	3500K	4000K																		
CCT MULTIPLIER FOR LUMEN OUTPUT	0.67	0.74	0.8	0.85	0.88	0.95	1.01																		
EML RATIO	0.21	0.33	0.46	0.53	0.59	0.67	0.73																		
CRI	95	95 typical, 90 minimum																							
OPTIC & LM MULTIPLIER SEE PAGE 4	20D	20 degrees	(0.92)																						
	25D	25 degrees	(0.90)																						
	30D	30 degrees	(0.94)																						
	35D	35 degrees	(1.00)																						
	45D	45 degrees	(0.99)																						
	50D	50 degrees	(0.98)																						
BEZEL LENS SEE PAGE 4	NL ³	no lens	(1.00)																						
	DL ⁴	diffused lens	(0.83)																						
	HET	high efficiency textured lens, similar to Solite™	(0.90)																						
	SBL	smoothing beam lens	(0.93)																						
	HCL	honeycomb louver	(0.76)																						
TRIM COLOR SEE PAGE 4	BK	black																							
	WH	white																							
	MC	matte chrome																							
	BZ	bronze																							
	WT	wheat																							
Not applicable to trimless option. Do not include in trimless ordering code.																									
BEZEL COLOR SEE PAGE 4	BK	black	(0.85)																						
	WH	white	(0.98)																						
	MC	matte chrome	(0.94)																						
	DC ⁵	dark chrome, vacuum metalized	(0.90)																						
	GN ⁵	gun metal, vacuum metalized	(0.98)																						
	SA ⁵	specular, vacuum metalized	(1.00)																						
	CU ⁵	copper, vacuum metalized	(0.94)																						
AU ⁵	gold, vacuum metalized	(0.96)																							

20°- 50° BEAM ORDERING CODE

MOUNTING OPTIONS SEE PAGE 8, 9	NC	new construction with ceiling fitting plate
VOLTAGE	UNV	120V-277V
DIMMING	CASZ	Casambi Bluetooth dim to zero
	NLT	nLight control interface: standard Cat-5/RJ45 connection (female), dim to off
	DALIZ	eldoLED flicker free DALI 2 dimming to 0%
	DIM10Z ⁵	eldoLED flicker free 0-10V dimming to 0%

ADDITIONAL MOUNTING INFO

New Construction Bar Hangers (included)	Mounting Length: 14-3/4" to 26"
Extension Kit p/n: K20266 (ordered separately, 1 per fixture)	Extends a pair of Bar Hangers Total Mounting Length: 29" to 48"

YOUR COMPLETED ORDERING CODE

Follow the steps to specify your fixture, example:	
NU3 - RDDR - TW - 20LM - 2765 - 95 - 35D - SBL - WH - DC - NC - UNV - DIM10	

NOTES

- 13LM not available in 30D/45D optics.
- 20LM not available in 20D/50D optics.
- NL option does not meet requirement for AT/DF/WET/NSF listings.
- DL/HET lens options not recommended in WHITE bezel color, UGR>20.
- DL/HET lens options available in DC/GN/SA/CU/AU color with 45D/50D optics.
- Requires 2 wall controllers (see wiring diagram)

*EML = equivalent melanopic lux. To calculate EML, multiply the measured photopic lux by the EML Ratio for the given CCT.
Example: 254 lux x 0.79 = 200 melanopic lux at 4000K.

alphabet

PROJECT INFORMATION		
JOB NAME		TYPE
ORDERING CODE		

20° - 50° BEAM ORDERING CODE

SERIES	NU3	NU3										
TYPE	RDDR	round downlight deep regress										
	RDTDR	round downlight trimless deep regress										
	RDTM-WDR	round downlight trimless millwork deep regress										
LED	TW	tunable white (Nichia)										
DELIVERED LUMENS	15LM	1370 lm										
	20LM	1630 lm										
	30LM	2400 lm										
Standard Configuration: 3500K 30D NL Calculated Delivered Lumens = [Delivered Lumen Value] x [CCT Multiplier] x [Optic Multiplier] x [Lens Multiplier]												
CCT	2750	2700K to 5000K tunable white										
		<table border="1"> <thead> <tr> <th>CCT</th> <th>2700K</th> <th>3000K</th> <th>3500K</th> <th>4000K</th> <th>5000K</th> </tr> </thead> <tbody> <tr> <td>EML RATIO</td> <td>0.43</td> <td>0.51</td> <td>0.63</td> <td>0.69</td> <td>0.80</td> </tr> </tbody> </table>	CCT	2700K	3000K	3500K	4000K	5000K	EML RATIO	0.43	0.51	0.63
CCT	2700K	3000K	3500K	4000K	5000K							
EML RATIO	0.43	0.51	0.63	0.69	0.80							
CRI	80	80 CRI										
OPTIC & LM MULTIPLIER SEE PAGE 3	20D	20 degrees	(0.91)									
	25D	25 degrees	(0.92)									
	30D	30 degrees	(1.00)									
	50D	50 degrees	(0.99)									
BEZEL LENS SEE PAGE 3	NL ¹	no lens	(1.00)									
	DL ²	diffused lens	(0.85)									
	HET	high efficiency textured lens, similar to Solite™	(0.91)									
	SBL	smoothing beam lens	(0.94)									
	HCL	honeycomb louver	(0.80)									
TRIM COLOR SEE PAGE 3	BK	black										
	WH	white										
	MC	matte chrome										
	BZ	bronze										
	WT	wheat										
Not applicable to trimless option. Do not include in trimless ordering code.												
BEZEL COLOR SEE PAGE 3	BK	black	(0.85)									
	WH	white	(0.98)									
	MC	matte chrome	(0.94)									
	DC ³	dark chrome, vacuum metalized	(0.90)									
	GN ³	gun metal, vacuum metalized	(0.98)									
	SA ³	specular, vacuum metalized	(1.00)									
	CU ³	copper, vacuum metalized	(0.94)									
AU ³	gold, vacuum metalized	(0.96)										

20° - 50° BEAM ORDERING CODE

MOUNTING OPTIONS SEE PAGE 8, 9	NC	new construction with ceiling fitting plate
	VOLTAGE	UNV 120V-277V
DIMMING	CASZ	Casambi Bluetooth dim to zero
	NLT	nLight control interface: standard Cat-5/RJ45 connection (female), dim to off
	DALIZ	eldoLED flicker free DALI 2 dimming to 0%
	DIM10Z ⁴	eldoLED flicker free 0-10V dimming to 0%

ADDITIONAL MOUNTING INFO

New Construction Bar Hangers (included)	Mounting Length: 14-3/4" to 26"
Extension Kit p/n: K20266 (ordered separately, 1 per fixture)	Extends a pair of Bar Hangers Total Mounting Length: 29" to 48"

YOUR COMPLETED ORDERING CODE

Follow the steps to specify your fixture, example:
NU3 - RDDR - TW - 20LM - 2750 - 80 - 30D - SBL - WH - DC - NC - UNV - DIM10

NOTES

- NL option does not meet requirement for AT/DF/WET/NSF listings.
- DL/HET lens options not available in WHITE bezel color.
- DL/HET lens options available in DC/GN/SA/CU/AU color with 50D optic.
- 4 Requires 2 wall controllers (see wiring diagram)

*EML = equivalent melanopic lux. To calculate EML, multiply the measured photopic lux by the EML Ratio for the given CCT.
Example: 254 lux x 0.79 = 200 melanopic lux at 4000K.

alphabet

PROJECT INFORMATION		
JOB NAME		TYPE
ORDERING CODE		

TRIM OPTIONS

TRIM/BEZEL COLORS

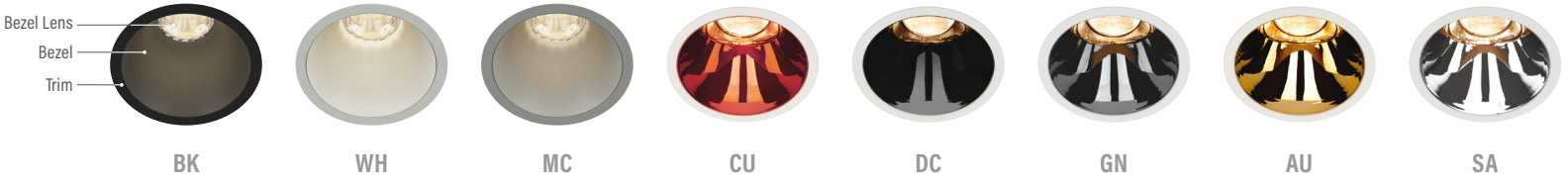

LUMINUS OPTICAL OPTIONS

- Calculations based on 13LM fixtures, SA bezel, unless otherwise noted
- UGR calculation based on CIE 117-1995; room size: 4H X 8H, reflectance: 70/50/20;



OPTIC	BEAM ANGLE	UGR
20D	19.6	8
25D	25	5.4



OPTIC	BEAM ANGLE	UGR
20D	19.8	≤5
25D	26	6.1



OPTIC	BEAM ANGLE	UGR
20D	31	11.9
25D	36	13.8
35D	41.2	14.3
50D	54	17



OPTIC	BEAM ANGLE	UGR
20D	22	18.2
25D	27.8	16.4
35D	33.4	16.8
50D	48.8	18.4

* White Bezel



OPTIC	BEAM ANGLE	UGR
20D	20.4	7.3
25D	26.4	7.4



OPTIC	BEAM ANGLE	UGR
20D	22.2	7.9
25D	27.4	8.6
35D	31.4	8.8
50D	44.6	13.8

GLARE CONTROL

CUT-OFF ANGLE

Visual comfort is achieved with a lower cut-off angle due to improved glare control. The smaller the cut-off angle, the easier it is on the eye.

Alphabet downlights have been thoughtfully engineered to eliminate glare while still delivering functional illumination.

- Cutoff angle is 32.5 degrees;

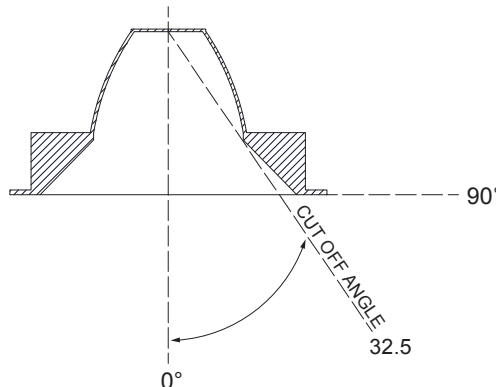

alphabet

PROJECT INFORMATION		
JOB NAME		TYPE
ORDERING CODE		

TRIM OPTIONS

TRIM/BEZEL COLORS

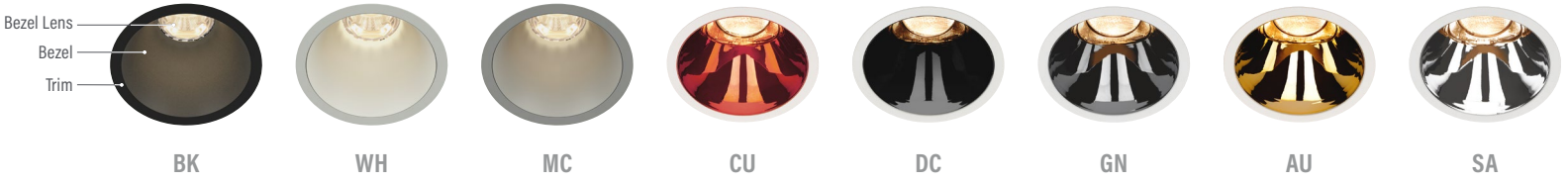

NICHIA OPTICAL OPTIONS

- UGR calculation based on 15LM fixtures, unless otherwise noted.
- UGR calculation based on CIE 117-1995; room size: 4H X 8H, reflectance: 70/50/20;



OPTIC	BEAM ANGLE	UGR
20D	17	≤5
25D	22.8	≤5



OPTIC	BEAM ANGLE	UGR
20D	16.8	≤5
25D	23.5	≤5



OPTIC	BEAM ANGLE	UGR
20D	29.6	11.8
25D	34	14
30D	39.8	14.8
50D	53.8	18



OPTIC	BEAM ANGLE	UGR
20D	18.6	17.7
25D	25	16.5
30D	31	16.3
50D	49.4	18.7

* White Bezel



OPTIC	BEAM ANGLE	UGR
20D	17.2	≤5
25D	23.6	7.2



OPTIC	BEAM ANGLE	UGR
20D	19.8	6.4
25D	25.2	9.4
30D	29.6	8.2
50D	44.8	14.8

GLARE CONTROL

CUT-OFF ANGLE

Visual comfort is achieved with a lower cut-off angle due to improved glare control. The smaller the cut-off angle, the easier it is on the eye.

Alphabet downlights have been thoughtfully engineered to eliminate glare while still delivering functional illumination.

- Cutoff angle of NL and CL is 32.5 degrees;

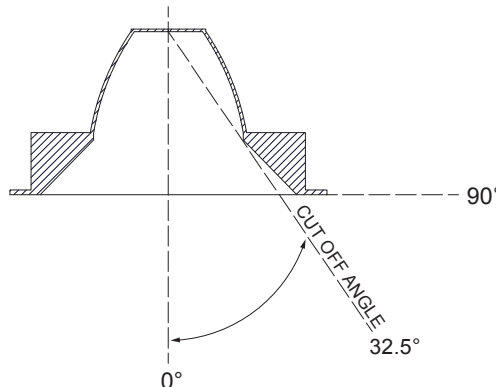

alphabet

PROJECT INFORMATION		
JOB NAME		TYPE
ORDERING CODE		

PHOTOMETRIC DATA

LUMINUS CTM14 - 13LM

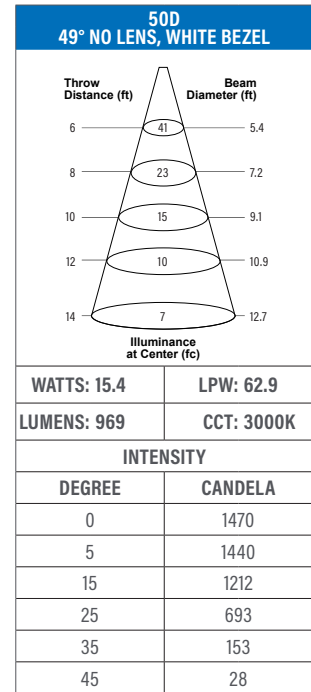
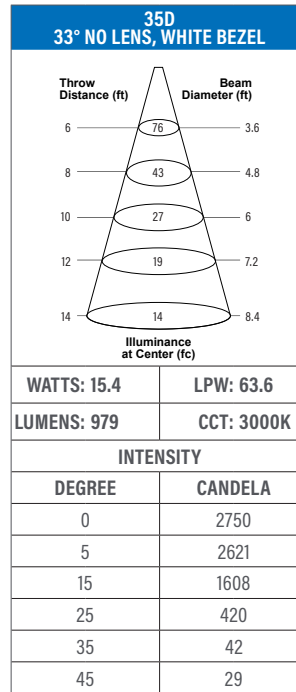
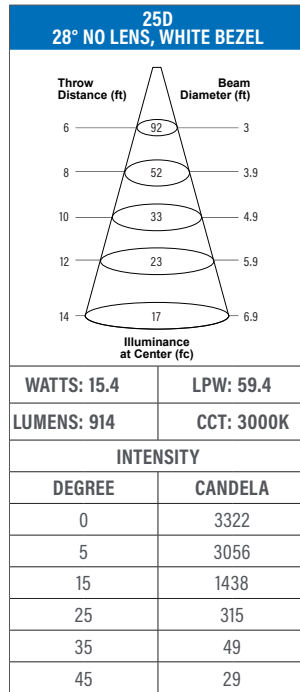
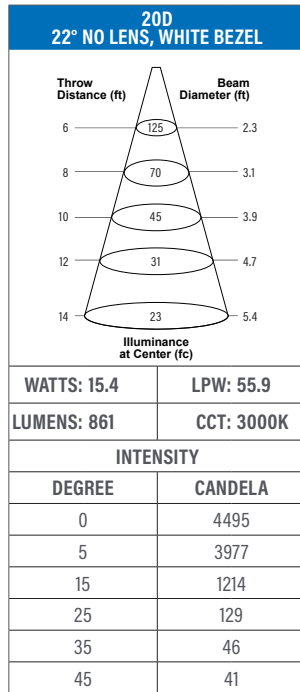

LUMINUS CTM18 - 20LM

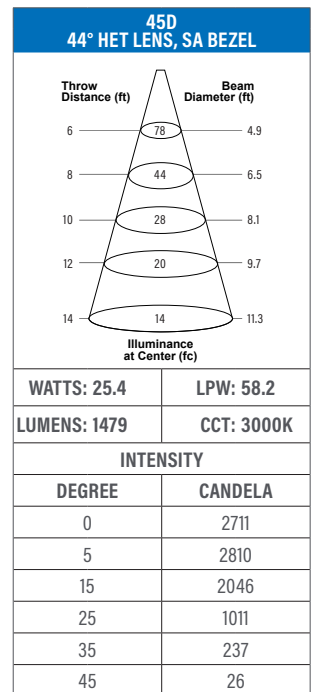
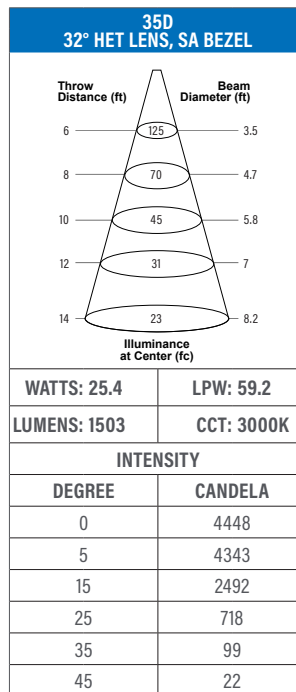
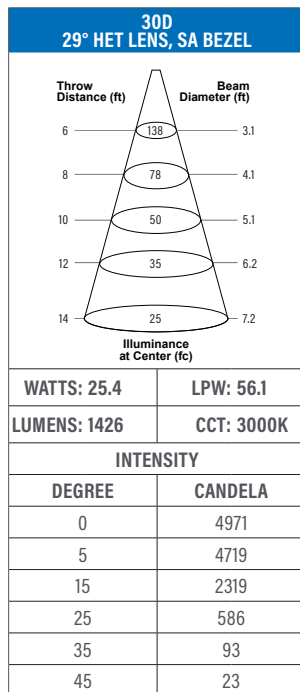
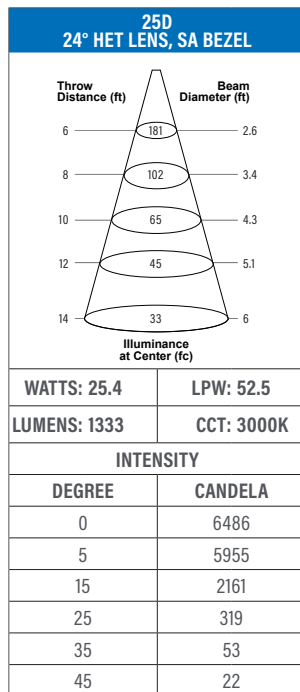

alphabet

PROJECT INFORMATION		
JOB NAME		TYPE
ORDERING CODE		

PHOTOMETRIC DATA (CONTINUED)

NICHIA - 15LM

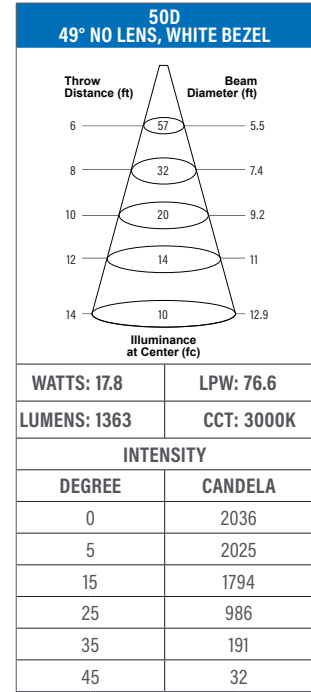
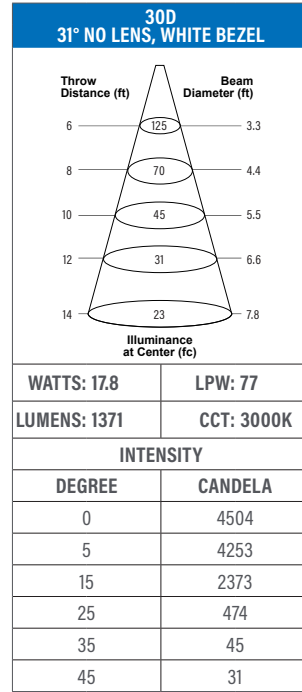
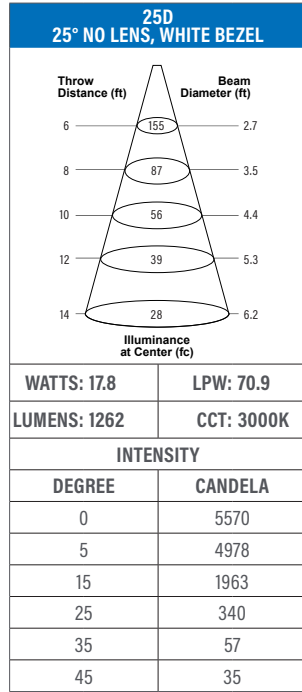
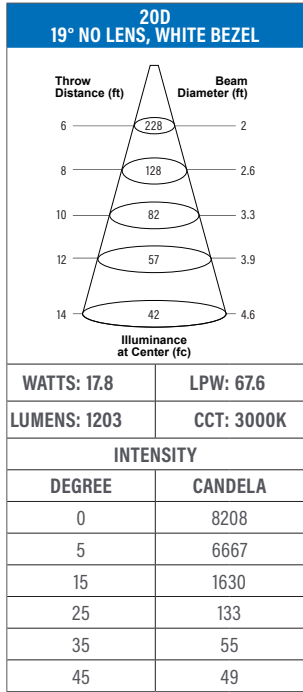

NICHIA - 30LM

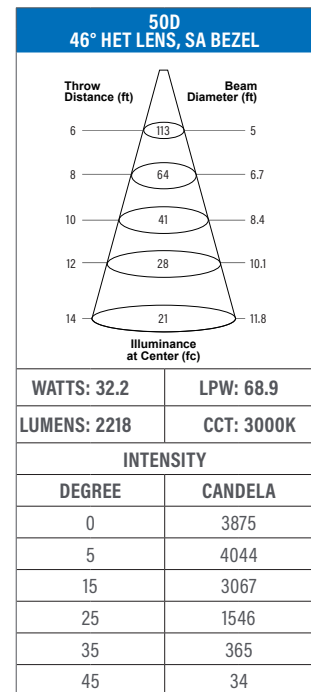
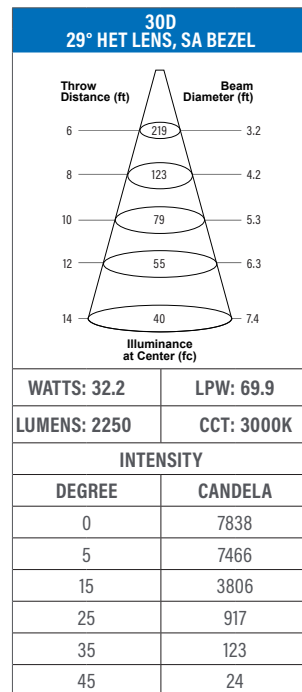
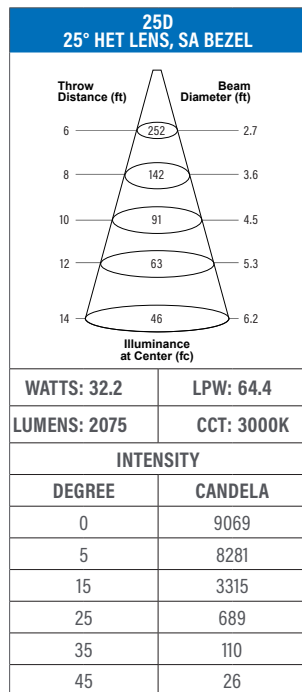
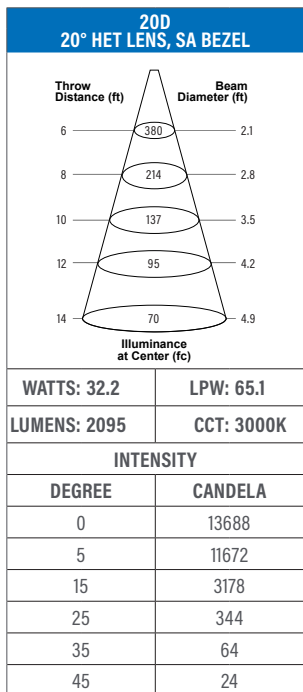

PROJECT INFORMATION		
JOB NAME		TYPE
ORDERING CODE		

MOUNTING OPTIONS

NC - NEW CONSTRUCTION

TRIM

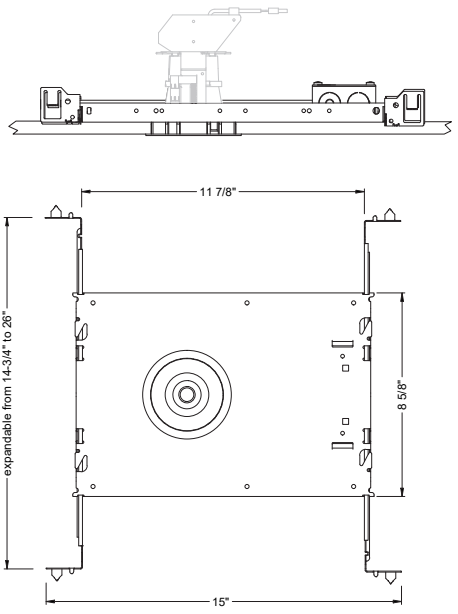

TRIM

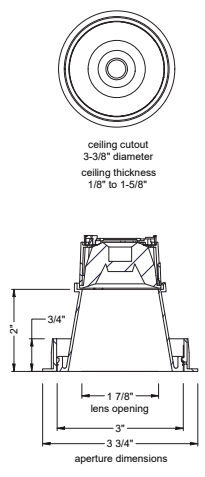

TRIMLESS

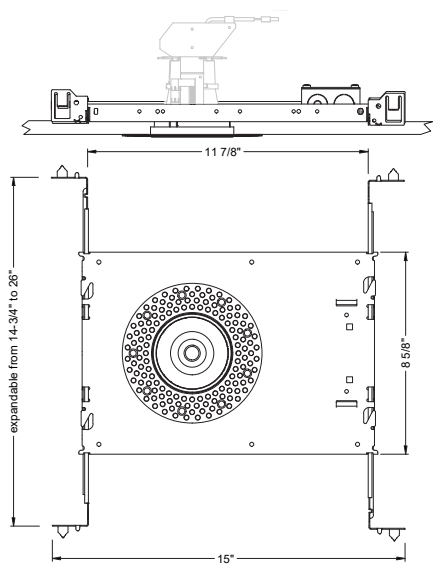

TRIMLESS

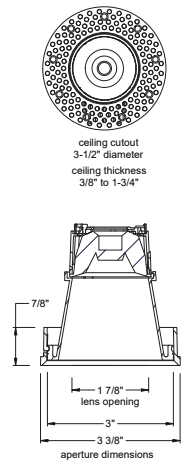

TRIMLESS/MILLWORK

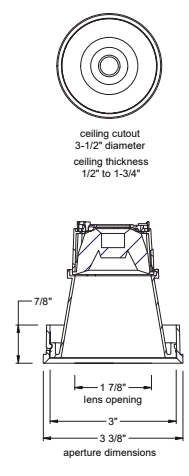

NOTE:
For servicing the driver/j-box, access above ceiling is required. T-Bar type ceilings with removable adjacent tile access recommended. Hard lid ceilings may require access doors directly adjacent to luminaire

PROJECT INFORMATION		
JOB NAME	TYPE	
ORDERING CODE		

MOUNTING OPTIONS (CONTINUED)

FIXTURE HEIGHT

LUMINUS: LED LIGHT ENGINE: 1300LM
 NICHIA: LED LIGHT ENGINE: 1000LM - 2000LM

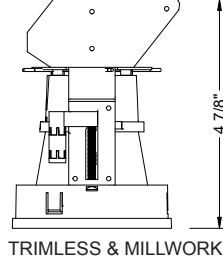
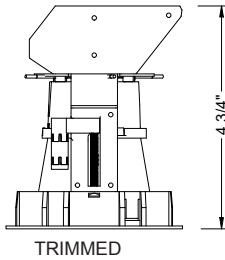

LUMINUS: LED LIGHT ENGINE: 2000LM
 NICHIA: LED LIGHT ENGINE: 3000LM

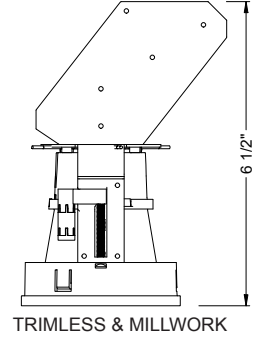
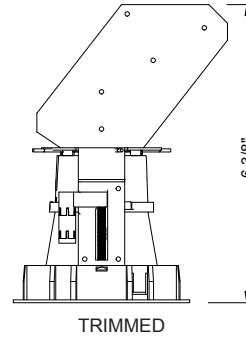

RATINGS / CERTIFICATIONS	NC
TYPE NON-IC	✓
TYPE IC	
CHICAGO PLENUM (CCEA)	
SUITABLE FOR AIR HANDLING PLENUMS	✓
REDUCED AIRFLOW (WITH LENS) ASTM E283	✓

CEILING THICKNESS	
FIXTURE TYPE	MOUNTING TYPE
	NC
TRIM	1/8" to 1-5/8"
TRIMLESS	3/8" to 1-3/4"
MILLWORK (TRIMLESS)	1/2" to 1-3/4"

PROJECT INFORMATION		
JOB NAME	TYPE	
ORDERING CODE		

TUNABLE WHITE

LUMINUS 95CRI

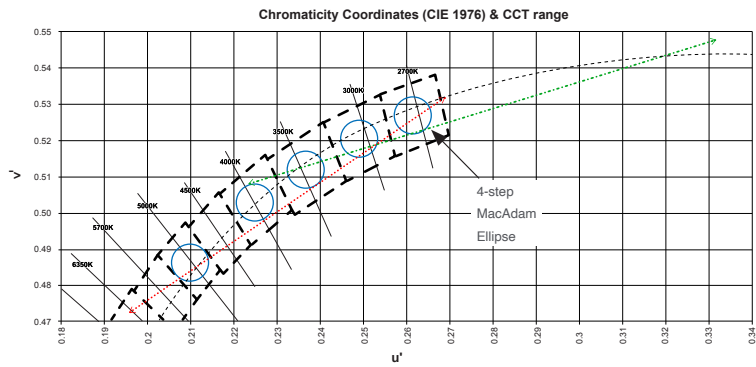

NICHIA 80CRI

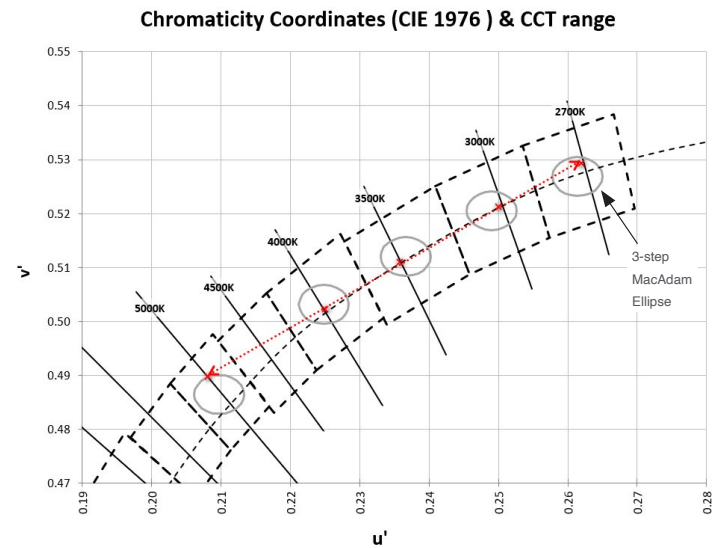

WIRING DIAGRAMS

“CAS” CASAMBI CONTROLS

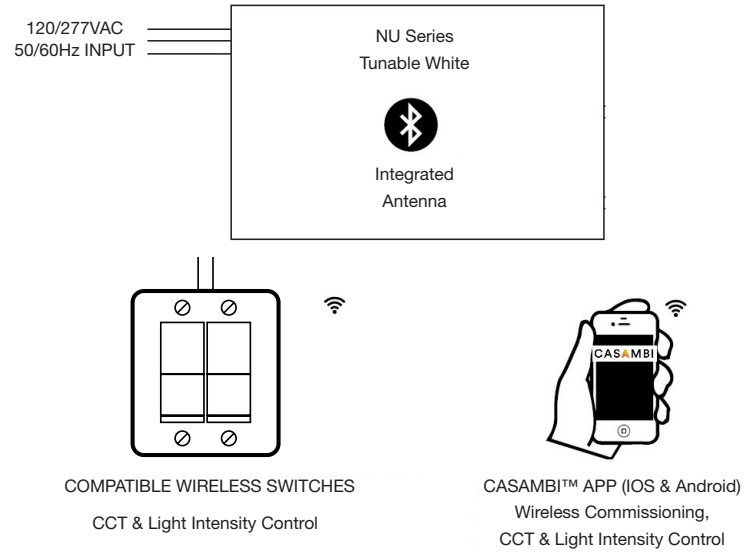

“DIM10Z” HARDWIRED 0-10V CONTROL

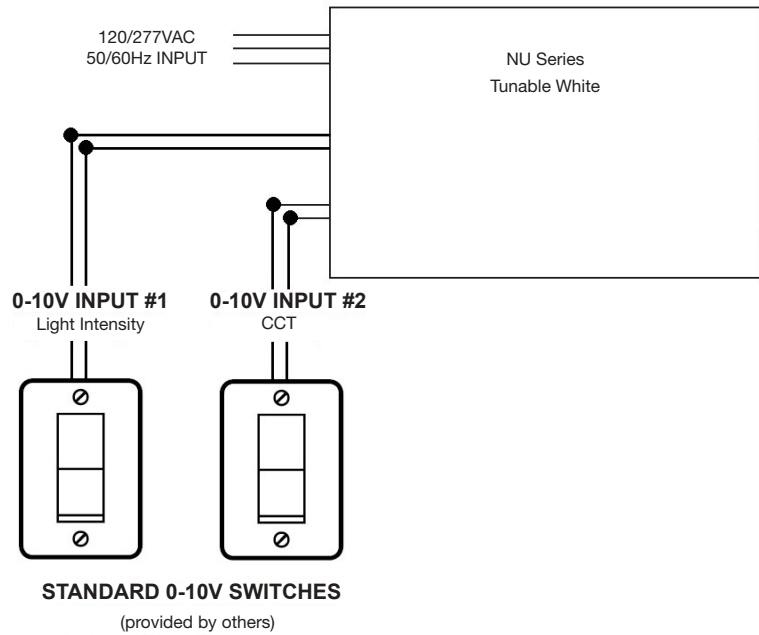

NOTES

- 1 Consult factory to order compatible wireless switches.