

# alphabet

## LAMBDA

### Remote Driver



#### LISTINGS

- ETLus Listed to UL2108 (suitable for dry and damp locations)
- cETL Listed to CSA C22.2 #250.0

PROJECT INFORMATION		
JOB NAME		TYPE
ORDERING CODE		

#### ORDERING CODE

PART NUMBER	DMNREM	remote driver
VOLTAGE & DIMMING	UNV-DIM10-30	flicker free 0-10V dimming to 1%
	UNV-DIM10Z-30	flicker free 0-10V dimming to 0.1%
	UNV-DIM10-50	flicker free 0-10V dimming to 1%
	UNV-DIM10Z-50	flicker free 0-10V dimming to 0.1%
	UNV-DALI-50	flicker free DALI dimming to 1%
	UNV-DALIZ-50	flicker free DALI dimming to 0.1%
	UNV-DMX-50	flicker free DMX dimming to 0.1%
	120-ELV-12	leading & trailing edge dimming (Triac/ELV)
	120-ELV-25	leading & trailing edge dimming (Triac/ELV)
	UNV-LUT-b	Lutron Hi-Lume Ecosystem dimming to 1%, Soft-on & Fade-to-Black
UNV-LUT-c	Lutron Hi-Lume Ecosystem dimming to 1%, Soft-on & Fade-to-Black	
UNV-LUT-d	Lutron Hi-Lume Ecosystem dimming to 1%, Soft-on & Fade-to-Black	
UNV-LUTP-20	Lutron Hi-Lume Premier Ecosystem dimming to 0.1%, Soft-on & Fade-to-Black	

#### ORDERING CODE

Follow the steps to specify your fixture, example:

DMNREM - UNV - DIM10 - 30

PROJECT INFORMATION		
JOB NAME		TYPE
ORDERING CODE		

## REMOTE POWER SUPPLY MATRIX (MIN-MAX UNITS & DIMMING RANGE)

	DF1	DF2	DF3
DMNREM-UNV-DIM10-30	1-12	1-6	1-4
DMNREM-UNV-DIM10Z-30	1-12	1-6	1-4
DMNREM-UNV-DIM10-50	1-16	1-8	1-5
DMNREM-UNV-DIM10Z-50 <sup>1</sup>	1-21 (16)	1-10 (8)	1-7 (5)
DMNREM-UNV-DALI-50	1-16	1-8	1-5
DMNREM-UNV-DALIZ-50 <sup>1</sup>	1-21 (16)	1-10 (8)	1-7 (5)
DMNREM-UNV-DMX-50 <sup>1</sup>	1-21 (16)	1-10 (8)	1-7 (5)
DMNREM-120-ELV-12	2-5	1-2	1
DMNREM-120-ELV-25	5-10	3-5	2-3
DMNREM-UNV-LUT-b	11-15	6-7	4-5
DMNREM-UNV-LUT-c	7-11	4-5	3
DMNREM-UNV-LUT-d	5-6	3	2
DMNREM-UNV-LUTP-20	4-7	2-3	2
DMNREM-UNV-CAS-50 <sup>1</sup>	1-21 (16)	1-10 (8)	1-7 (5)
DMNREM-UNV-NLT-50 <sup>1</sup>	1-21 (16)	1-10 (8)	1-7 (5)

DIMMING RANGE DOWN TO XX %	Dims to 0.1%
	Dims to 1%
	Dims to 5%
	Dims to 10%

### NOTES

1. DMNREM-UNV-DIM10Z-50, DMNREM-UNV-DALIZ-50, DMNREM-UNV-DMX-50, DMNREM-UNV-CAS-50 and DMNREM-UNV-NLT-50 have multiple outputs. The number in parentheses "(x)" is the max number of fixtures per output.

## MAX WIRING DISTANCE

	20 AWG	18 AWG
DMNREM-UNV-DIM10-30	46'	72'
DMNREM-UNV-DIM10Z-30	46'	72'
DMNREM-UNV-DIM10-50	46'	72'
DMNREM-UNV-DIM10Z-50	46'	72'
DMNREM-UNV-DALI-50	46'	72'
DMNREM-UNV-DALIZ-50	46'	72'
DMNREM-UNV-DMX-50	46'	72'
DMNREM-120-ELV-12	20'	30'
DMNREM-120-ELV-25	20'	30'
DMNREM-UNV-LUT-b	20'	30'
DMNREM-UNV-LUT-c	20'	30'
DMNREM-UNV-LUT-d	20'	30'
DMNREM-UNV-LUTP-20	20'	30'
DMNREM-UNV-CAS-50	46'	72'
DMNREM-UNV-NLT-50	46'	72'

PROJECT INFORMATION		
JOB NAME		TYPE
ORDERING CODE		

## TECHNICAL SPECS

<p align="center"><b>UNV-DIM10-30, UNV-DIM10Z-30</b></p>	<p align="center"><b>UNV-DIM10-50, UNV-DIM10Z-50, UNV-DALI-50, UNV-DALIZ-50, UNV-DMX-50</b></p>	<p align="center"><b>120-ELV-12</b></p>
<ul style="list-style-type: none"> <li>- 120-277Vac, 50/60Hz input</li> <li>- 30W max output</li> <li>- 700mA DC constant current output</li> <li>- 2-55Vdc output</li> <li>- 0-10V compatible</li> <li>- Operating temperature: -4°F to 122°F</li> <li>- Class II rated</li> <li>- Suitable for use in damp and dry locations</li> <li>- Short circuit protection</li> <li>- Overload protection</li> <li>- Over-voltage protection</li> <li>- Thermal protection</li> <li>- Diagram 2</li> </ul>	<ul style="list-style-type: none"> <li>- 120-277Vac, 50/60Hz input</li> <li>- 50W max output</li> <li>- 700mA DC constant current output</li> <li>- 2-55Vdc output</li> <li>- DIM10/DIM10Z: 0-10V compatible</li> <li>- DALI/DALIZ: DALI-2 lighting control compatible</li> <li>- DMX: DMX compatible</li> <li>- Operating temperature: -4°F to 122°F</li> <li>- Class II rated</li> <li>- Suitable for use in damp and dry locations</li> <li>- Short circuit protection</li> <li>- Overload protection</li> <li>- Over-voltage protection</li> <li>- Thermal protection</li> <li>- Diagram 3</li> </ul>	<ul style="list-style-type: none"> <li>- 120Vac, 50/60Hz input</li> <li>- 12W max output</li> <li>- 700mA DC constant current output</li> <li>- 5-24Vdc output</li> <li>- ELV/Triac dimming compatible</li> <li>- Operating temperature: -40°F to 194°F</li> <li>- Class II rated</li> <li>- Suitable for use in damp and dry locations</li> <li>- Short circuit protection</li> <li>- Overload protection</li> <li>- Over-voltage protection</li> <li>- Thermal protection</li> <li>- Diagram 1</li> </ul>
<p align="center"><b>120-ELV-25</b></p>	<p align="center"><b>UNV-LUT-b, UNV-LUT-c, UNV-LUT-d</b></p>	<p align="center"><b>UNV-LUTP-20</b></p>
<ul style="list-style-type: none"> <li>- 120Vac, 50/60Hz input</li> <li>- 25W max output</li> <li>- 700mA DC constant current output</li> <li>- 12-36Vdc output</li> <li>- ELV/Triac dimming compatible</li> <li>- Operating temperature: -40°F to 194°F</li> <li>- Class II rated</li> <li>- Suitable for use in damp and dry locations</li> <li>- Short circuit protection</li> <li>- Overload protection</li> <li>- Over-voltage protection</li> <li>- Thermal protection</li> <li>- Diagram 2</li> </ul>	<ul style="list-style-type: none"> <li>- 120-277Vac, 50/60Hz input</li> <li>- LUT-b: 35W max output</li> <li>- LUT-c: 26W max output</li> <li>- LUT-d: 16W max output</li> <li>- 700mA DC constant current output</li> <li>- LUT-b: 30-50Vdc output</li> <li>- LUT-c: 20.6-37.1Vdc output</li> <li>- LUT-d: 12-22.9Vdc output</li> <li>- Lutron Ecosystem controls compatible</li> <li>- Operating temperature: 32°F to 167°F</li> <li>- Class II rated</li> <li>- Suitable for use in damp and dry locations</li> <li>- Short circuit protection</li> <li>- Open circuit protection</li> <li>- Overload protection</li> <li>- Over-voltage protection</li> <li>- Thermal protection</li> <li>- Diagram 2</li> </ul>	<ul style="list-style-type: none"> <li>- 120-277Vac, 50/60Hz input</li> <li>- 20W max output</li> <li>- 700mA DC constant current output</li> <li>- 10-28.6Vdc output</li> <li>- Lutron EcoSystem controls compatible</li> <li>- Operating temperature: 32°F to 176°F</li> <li>- Class II rated</li> <li>- Suitable for use in damp and dry locations</li> <li>- Short circuit protection</li> <li>- Open circuit protection</li> <li>- Overload protection</li> <li>- Over-voltage protection</li> <li>- Thermal protection</li> <li>- Diagram 1</li> </ul>
<p align="center"><b>UNV-CAS-50</b></p>	<p align="center"><b>UNV-NLT-50</b></p>	
<ul style="list-style-type: none"> <li>- 120-277Vac, 50/60Hz input</li> <li>- 50W max output</li> <li>- 700mA DC constant current output</li> <li>- 2-55Vdc output</li> <li>- Casambi bluetooth dimming compatible</li> <li>- Operating temperature: -4°F to 122°F</li> <li>- Class II rated</li> <li>- Suitable for use in damp and dry locations</li> <li>- Short circuit protection</li> <li>- Overload protection</li> <li>- Over-voltage protection</li> <li>- Thermal protection</li> <li>- Diagram 4</li> </ul>	<ul style="list-style-type: none"> <li>- 120-277Vac, 50/60Hz input</li> <li>- 50W max output</li> <li>- 700mA DC constant current output</li> <li>- 2-55Vdc output</li> <li>- nLight control interface with standard CAT5/RJ45 connection compatible</li> <li>- Operating temperature: -4°F to 122°F</li> <li>- Class II rated</li> <li>- Suitable for use in damp and dry locations</li> <li>- Short circuit protection</li> <li>- Overload protection</li> <li>- Over-voltage protection</li> <li>- Thermal protection</li> <li>- Diagram 5</li> </ul>	

# alphabet

PROJECT INFORMATION		
JOB NAME		TYPE
ORDERING CODE		

## DIMENSIONS

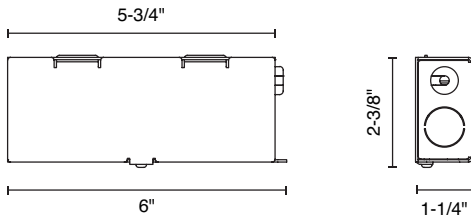

DIAGRAM 1

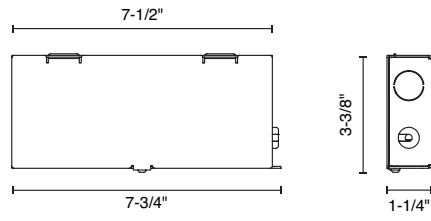

DIAGRAM 2

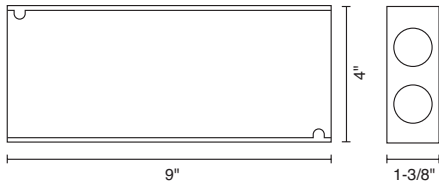

DIAGRAM 3

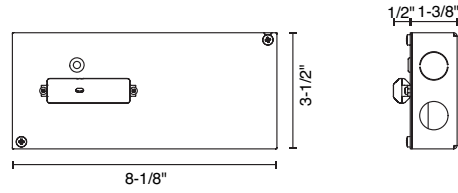

DIAGRAM 4

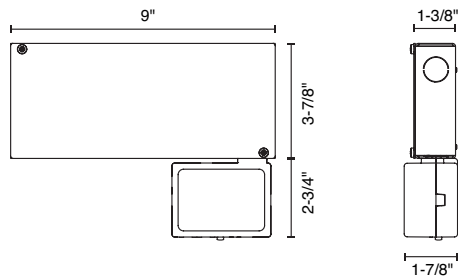

DIAGRAM 5

## WIRING DIAGRAMS

### DRIVER WIRING

