

alphabet

PROJECT INFORMATION		
JOB NAME		TYPE
ORDERING CODE		

BETA4R UP DOWN DR-SW/SW

4" Cylinder Standard White Deep Regress

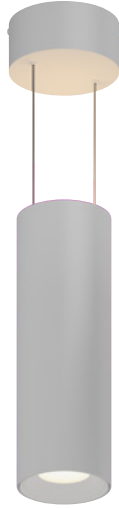

DOWNLIGHT

9° - 50° BEAM (Note: Specifications are subject to change without notice)		
LED LIGHT ENGINE	NOMINAL DELIVERED LUMENS	SYSTEM WATTAGE
10LM	920LM @30K/80CRI	9W
15LM	1340LM @30K/80CRI	13W
20LM	1740LM @30K/80CRI	17W
25LM	2120LM @30K/80CRI	22W
30LM	2550LM @30K/80CRI	27W
35LM	3050LM @30K/80CRI	34W
40LM	3420LM @30K/80CRI	40W
10LM	780LM @30K/90CRI	9W
15LM	1140LM @30K/90CRI	13W
20LM	1480LM @30K/90CRI	17W
25LM	1800LM @30K/90CRI	22W
30LM	2170LM @30K/90CRI	27W
35LM	2600LM @30K/90CRI	34W
40LM	2910LM @30K/90CRI	40W
Notes	Delivered lumens based on 30D optic with no lens, (see page 2)	

UPLIGHT

8° - 65° BEAM (Note: Specifications are subject to change without notice)		
LED LIGHT ENGINE	NOMINAL DELIVERED LUMENS	SYSTEM WATTAGE
10LM	990LM @30K/80CRI	9W
15LM	1485LM @30K/80CRI	12W
20LM	2095LM @30K/80CRI	17W
25LM	2540LM @30K/80CRI	21W
10LM	840LM @30K/90CRI	9W
15LM	1260LM @30K/90CRI	12W
20LM	1780LM @30K/90CRI	17W
25LM	2160LM @30K/90CRI	21W
Notes	Delivered lumens based on 25D optic with CL lens (see page 2)	

eldoLED
your wireless light driver



CASAMBI

FEATURES

- Seamless extrusion with painted finish for clean aesthetics
- Thermally optimized for longevity
- Superior 38.5° cut off angle
- 9° - 65° beam spread
- UGR < 5
- Multiple glare control options, bezel and finishes available
- Deep regress bezel in down only

DIMMING AND CONTROLS

- eldoLED flicker free 0-10V dimming to 1% and 0%
- eldoLED flicker free DALI dimming to 1% and 0%
- Lutron Hi-lumen 2-Wire (Triac and Eco System) dimming to 0.1% and 1%
- Leading & trailing edge (Triac/ELV) dimming to 1%
- Casambi bluetooth dimming to 1.0%
- Independent Uplight / Downlight Control

CONSTRUCTION

- Extruded aluminum housing
- Lexan™ (PC) Optimal connectivity for wireless control signal
- Machined aluminum canopy

LED

- 90 CRI: SDCM = 2-step MacAdam Ellipse, Lumen Maintenance: L₇₀ > 66,000 hrs
- 80 CRI: SDCM = 2-step MacAdam Ellipse, Lumen Maintenance: L₇₀ > 66,000 hrs

LISTING

- ULus Listed to UL1598 & UL2108; cUL Listed to CSA C22.2 #250.0
- Suitable for dry and damp locations
- 5 Year Limited warranty

ELECTRICAL

- 120V-277V, 120 only Triac / ELV
- Power factor ≥ 0.9
- 2kV driver input surge protection
- remote emergency test switch
- 7W 90min battery - Down only

12in BETA 6

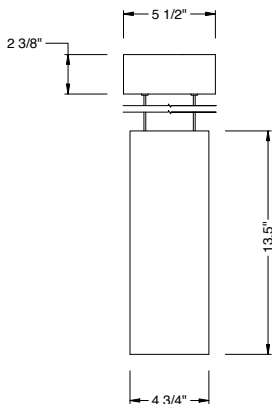

UPLIGHT / DOWNLIGHT

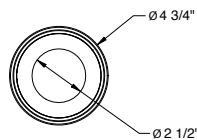

alphabet

PROJECT INFORMATION		
JOB NAME		TYPE
ORDERING CODE		

ORDERING CODE		
SERIES	BETA	cylinder series
TYPE	4RUDDR	4" Round Up Down - Deep Regress
LED	SW	standard white
DOWNLIGHT DELIVERED LUMENS	10LM	920 lm
	15LM	1340 lm
	20LM	1740 lm
	25LM	2120 lm
	30LM	2550 lm
	35LM	3050 lm
UPLIGHT DELIVERED LUMENS	10LM	990 lm
	15LM	1485 lm
	20LM	2095 lm
	25LM	2540 lm
CCT UP & DOWN	27K	2700K
	30K	3000K
	35K	3500K
	40K	4000K
CRI UP & DOWN	80	80 CRI
	90	90 CRI
DOWNLIGHT		
OPTIC & LM MULTIPLIER SEE PAGE 3, 4	9D¹	9.9 degrees (1.30)
	15D²	15 degrees (1.07)
	20D	20 degrees (0.99)
	25D	25 degrees (1.00)
	30D	30 degrees (1.00)
	50D	50 degrees (0.96)
BEZEL LENS SEE PAGE 3, 4	NL³	no lens (1.00)
	CL	clear lens (0.98)
	DL	diffused lens (0.91)
	HCL	honeycomb louver (0.85)
	HET	high efficiency textured lens, similar to Solite™ (0.96)
BEZEL COLOR SEE PAGE 3, 4	SBL	smoothing beam lens (0.96)
	BK	black (0.98)
	WH	white (1.00)
	MC	matte chrome (0.99)
	DC	dark chrome, vacuum metalized (0.95)
	GN	gun metal, vacuum metalized (0.99)
	SA	specular, vacuum metalized (1.00)
	CU	copper, vacuum metalized (0.97)
	AU	gold, vacuum metalized (0.98)
	CC⁴	custom color, consult factory for details
UPLIGHT		
OPTIC & LM MULTIPLIER SEE PAGE 3, 4	8D	8 degrees (1.00)
	12D	12 degrees (1.00)
	20D	20 degrees (0.99)
	25D	25 degrees (1.00)
	35D	35 degrees (0.99)
	50D	50 degrees (1.00)
BEZEL LENS SEE PAGE 3, 4	65D	65 degrees (0.99)
	CL	clear lens (0.98)
	DL	diffused lens (0.91)
	HCL	honeycomb louver (0.85)
	HET	high efficiency textured lens, similar to Solite™ (0.96)

ORDERING CODE		
FINISH	BK	black
	WH	white
	MC	matte chrome
	CC⁴	custom color, consult factory for details
MOUNTING OPTIONS	PS6	driver integrated canopy with power over suspension, 6ft
	PS8	driver integrated canopy with power over suspension, 8ft
	PS10	driver integrated canopy with power over suspension, 10ft
	PS12	driver integrated canopy with power over suspension, 12ft
VOLTAGE	120	120V
	UNV	120V-277V
DIMMING	DIM10	eldoLED flicker free 0-10V dimming to 1%
	DIM10Z	eldoLED flicker free 0-10V dimming to 0%
	DALI	eldoLED flicker free DALI 2 dimming to 1%
	DALIZ	eldoLED flicker free DALI 2 dimming to 0%
	LUTP⁵	Lutron Hi-lume Premier Ecosystem dimming to 0.1%, Soft-on & Fade-to-Black
	LUT⁵	Lutron Hi-lume Ecosystem dimming to 1%, Soft-on & Fade-to-Black
ELECTRICAL OPTIONS	ELV1⁶	leading & trailing edge (Triac/ELV) dimming to 1%
	CAS	Casambi Bluetooth control with flicker free 1% dimming
	EM7	Remote emergency battery backup, 90 minutes at 7 watts to LED, Remote TS

YOUR COMPLETED ORDERING CODE	
Follow the steps to specify your fixture, example:	
BETA - 4RUDDR - SW - 40LM - 20LM - 30K - 90 - 50D - CL - WH - 25D - CL - WH - PS6 - UNV - DIM10 - EM7	

NOTES

- 9D available in 10LM with NL/SBL lens options.
- 15D available in 10LM/15LM.
- NL option does not meet requirement for AT/DF/WET/NSF listings.
- Custom set up fee plus minimum quantity required per color.
- LUT/LUTP not available in 15D/20LM or 25LM/30LM/35LM/40LM.
- ELV1 (120V) not available in 10LM with 20D/25D/35D/50D optics.

* EIdoLED uses logarithmic dimming curve as standard. For linear dimming curve, add "LIN" after dimming code, i.e., DIM10LIN.

alphabet

PROJECT INFORMATION		
JOB NAME		TYPE
ORDERING CODE		

TRIM OPTIONS

TRIM/BEZEL COLORS

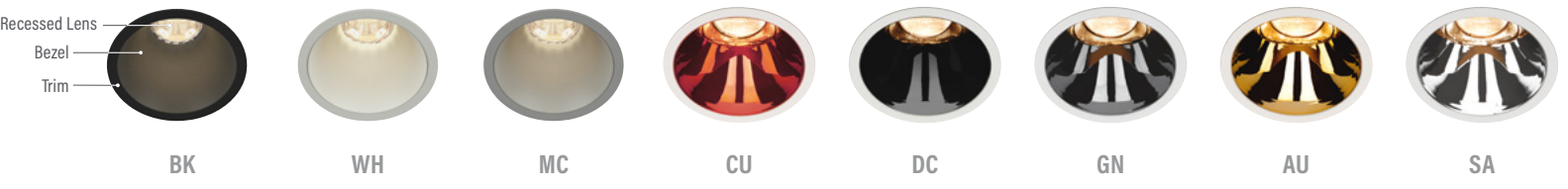

OPTICAL OPTIONS

- Calculations based on 15LM fixtures, SA bezel, unless otherwise noted
- UGR calculation based on CIE 117-1995; room size: 4H X 8H, reflectance: 70/50/20;



OPTIC	BEAM ANGLE	UGR
15D	13.4	≤5
25D	23.3	≤5
30D	29.5	≤5
50D	47	11.5



OPTIC	BEAM ANGLE	UGR
9D*	9.9	≤5
20D	18.7	≤5
25D	24.7	≤5
30D	31.8	≤5
50D	50.8	13.9

*UGR Calculation based on 10LM for 9D.



OPTIC	BEAM ANGLE	UGR
15D	35.4	10.1
30D	39.6	13.9
30D**	44.7	16.5
50D**	55	18.9

**WH (White Bezel)



OPTIC	BEAM ANGLE	UGR
15D	19	≤5
20D	23	≤5
25D	27.8	7
30D	32.2	8.2
50D	46.6	14.3



OPTIC	BEAM ANGLE	UGR
15D	14.2	≤5
20D	19.2	≤5
25D	25.2	≤5
30D	31.5	≤5
50D	50.4	13.7

GLARE CONTROL

CUT-OFF ANGLE

Visual comfort is achieved with a lower cut-off angle due to improved glare control. The smaller the cut-off angle, the easier it is on the eye.

Alphabet downlights have been thoughtfully engineered to eliminate glare while still delivering functional illumination.

- Cutoff angle is 38.5 degrees;

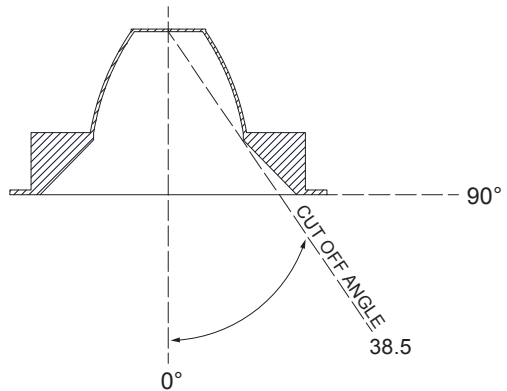

alphabet

PROJECT INFORMATION		
JOB NAME		TYPE
ORDERING CODE		

PHOTOMETRIC DATA

MULTIPLIERS		
	80CRI	90CRI
2700K	0.96	0.81
3000K	1	0.85
3500K	1.03	0.88
4000K	1.06	0.91
FC Formula = CBCP / Distance ²		

25LM-UP 40LM-DOWN	
50D 50° CLEAR LENS	
WATTS: 21	LPW: 114.2
LUMENS: 2398	CCT: 3000K
INTENSITY	
DEGREE	CANDELA
45	14
35	518
25	1830
15	2998
5	3716
0	3742
WATTS: 38.5	LPW: 77.9
LUMENS: 2999	CCT: 3000K
INTENSITY	
DEGREE	CANDELA
0	4678
5	4504
15	3849
25	2412
35	606
45	20

15LM-UP 30LM-DOWN	
50D 50° CLEAR LENS	
WATTS: 12.3	LPW: 114.4
LUMENS: 1407	CCT: 3000K
INTENSITY	
DEGREE	CANDELA
45	8
35	304
25	1074
15	1759
5	2180
0	2195
WATTS: 26.1	LPW: 85.8
LUMENS: 2239	CCT: 3000K
INTENSITY	
DEGREE	CANDELA
0	3492
5	3362
15	2873
25	1801
35	452
45	15

25LM-UP 25LM-DOWN	
50D 50° CLEAR LENS	
WATTS: 21	LPW: 114.2
LUMENS: 2398	CCT: 3000K
INTENSITY	
DEGREE	CANDELA
45	14
35	518
25	1830
15	2998
5	3716
0	3742
WATTS: 20.5	LPW: 90.6
LUMENS: 1857	CCT: 3000K
INTENSITY	
DEGREE	CANDELA
0	2897
5	2789
15	2383
25	1494
35	375
45	12

10LM-UP 25LM-DOWN	
50D 50° CLEAR LENS	
WATTS: 8.4	LPW: 111.3
LUMENS: 935	CCT: 3000K
INTENSITY	
DEGREE	CANDELA
45	6
35	202
25	713
15	1168
5	1448
0	1459
WATTS: 20.5	LPW: 90.6
LUMENS: 1857	CCT: 3000K
INTENSITY	
DEGREE	CANDELA
0	2897
5	2789
15	2383
25	1494
35	375
45	12

alphabet

PROJECT INFORMATION		
JOB NAME		TYPE
ORDERING CODE		

MOUNTING OPTIONS

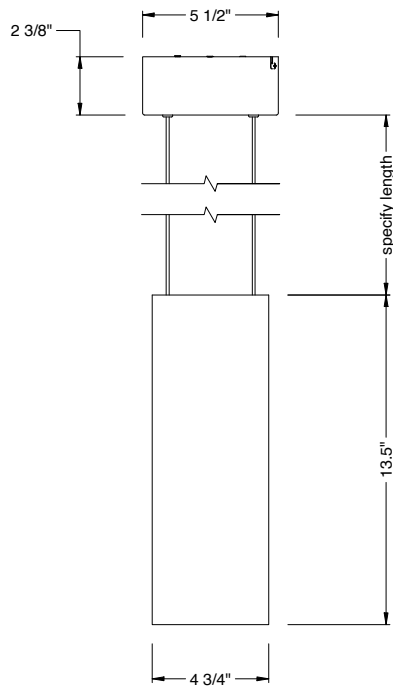

DIM10 / ELV1 / LUTP / DALI / CAS

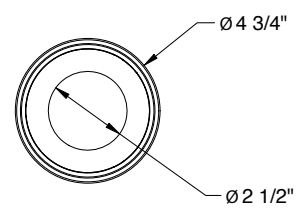

UPLIGHT / DOWNLIGHT

PROJECT INFORMATION		
JOB NAME		TYPE
ORDERING CODE		

BATTERY OPTIONS

EMERGENCY BATTERY

IOTA's ILB Battery Backups are UL Listed LED emergency drivers that allow the same LED fixture to be used for both normal and emergency operation. In the event of a power failure, the ILB switches to the emergency mode and operates the existing fixture for 90 minutes. The unit contains a battery, charger, and converter circuit in a single can. The Constant Power design of the ILB maintains the output wattage to the LED array even as the system voltage diminishes. UL 924 Listed for U.S. and Canada. UL 1310 Certified, Output Class 2 Compliant. Includes single-piece TBTS test switch and charge indicator accessory kit. For use with switched and unswitched fixtures, and includes Two-wire universal AC input. Meets or exceeds all National Electric Code and Life Safety Code Emergency Lighting Requirements. Rated for use in Plenum, Damp Location, Recessed Type IC, and Enclosed and Gasketed Luminaires.

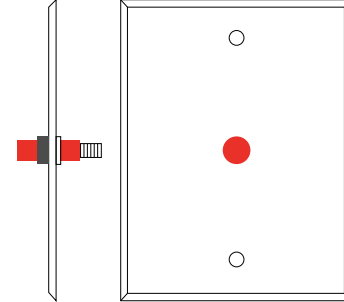

Test Button

EM MODE OUTPUT (DELIVERED LUMENS) - DOWNLIGHT ONLY	
LUMEN ORDERING CODE	EM7
ALL OPTIONS (10LM TO 40LM)	770LM
Notes: Based on 30K, 80CRI - Downlight only	

INTEGRATED EM BATTERY

