

PROJECT INFORMATION		
JOB NAME		TYPE
ORDERING CODE		

## ZETA

### Profile Linear System

CASAMBI

eldoLED  
your product | our drive



### ORDERING CODE

<b>SERIES</b>	ZETA-PLS	Zeta profile linear system
<b>TYPE</b>	NI	no insert
<b>SIZE</b>	2 4 8 CR-X	2' 4' 8' custom run - X (select length in feet)reference length table
<b>DIRECT/INDIRECT</b>	D ID03 <sup>2</sup> ID04 <sup>2</sup> ID05 <sup>2</sup>	direct only indirect output,256lm per foot, 3 watts indirect output,357lm per foot, 4 watts indirect output,495lm per foot, 5 watts
<b>DIMMING</b>	UNV-DIM10 <sup>1</sup> UNV-CAS <sup>1</sup>	120V-277V integrated driver, flicker free 0-10V dimming to 1% 120V-277V integrated driver and Bluetooth Casambi control, dimming to 1%
<b>MOUNTING OPTIONS</b>	P R S	pendant recessed surface mount
<b>FINISH</b>	WH BK	white black

### ORDERING CODE

Follow the steps to specify your fixture, example:  
ZETA - PLS - NI - 8 - D - UNV - DIM10 - P - WH

### NOTES

- All systems wired on single dimming unless indirect option selected. For independent insert control consult factory.
- Independent circuits for dual dimming control.

LENGTH CODE (NOMINAL FEET)	LENGTH (INCHES)	MAX DIRECT WATTAGE (W)	INDIRECT WATTAGE (W)	NUMBER OF SEGMENTS
2	23.875	50	N/A	1
4	47.5	100	18	1
6	71.125	150	18	2
8	94.75	200	36	1
10	118.375	250	36	2
12	142	250	54	2
16	189.25	300	72	2
24	236.75	350	108	3
32	283.75	400	144	3
40	472.75	450	180	5
48	567.25	500	216	6
56	661.625	600	252	7
64	756.125	650	288	8
72	850.625	700	324	9
80	945.125	750	360	10
88	1039.625	800	396	11
96	1134.125	850	432	12
100	1181.625	900	450	13

### FEATURES

- Discrete 1-7/8" profile designed for even illumination and low glare
- Power supply and lighting control fully integrated
- Full range of inserts available: Accent, General, Spot, and Wall Wash
- Beam options: Elliptical, Lambertian, 15° and 30°
- Up to 1530 lumens per foot (direct/indirect)
- 950 watts per power feed (52' with max output)
- UGR <10 or <22
- Multiple mounting and finish options available

### DIMMING AND CONTROLS

- Flicker free 0-10V dimming to 1%
- Casambi Bluetooth dimming to 1%

### CONSTRUCTION

- Extruded aluminum housing
- PMMA lens
- SVT power cord (pendant mounting)

### ELECTRICAL/CONTROLS

- 120V-277V
- Power factory ≥ 0.9
- 2kV driver input surge protection
- Remote and Integral (ITS) emergency test switch
- 10W EM 90min battery

### LISTING

- CSAus Listed to UL1598, cCSA listed to CSA C22.2 #250.0
- Suitable for dry locations only
- 5-year limited warranty

### LED INFO

- General Light & Uplight Pendant:
- SAMSUNG SMD LM218B+: 90 CRI: SDCM: 3-Step MacAdam Ellipse, Lumen Maintenance: L<sub>70</sub> 50,000 hrs

# alphabet

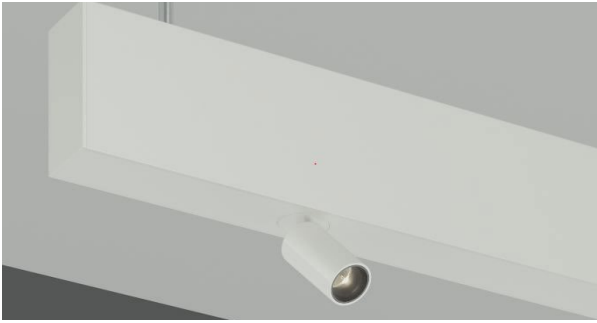

## LED INFO

Spot Light Insert:  
 - CREE XHP35: 90 CRI: SDCM: 3-step  
 MacAdam Ellipse, Lumen Maintenance: L<sub>70</sub> >  
 50,000 hrs

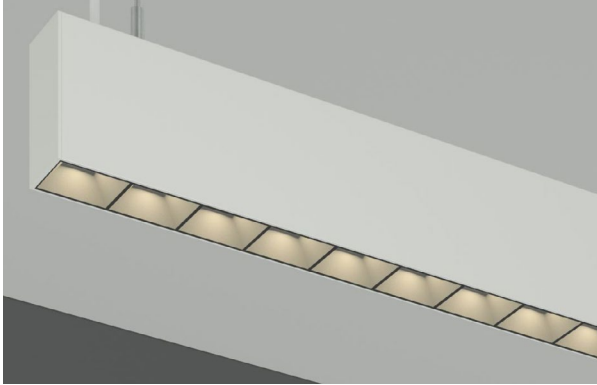
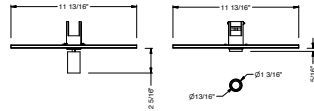

## LED INFO

Accent Light Insert:  
 - OSRAM GW-CSSRM2: 90 CRI: SDCM: 3-step MacAdam  
 Ellipse, Lumen Maintenance: L<sub>70</sub> > 50,000 hrs

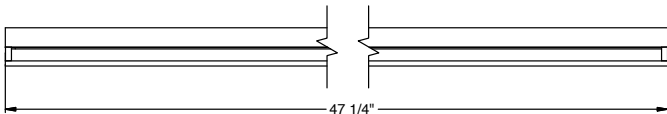
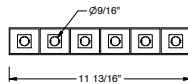

## LED INFO

Wall Wash Insert:  
 - SAMSUNG SMD LM218B+: 90 CRI: SDCM 3-Step MacAdam Ellipse, Lumen Maintenance: L<sub>70</sub> >  
 50,000 hrs

PROJECT INFORMATION		
JOB NAME		TYPE
ORDERING CODE		

## SPOT LIGHT INSERT ORDERING CODE

<b>SERIES</b>	<b>ZETA-PLS</b>	Zeta profile linear system
<b>TYPE</b>	<b>SL</b>	spot light insert, single
<b>LED</b>	<b>SW</b>	standard white
<b>DELIVERED LUMENS</b>	<b>04LM</b>	315lm, 6 watts Standard Configuration: 3000K, 30D
<b>CCT &amp; LM MULTIPLIER</b>	<b>30K 35K</b>	3000K (1.00) 3500K (1.08)
<b>CRI</b>	<b>90</b>	90 CRI
<b>LENS</b>	<b>15D 30D 55D</b>	15 degrees, CBCP 2,585 30 degrees, CBCP 1,095 55 degrees, CBCP 345
<b>FINISH</b>	<b>WH BK</b>	white black

### ORDERING CODE

Follow the steps to specify your fixture, example:  
**ZETA - PLS - SL - SW - 04LM - 30K - 90 - 15D - WH**

### SPOT LIGHT INSERT FOOT CANDLE CHART

MOUNTING DISTANCE	BEAM		
	15D	30D	55D
4'	57FC	45FC	20FC
8'	28FC	16FC	6FC

## ACCENT LIGHT INSERT ORDERING CODE

<b>SERIES</b>	<b>ZETA-PLS</b>	Zeta profile linear system
<b>TYPE</b>	<b>AL</b>	accent light insert
<b>LED</b>	<b>SW</b>	standard white
<b>DELIVERED LUMENS</b>	<b>06LM 08LM 10LM</b>	550lm/ft, 12 watts 740lm/ft, 9 watts 970lm/ft, 17 watts Standard Configuration: 3000K, 30D
<b>CCT &amp; LM MULTIPLIER</b>	<b>30K 35K</b>	3000K (1.00) 3500K (1.08)
<b>CRI</b>	<b>90</b>	90 CRI
<b>LENS</b>	<b>15D 30D E</b>	15 degrees (0.95) 30 degrees (1.00) elliptical beam spread, 35°x15° (.94)
<b>BEZEL COLOR</b>	<b>BK</b>	black

### ORDERING CODE

Follow the steps to specify your fixture, example:  
**ZETA - PLS - AL - SW - 10LM - 30K - 90 - 15D - BK**

## WALL WASH INSERT ORDERING CODE

<b>SERIES</b>	<b>ZETA-PLS</b>	Zeta profile linear system
<b>TYPE</b>	<b>WW</b>	wall wash insert
<b>LED</b>	<b>SW</b>	standard white
<b>DELIVERED LUMENS</b>	<b>03LM 05LM 06LM</b>	285lm/ft, 19 watts 405lm/ft, 27 watts 555lm/ft, 37 watts
<b>CCT &amp; LM MULTIPLIER</b>	<b>30K 35K</b>	3000K (1.00) 3500K (1.08)
<b>CRI</b>	<b>90</b>	90 CRI
<b>FINISH</b>	<b>SV</b>	silver

### ORDERING CODE

Follow the steps to specify your fixture, example:  
**ZETA - PLS - WW - SW - 05LM - 30K - 90 - SV**

# alphabet

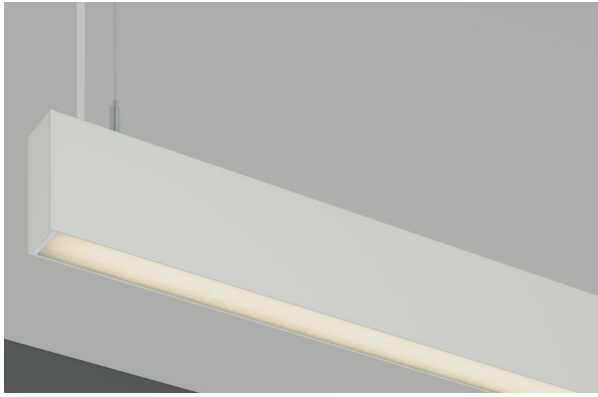

## LED INFO

General Light:  
 - SAMSUNG SMD LM218B+: 90 CRI: 3-step  
 MacAdam Ellipse, Lumen Maintenance: L70 >  
 50,000 hrs

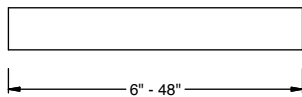
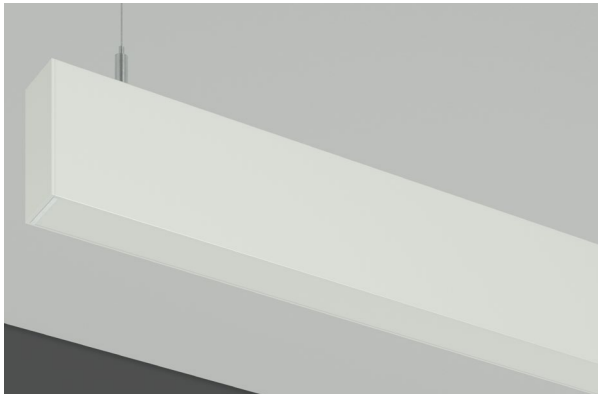
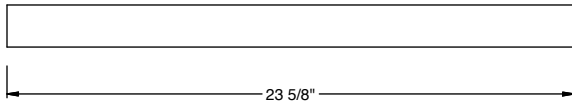

PROJECT INFORMATION		
JOB NAME		TYPE
ORDERING CODE		

## GENERAL LIGHT INSERT ORDERING CODE

SERIES	ZETA-PLS	Zeta profile linear system
TYPE	GL	general light insert
LED	SW	standard white
C DELIVERED LUMENS	04LM	436lm/ft, 5 watts
	06LM	817lm/ft, 7 watts
	08LM	845lm/ft, 10 watts
	10LM	1036lm/ft, 13 watts
		Standard Configuration: 3000K
CCT & LM MULTIPLIER	30K	3000K (1.00)
	35K	3500K (1.08)
CRI	90	90 CRI

### ORDERING CODE

Follow the steps to specify your fixture, example:  
**ZETA - PLS - GL - SW - 10LM - 30K - 90 - BK**

## BLANK COVER INSERT ORDERING CODE

SERIES	ZETA-PLS	Zeta profile linear system
TYPE	BC	blank cover
SIZE	6	6"
	12	12"
	24	24"
	36	36"
	48'	48"
FINISH	WH	white
	BK	black

### ORDERING CODE

Follow the steps to specify your fixture, example:  
**ZETA - PLS - BC - 12 - BK**

### NOTES

- For additional blank lengths consult factory.

# alphabet

PROJECT INFORMATION		
JOB NAME		TYPE
ORDERING CODE		

## ACCESSORIES

### Accessories Ordering Code

ZETA-PLS-LCON-30K-90-WH	L-Connector, 3000K, 90CRI, white
ZETA-PLS-LCON-30K-90-BK	L-Connector, 3000K, 90CRI, black
ZETA-PLS-LCON-35K-90-WH	L-Connector, 3500K, 90CRI, white
ZETA-PLS-LCON-35K-90-BK	L-Connector, 3500K, 90CRI, black
ZETA-PLS-LCON-BLANK-WH	L-Connector, blank, white
ZETA-PLS-LCON-BLANK-BK	L-Connector, blank, black
ZETA-PLS-SURFACE-KIT-WH <sup>1</sup>	Surface mount kit with J-box cover, white
ZETA-PLS-SURFACE-KIT-BK <sup>1</sup>	Surface mount kit with J-box cover, black
ZETA-PLS-SURFACE-CLAMP <sup>1</sup>	Surface mount clamp, 2 pcs.
ZETA-PLS-SUSPENSION-KIT <sup>1</sup>	Suspension mount with cable, 2 pcs.
ZETA-PLS-RECESSED-KIT <sup>1</sup>	Recessed mount mud up brackets, 2 pcs.

### NOTES

1. Mounting accessories are only for additional or spare circumstances. All systems include adequate quantity of mounting components.

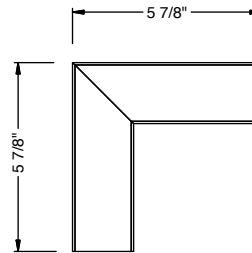

# alphabet

PROJECT INFORMATION		
JOB NAME		TYPE
ORDERING CODE		

## MOUNTING OPTIONS

### PENDANT

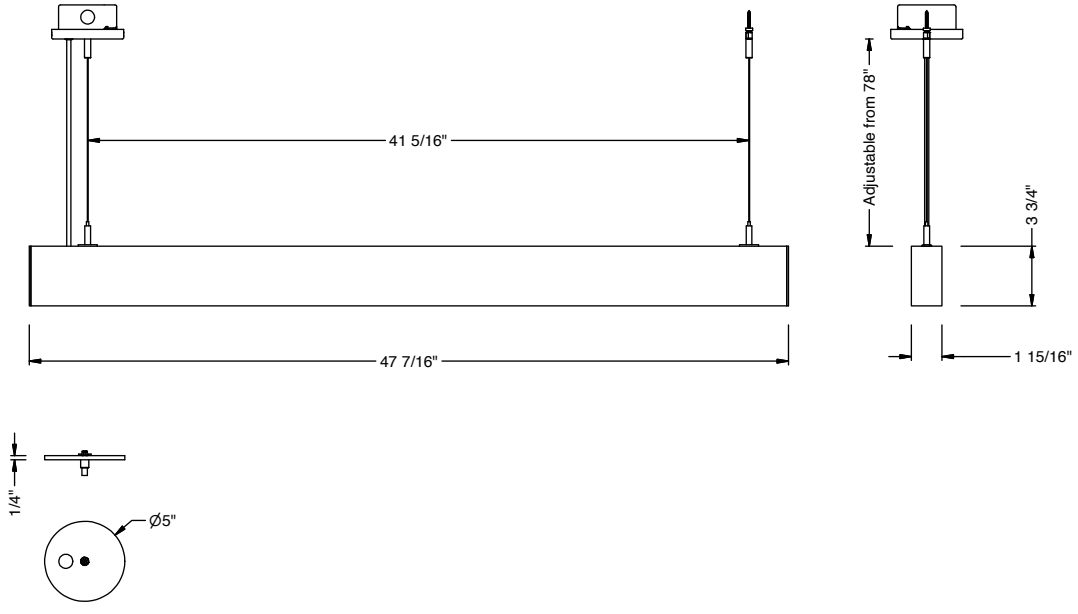

### SURFACE

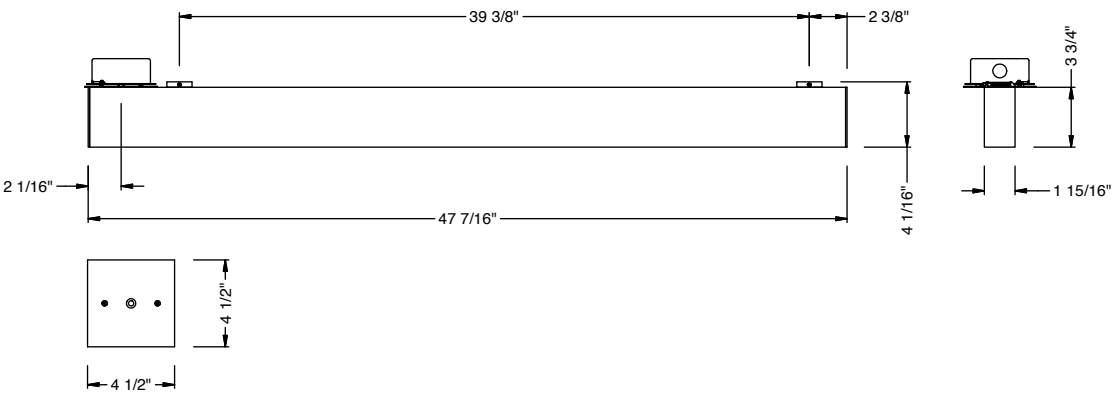

### RECESSED

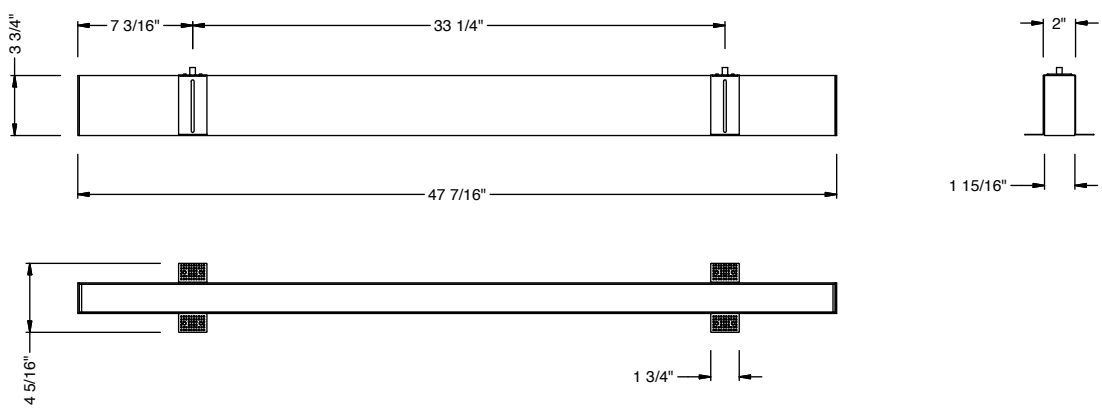

PROJECT INFORMATION		
JOB NAME		TYPE
ORDERING CODE		

## INSERT SPACING GUIDE - CONTINUOUS RUN INSERTS

NOTE: Continuous inserts can be joined end to end without blanks.  
Consult factory for custom placement, spacing and quantities.  
Blank covers can be used instead of inserts, MUST PROVIDE DRAWING

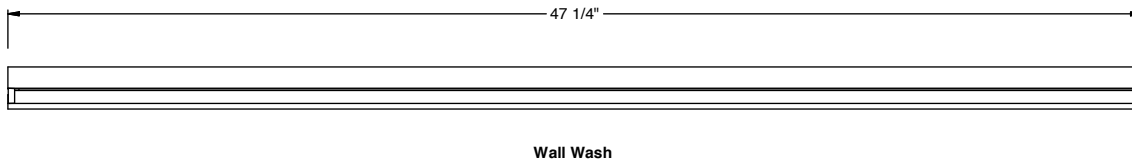
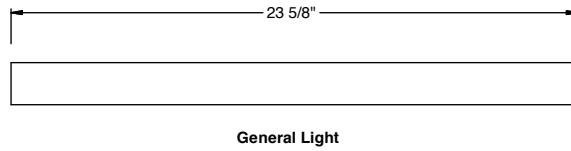
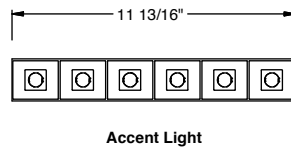
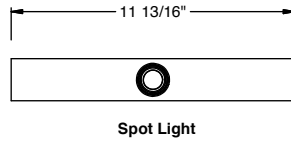

PROJECT INFORMATION		
JOB NAME		TYPE
ORDERING CODE		

## INSERT SPACING GUIDE - CONTINUOUS RUN INSERTS

Examples:

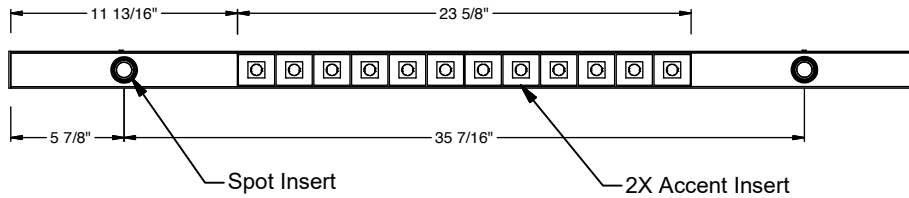
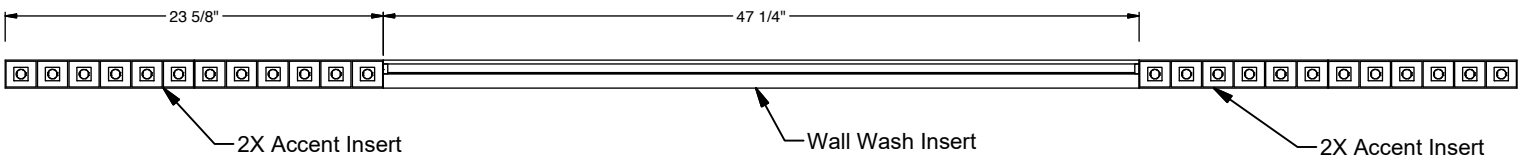
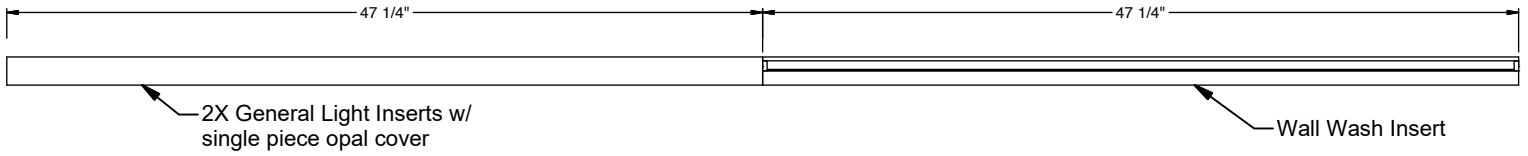

NOTE: 4 foot nominal length minimum required to place spot light insert, placement will be at either end of profile. For continuous runs greater than 4 feet nominal, spot light Inserts are placed every 24" (23 5/8) minimum. Consult factory for alternative spacing or placement. Blank cover can be requested between spot light inserts,

# alphabet

PROJECT INFORMATION		
JOB NAME		TYPE
ORDERING CODE		

## DESIGN GUIDE - SQUARE MIX

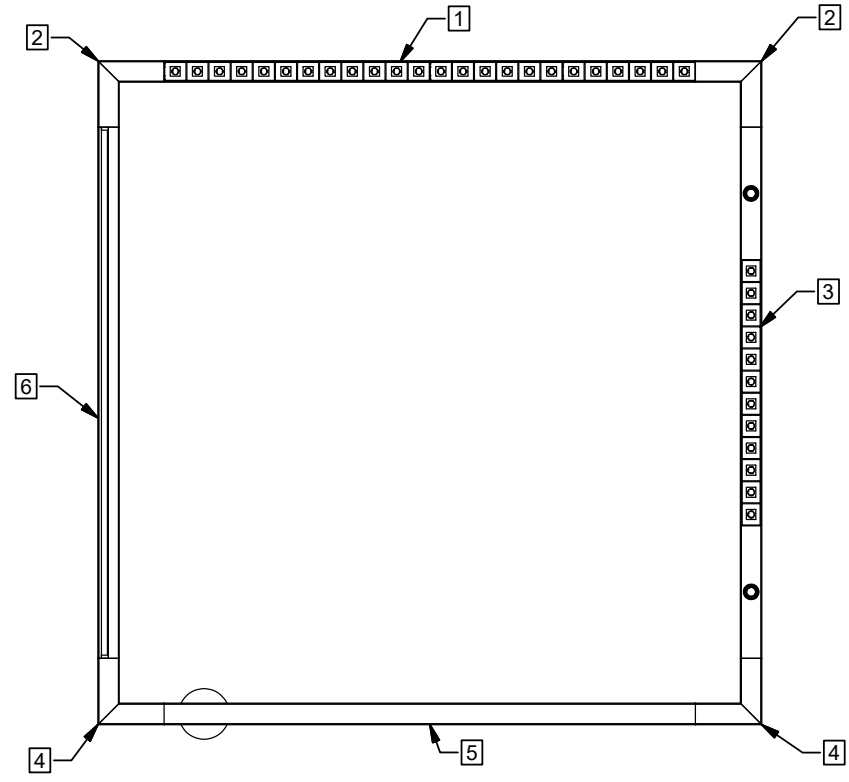

- 1) ZETA-PLS-NI-4-D-UNV-DIM10-P-BK  
a) 4X ZETA-PLS-AL-SW-10LM-30K-90-30D-BK (Profile, 4ft)  
          (4X Accent Insert)
- 2) ZETA-PLS-LCON-BLANK-BK (L-Connector, Black)
- 3) ZETA-PLS-NI-4-D-UNV-DIM10-P-BK (Profile 4ft)  
a) 2X ZETA-PLS-SL-SW-04LM-30K-90-15D-BK (Spot Light Insert)  
b) 2X ZETA-PLS-AL-SW-10LM-30K-90-30D-BK (Accent Light)
- 4) ZETA-PLS-LCON-30K-90-BK (General Light L-Connector)
- 5) ZETA-PLS-NI-4-D-UNV-DIM10-P-BK (Profile, 4ft)  
a) 2X ZETA-PLS-GL-SW-10LM-30K-90 (General Light Insert)
- 6) ZETA-PLS-NI-4-D-UNV-DIM10-P-BK (Profile, 4ft)  
a) ZETA-PLS-WW-4-SW-06LM-30K-90-SV (Wall Wash Insert)

