

alphabet

PROJECT INFORMATION		
JOB NAME		TYPE
ORDERING CODE		

BETA

4" Square Warm Dim

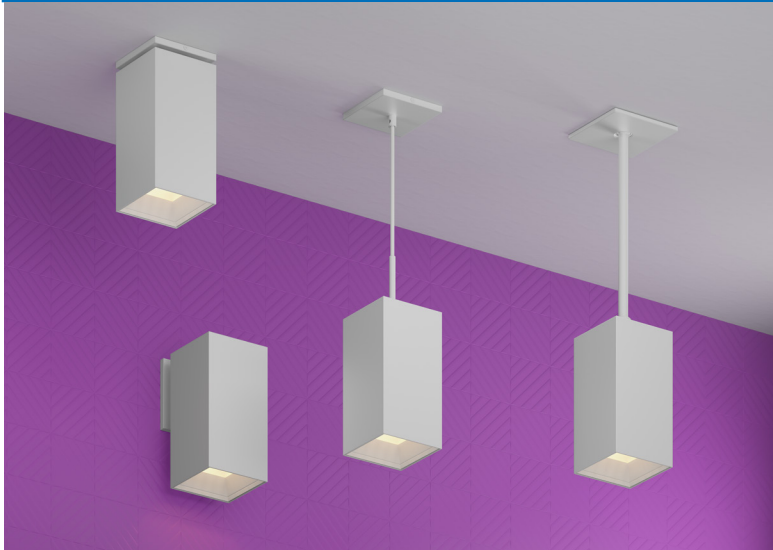

65° - 85° BEAM		
(Note: Specifications are subject to change without notice)		
18mm DYNAMIC COB PERFORMANCE DATA		
LED LIGHT ENGINE	NOMINAL DELIVERED LUMENS	SYSTEM WATTAGE
10LM	760LM @30K/97CRI	14W
15LM	1450LM @30K/97CRI	26W
20LM	1690LM @30K/97CRI	30W
25LM	2130LM @30K/97CRI	38W
Notes	Delivered lumens based on WH85, 3000K (see page 2)	



FEATURES

- Seamless extrusion with powder coated finish for clean aesthetics
- Thermally optimized for longevity
- 65° - 85° beam spread
- UGR < 19
- Micro slim canopy option at 1/4"-3/8" depth plus 1/2" diameter stem.
- Multiple mounting, glare control options, trims and finishes available

DIMMING AND CONTROLS

- Flicker free 0-10V dimming to 1%
- Leading & trailing edge (Triac/ELV) dimming to 1%
- Lutron Hi-lume premier ecosystem dimming to 1%
- Casambi bluetooth dimming to 1%

CONSTRUCTION

- Extruded aluminum housing
- Lexan™ (PC) Optimal connectivity for wireless control signal
- Machined aluminum canopy
- SVT pendant cord

LED

- Luminus Dim-to-warm COB:
- 97 CRI: SDCM = 3-step MacAdam Ellipse; Lumen Maintenance: L₇₀ > 54,000 hrs
- Dim to Warm from 3000K - 1800K.

LISTING

- ULus Listed to UL1598 & UL2108; cUL Listed to CSA C22.2 #250.0
- Suitable for dry and damp locations
- 5 Year Limited warranty

ELECTRICAL

- 120V-277V, 120 only Triac / ELV
- Power factory ≥ 0.9
- 2kV driver input surge protection
- Remote emergency test switch
- 7 W, 10W (T20 CEC) and 12W EM 90min battery

PENDANT

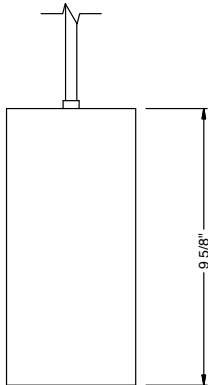

SURFACE MOUNT

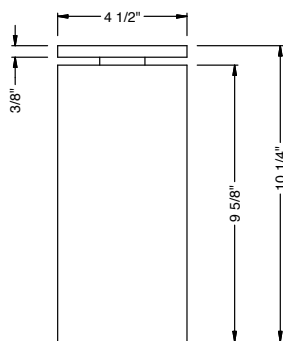

WALL MOUNT

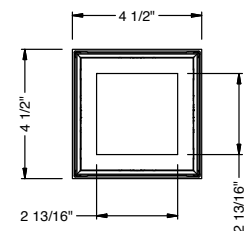
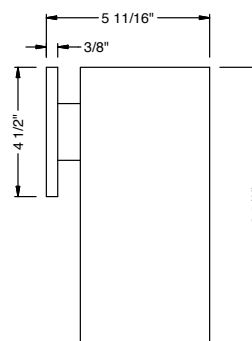

alphabet

PROJECT INFORMATION		
JOB NAME		TYPE
ORDERING CODE		

ORDERING CODE						
SERIES	BETA	BETA				
TYPE	4Q	4" square				
LED	WD	warm dim (Luminus)				
DELIVERED LUMENS	10LM	760 lm				
	15LM	1450 lm				
	20LM	1690 lm				
	25LM	2130 lm				
	Standard Configuration: 3500K WH85 Calculated Delivered Lumens = [Delivered Lumen Value] x [CCT Multiplier] x [Reflector Multiplier]					
CCT	3018	3000K, dim to 1800K				
			CCT AT LIGHT LEVEL (%LF)			
			%LF	20LM	15LM	10LM
			100%	3000	3000	3000
	50%	3000	3000	2800		
	25%	2800	2500	2300		
	10%	2200	2000	1900		
	5%	1800	1800	1800		
CRI	97	97 CRI				
OPTIC & LM MULTIPLIER	HE65	65° high efficiency diffused lens	(0.89)			
	HE75	75° high efficiency diffused lens	(0.87)			
	HE85	85° high efficiency diffused lens	(0.95)			
	D70	70° diffused with clear lens	(0.91)			
	WH85	85° brilliant white with clear lens	(1.00)			
FINISH	BK	black				
	WH	white				
	MC	matte chrome				
BEZEL COLOR	BK	black	(0.98)			
	WH	white	(1.00)			
	MC	matte chrome	(0.99)			
	BZ	bronze	(0.98)			
	WT	wheat	(0.99)			

ORDERING CODE		
MOUNTING OPTIONS SEE PAGE 4	W	wall mount
	S	surface mount
	P ¹	pendant, 108" flexible cord
	RP	rigid pendant 4' stem with swivel stem/canopy
	RP5	rigid pendant 5' stem with swivel stem/canopy
	RP6	rigid pendant 6' stem with swivel stem/canopy
	RP8	rigid pendant 8' stem with swivel stem/canopy
	RP10	rigid pendant 10' stem with swivel stem/canopy
	RPF2	rigid pendant 2' with fixed stem/canopy
	RPF3	rigid pendant 3' with fixed stem/canopy
	RPF4	rigid pendant 4' with fixed stem/canopy
RPF6	rigid pendant 6' with fixed stem/canopy	
JCOV-XX ²	conduit junction box cover with knockouts, complete XX code with desired pendant mount	
VOLTAGE	120	120V
	UNV	120V-277V
DIMMING	DIM10	0-10V dimming to 1%
	LUTP ³	Lutron Hi-lume Premier Ecosystem dimming to 0.1%, Soft-on & Fade-to-Black
	ELVI ⁴	leading & trailing edge (Triac/ELV) dimming to 1%
	CAS	Casambi Bluetooth control with flicker free 1% dimming
ELECTRICAL OPTIONS SEE PAGE 5	EM7	remote emergency battery backup, 90 minutes at 7 watts to LED
	EM12	remote emergency battery backup, 90 minutes at 12 watts to LED
	EM10CA20	remote emergency battery backup, 90 minutes at 10W to LED, CA title 20

YOUR COMPLETED ORDERING CODE
Follow the steps to specify your fixture, example:
BETA - 4Q - WD - 15LM - 3018 - 97 - WH85 - WH - WH - P - UNV - DIM10 - EM7

NOTES

1. Canopy type: Slim square - ELVI/CAS, Deep round - DIM10/LUTP.
2. JCOV available with round canopy. Not available in RP.
3. LUTP not available in 20LM/25LM.
4. ELVI available in 120V.

*Warm Dim CCT values at X% are for reference. Actual CCT may vary.

*Slim canopy with rigid stem connection shall be used in jurisdictions that DO NOT require light fixtures to freely swing in lateral directions, complying with local and national building codes.

*RP mounting with swivel is recommended to be installed on a 4in square or 4in deep regress 2-1/8" octagonal junction box.

BEZEL OPTIONS

BEZEL COLORS



alphabet

PROJECT INFORMATION		
JOB NAME		TYPE
ORDERING CODE		

PHOTOMETRIC DATA

15LM CCT MULTIPLIERS

	80CRI	90CRI
2700K	0.96	0.81
3000K	1	0.85
3500K	1.03	0.88
4000K	1.06	0.91

FC Formula = CBCP / Distance²

D70 70° DIFFUSED WITH CLEAR LENS

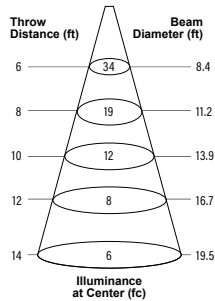

WATTS: 25.9 LPW: 53.3

LUMENS: 1381 CCT: 3000K

INTENSITY

DEGREE	CANDELA
0	1214
5	1199
15	1080
25	866
35	603
45	133

HE65 68° HIGH EFFICIENCY DIFFUSED LENS

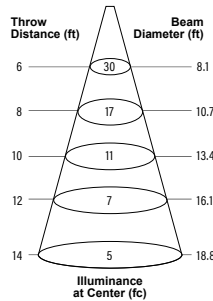

WATTS: 25.9 LPW: 53.4

LUMENS: 1382 CCT: 3000K

INTENSITY

DEGREE	CANDELA
0	1068
5	1051
15	928
25	731
35	507
45	255

HE85 86° HIGH EFFICIENCY DIFFUSED LENS

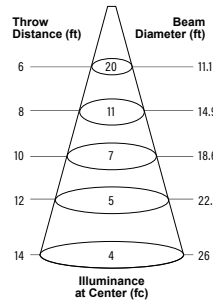

WATTS: 25.9 LPW: 52.4

LUMENS: 1357 CCT: 3000K

INTENSITY

DEGREE	CANDELA
0	725
5	721
15	687
25	618
35	505
45	318

WH85 81° BRILLIANT WHITE WITH CLEAR LENS

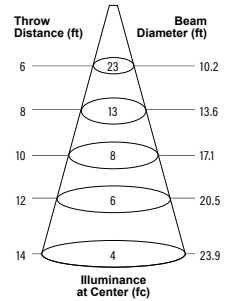

WATTS: 25.9 LPW: 55.9

LUMENS: 1448 CCT: 3000K

INTENSITY

DEGREE	CANDELA
0	815
5	814
15	801
25	753
35	657
45	244

25LM CCT MULTIPLIERS

	80CRI	90CRI
2700K	0.96	0.81
3000K	1	0.85
3500K	1.03	0.88
4000K	1.06	0.91

FC Formula = CBCP / Distance²

D70 70° DIFFUSED WITH CLEAR LENS

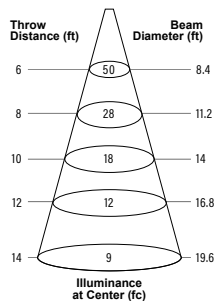

WATTS: 37.4 LPW: 54.8

LUMENS: 2050 CCT: 3000K

INTENSITY

DEGREE	CANDELA
0	1787
5	1766
15	1591
25	1279
35	890
45	196

HE65 68° HIGH EFFICIENCY DIFFUSED LENS

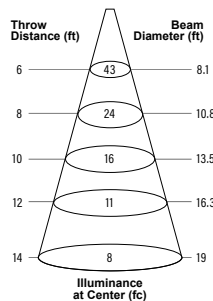

WATTS: 37.4 LPW: 54.7

LUMENS: 2044 CCT: 3000K

INTENSITY

DEGREE	CANDELA
0	1565
5	1541
15	1364
25	1082
35	750
45	379

HE85 86° HIGH EFFICIENCY DIFFUSED LENS

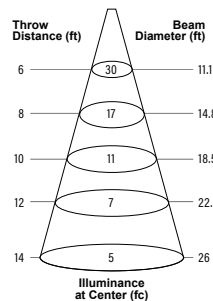

WATTS: 37.4 LPW: 53.4

LUMENS: 1998 CCT: 3000K

INTENSITY

DEGREE	CANDELA
0	1067
5	1061
15	1011
25	910
35	742
45	467

WH85 81° BRILLIANT WHITE WITH CLEAR LENS

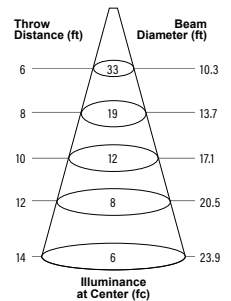

WATTS: 37.4 LPW: 56.8

LUMENS: 2125 CCT: 3000K

INTENSITY

DEGREE	CANDELA
0	1195
5	1194
15	1174
25	1105
35	958
45	361

alphabet

PROJECT INFORMATION		
JOB NAME		TYPE
ORDERING CODE		

MOUNTING OPTIONS

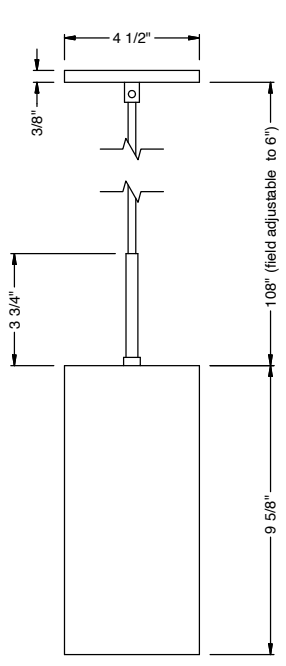

PENDANT
ELV1 / CAS

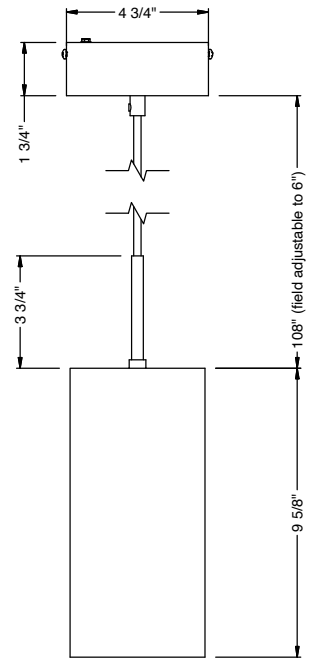

PENDANT
DIM10 / LUTP

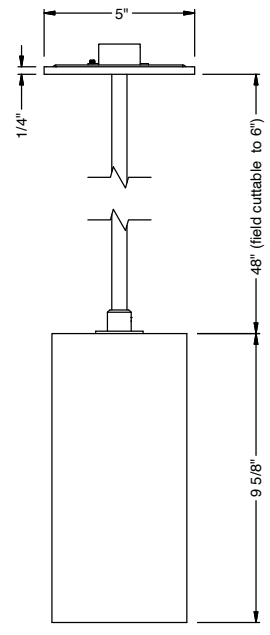

RP SWIVEL
DIM10 / ELV1 / LUTP

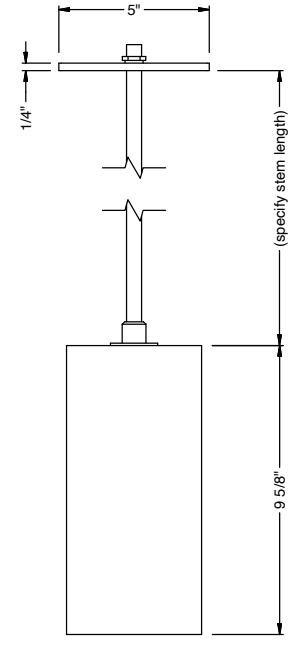

RPF FIXED
DIM10 / ELV1 / LUTP

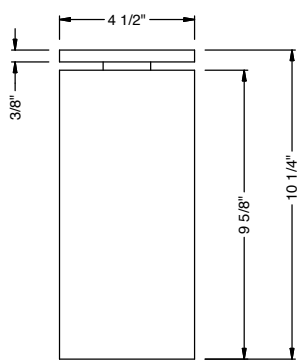
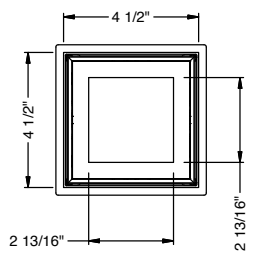

SURFACE MOUNT
DIM10 / ELV1 / LUTP

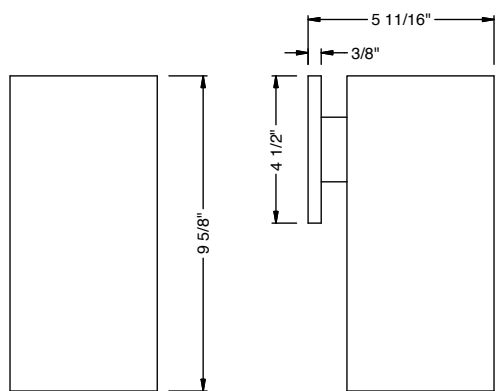

WALL MOUNT
DIM10 / ELV1 / LUTP

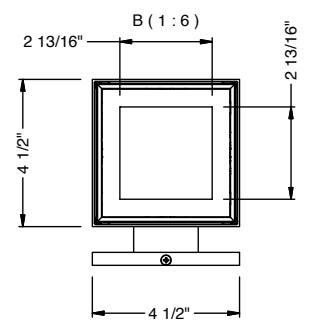

PROJECT INFORMATION		
JOB NAME		TYPE
ORDERING CODE		

PHOTOMETRIC DATA

EMERGENCY BATTERY

IOTA's ILB battery backups are UL Listed LED emergency drivers that allow the same LED fixture to be used for both normal and emergency operation. In the event of a power failure, the ILB switches to the emergency mode and operates the existing fixture for 90 minutes. The unit contains a battery, charger, and converter circuit in a single can. The constant power design of the ILB maintains the output wattage to the LED array even as the system voltage diminishes. UL 924 Listed for U.S. and Canada. UL 1310 Certified, output class 2 compliant. Includes single-piece TBTS test switch and charge indicator accessory kit. For use with switched and unswitched fixtures, and includes two-wire universal AC input. Meets or exceeds all National Electric Code and Life Safety Code Emergency Lighting requirements. Rated for use in plenum, damp location, recessed type IC, and enclosed and gasketed luminaires.

REMOTE TEST SWITCH

The remote test switch may be mounted adjacent to the LED Fixture by others.

EMERGENCY BATTERY ACCESS

Above ceiling access is recommended for ease of service.

REMOTE LOCATION

Maximum remote mounting distance of the emergency driver shall be 50 feet. Remote location wiring provided by others. Follow all local and national electric/building codes.

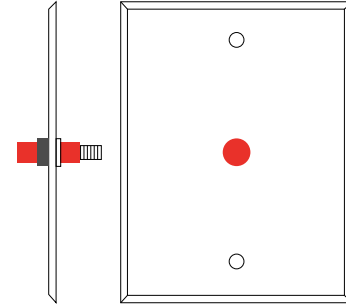

Remote Test Switch

EM MODE OUTPUT (DELIVERED LUMENS)			
LUMEN ORDERING CODE	EM7	EM10	EM12
ALL OPTIONS (10LM TO 25LM)	500LM	650LM	750LM
Notes: Based on 30K, 97CRI			

REMOTE BATTERY

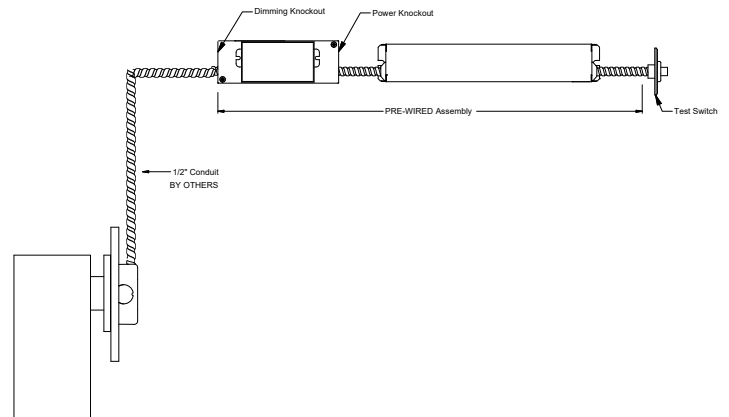
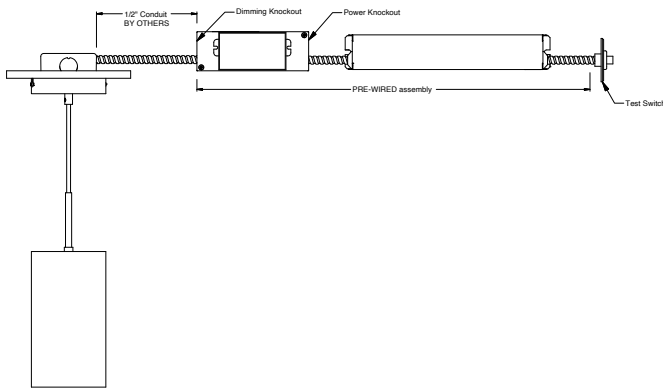

Accessory

76066 Optional T-Grid Mounting Kit¹

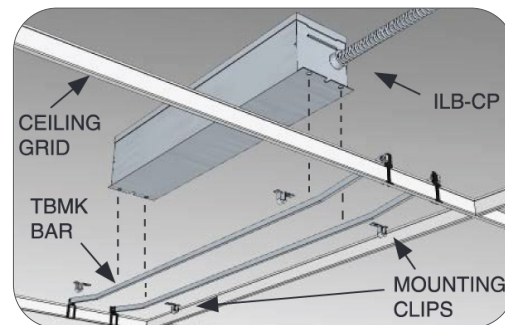

1. Can be used with any of the Emergency Battery Backups. Must be ordered as a separate line item.