

alphabet

| PROJECT INFORMATION | | |
|---------------------|--|------|
| JOB NAME | | TYPE |
| ORDERING CODE | | |

NU4 LOPRO

4" Round Downlight Warm Dim



AT
airtight

DF
dead-front

PR
plenum rated

WET
wet rated

| 25° - 80° BEAM (Note: Specifications are subject to change without notice) | | |
|---|---|----------------|
| 14mm COB PERFORMANCE DATA | | |
| LED LIGHT ENGINE | NOMINAL DELIVERED LUMENS | SYSTEM WATTAGE |
| 10LM | 800LM @30K/97CRI | 13W |
| 13LM | 1040LM @30K/97CRI | 17W |
| 20LM | 1600LM @30K/97CRI | 27W |
| 30LM | 2400LM @30K/97CRI | 40W |
| Notes | Delivered lumens based on HE40 optic (see page 2) | |

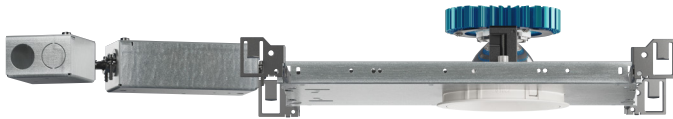

Trim

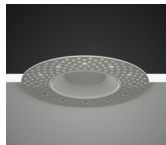

Trimless



Trimless Millwork

FEATURES

- Thermally optimized for LED longevity
- Double jointed driver box allows for 4" shallow plenum installation
- 3/4" bezel regress with 1/16" micro flange
- 25° - 80° optical beam control
- UGR < 15
- Multiple mounting, glare control options, trims, and finishes available

DIMMING AND CONTROLS

- 0-10V dimming to 1%
- leading & trailing edge (Triac / ELV) dimming to 1%

CONSTRUCTION

- Shatter proof acrylic bezel lens
- Lexan™ (PC) Optimal connectivity for wireless control signal
- Impact and chemical resistant at the highest level
- Withstands temperatures up to 240°F
- Electrocoated 16-gauge cold-rolled steel construction
- Accommodates ceiling thickness from 1/8" to 1-5/8"

LED

- Luminus Dim-to-warm COB:
- 97 CRI: SDCM = 3-step MacAdam Ellipse; Lumen Maintenance: $L_{70} > 54,000$ hrs

LISTING

- ULus Listed to UL1598 & UL2108; cUL Listed to CSA C22.2 #250.0
- IP65 with lens - Suitable for wet locations with lens - Suitable for damp locations without lens
- Non-conductive, dead-front construction (shower approved)
- Made in the USA - meets the requirements of the Buy American provision within the ARRA
- NSF/ANSI-2 with lens (Non-Food and Splash Zones)
- 5 Year Limited warranty

ELECTRICAL

- 120V-277V, 120 only Triac / ELV
- Power factor ≥ 0.9
- 2kV driver input surge protection
- Remote and Integral (ITS) emergency test switch
- 7W, 10W (T20 CEC) and 12W EM 90min battery
- Max. ambient installation temperature 95°F (35°C)

FIXTURE HEIGHT

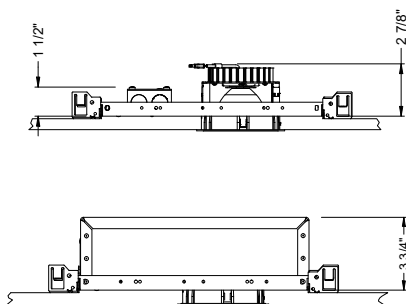

TRIMMED



ceiling cutout
4-3/8" diameter
ceiling thickness
1/8" to 1-5/8"

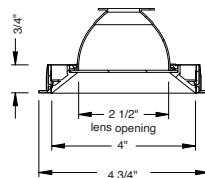

aperture dimensions

TRIMLESS

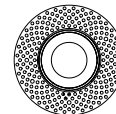

ceiling cutout
4-1/2" diameter
ceiling thickness
3/8" to 1-3/4"

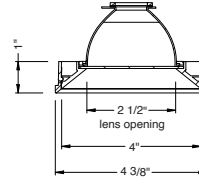

aperture dimensions

MILLWORK



ceiling cutout
4-3/8" diameter
ceiling thickness
1/2" to 1-3/4"

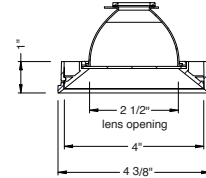

aperture dimensions

alphabet

| PROJECT INFORMATION | | |
|---------------------|--|------|
| JOB NAME | | TYPE |
| ORDERING CODE | | |

25°- 80° BEAM ORDERING CODE

| SERIES | NU4 | NU4 | | | | | | | |
|---|-------------------|---|--------|-------|-------|-------|------|------|------|
| TYPE | RDLP | round downlight lopro | | | | | | | |
| | RDTLP | round downlight trimless lopro | | | | | | | |
| | RDTMWLP | round downlight trimless millwork lopro | | | | | | | |
| LED | WD | warm dim (Luminus) | | | | | | | |
| DELIVERED LUMENS | 10LM | 800 lm | | | | | | | |
| | 13LM | 1040 lm | | | | | | | |
| | 20LM | 1600 lm | | | | | | | |
| | 30LM | 2400 lm | | | | | | | |
| Standard Configuration: 3000K 97CRI HE55 Calculated Delivered Lumens = [Delivered Lumen Value] x [CCT Multiplier] x [Optic Multiplier] x [Lens Multiplier] | | | | | | | | | |
| CCT | 3018 | 3000K, dim to 1800K | | | | | | | |
| | | CCT | 2700K | 3000K | 3500K | 4000K | | | |
| | | CRI | 80+ | 90+ | 80+ | 90+ | 80+ | 90+ | 80+ |
| CCT MULTIPLIER FOR LUMEN OUTPUT | | 0.96 | 0.81 | 1.00 | 0.85 | 1.03 | 0.88 | 1.06 | 0.91 |
| CRI | 97 | 97 CRI | | | | | | | |
| OPTIC & LM MULTIPLIER SEE PAGE 3 | HE80 | 80° high efficiency diffused lens | (0.91) | | | | | | |
| | HE55 | 55° high efficiency diffused lens | (0.99) | | | | | | |
| | HE40 | 40° high efficiency diffused lens | (0.99) | | | | | | |
| | SS60 | 60° semi-specular with clear lens | (0.97) | | | | | | |
| | SS40 | 40° semi-specular with clear lens | (0.85) | | | | | | |
| | SS25 | 25° semi-specular with clear lens | (0.95) | | | | | | |
| | D40 | 40° diffused with clear lens | (0.89) | | | | | | |
| | D60 | 60° diffused with clear lens | (0.93) | | | | | | |
| | WH80 | 80° brilliant white with clear lens | (0.93) | | | | | | |
| ACCESSORY SEE PAGE 3 | HCL ¹ | honeycomb louver | (0.90) | | | | | | |
| | Attached to bezel | | | | | | | | |
| TRIM COLOR SEE PAGE 3 | BK | black | | | | | | | |
| | WH | white | | | | | | | |
| | MC | matte chrome | | | | | | | |
| | BZ | bronze | | | | | | | |
| | WT | wheat | | | | | | | |
| Not applicable to trimless option. Do not include in trimless ordering code. | | | | | | | | | |
| BEZEL COLOR SEE PAGE 3 | BK | black | (0.98) | | | | | | |
| | WH | white | (1.00) | | | | | | |
| | MC | matte chrome | (0.99) | | | | | | |
| | BZ | bronze | (0.98) | | | | | | |
| | WT | wheat | (0.99) | | | | | | |

25°- 80° BEAM ORDERING CODE

| MOUNTING OPTIONS SEE PAGE 5, 6 | NC | new construction with ceiling fitting plate |
|-----------------------------------|-------------------|--|
| | IC ² | insulation contact housing |
| | RET | retrofit, no ceiling fitting plate |
| VOLTAGE | 120 | 120V |
| | UNV | 120V-277V |
| DIMMING | DIM10 | standard 0-10V dimming to 1% |
| | ELV1 ³ | leading & trailing edge (Triac/ELV) dimming to 1% |
| ELECTRICAL OPTIONS | EM7 | emergency battery backup, 90 minutes at 7W to LED |
| | EM12 | emergency battery backup, 90 minutes at 12W to LED |
| | EM10CA20 | remote emergency battery backup, 90 minutes at 10W to LED, CA title 20 |

ADDITIONAL MOUNTING INFO

| | |
|---|--|
| New Construction Bar Hangers (included) | Mounting Length: 14-3/4" to 26" |
| Extension Kit p/n: K20266 (ordered separately, 1 per fixture) | Extends a pair of Bar Hangers Total Mounting Length: 29" to 48" |

YOUR COMPLETED ORDERING CODE

| |
|---|
| Follow the steps to specify your fixture, example: |
| NU4 - RDLP - WD - 13LM - 3018 - 97 - HE55 - WH - WH - NC - UNV - DIM10 - EM7 |

NOTES

- HCL not available with lens. Multiplier: Delivered Lumens (0.78) / Beam Spread (0.80).
- IC not available for 30LM.
- ELV1 dimming available in 120V.

*Values shown are for reference only. Actual CCT may vary.

alphabet

| PROJECT INFORMATION | | |
|---------------------|--|------|
| JOB NAME | | TYPE |
| ORDERING CODE | | |

TRIM OPTIONS

TRIM/BEZEL COLORS



OPTICAL OPTIONS

- UGR calculation based on CIE 117-1995; room size: 4H X 8H, reflectance: 70/50/20;
- UGR calculation based on 15LM fixtures, unless otherwise noted.

CL

Clear Lens



| OPTIC | BEAM ANGLE | UGR |
|-------|------------|------|
| SS25 | 25 | 14 |
| SS40 | 41 | 16.2 |
| SS60 | 54.6 | 16.7 |
| D40 | 38.4 | 15.8 |
| D60 | 60.2 | 17.7 |
| WH80 | 72 | 24.4 |

HET

High Efficiency Textured Lens



| OPTIC | BEAM ANGLE | UGR |
|-------|------------|------|
| HE40 | 39.6 | 19.1 |
| HE55 | 55 | 20.3 |

GLARE CONTROL

CUT-OFF ANGLE

Visual comfort is achieved with a lower cut-off angle due to improved glare control. The smaller the cut-off angle, the easier it is on the eye.

Alphabet downlights have been thoughtfully engineered to eliminate glare while still delivering functional illumination.

- Cutoff angle of CL is 35 degrees;

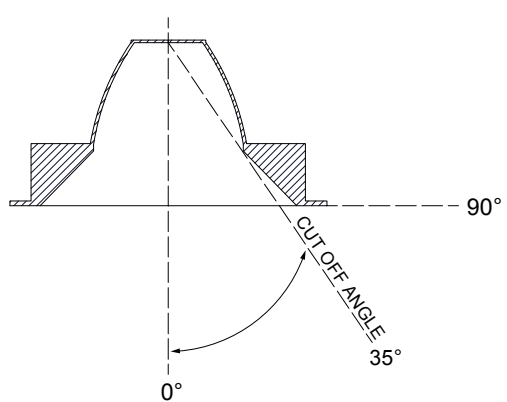

alphabet

| PROJECT INFORMATION | | |
|---------------------|--|------|
| JOB NAME | | TYPE |
| ORDERING CODE | | |

PHOTOMETRIC DATA

SS25
25° SEMI-SPECULAR WITH CLEAR LENS

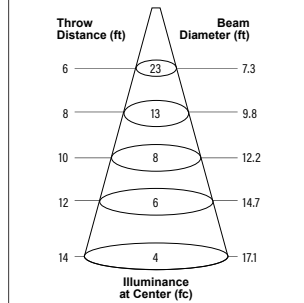

| WATTS: 17 | LPW: 59.7 |
|--------------|------------|
| LUMENS: 1015 | CCT: 3000K |
| INTENSITY | |
| DEGREE | CANDELA |
| 0 | 817 |
| 5 | 802 |
| 15 | 698 |
| 25 | 526 |
| 35 | 346 |
| 45 | 194 |

HE40
40° HIGH EFFICIENCY DIFFUSED LENS

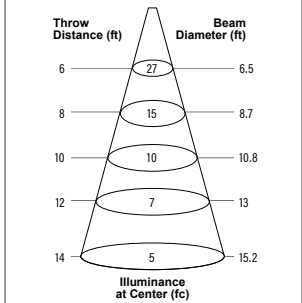

| WATTS: 17 | LPW: 63.5 |
|--------------|------------|
| LUMENS: 1079 | CCT: 3000K |
| INTENSITY | |
| DEGREE | CANDELA |
| 0 | 969 |
| 5 | 948 |
| 15 | 799 |
| 25 | 579 |
| 35 | 296 |
| 45 | 97 |

HE55
55° HIGH EFFICIENCY DIFFUSED LENS

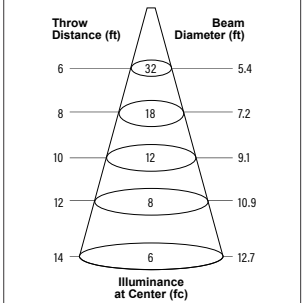

| WATTS: 17 | LPW: 62.6 |
|--------------|------------|
| LUMENS: 1065 | CCT: 3000K |
| INTENSITY | |
| DEGREE | CANDELA |
| 0 | 1153 |
| 5 | 1117 |
| 15 | 876 |
| 25 | 556 |
| 35 | 302 |
| 45 | 146 |

WH80
72° BRILLIANT WHITE WITH CLEAR LENS

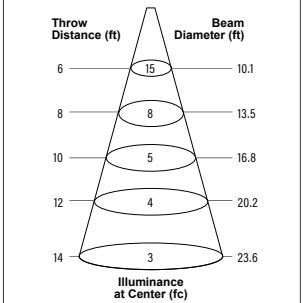

| WATTS: 17 | LPW: 63.5 |
|--------------|------------|
| LUMENS: 1079 | CCT: 3000K |
| INTENSITY | |
| DEGREE | CANDELA |
| 0 | 534 |
| 5 | 530 |
| 15 | 492 |
| 25 | 417.285 |
| 35 | 319 |
| 45 | 214 |

SS25
29° SEMI-SPECULAR WITH CLEAR LENS

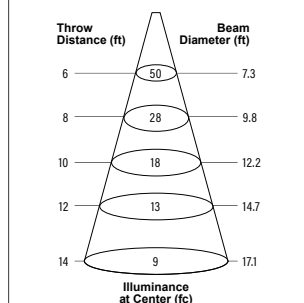

| WATTS: 39.4 | LPW: 58.5 |
|--------------|------------|
| LUMENS: 2305 | CCT: 3000K |
| INTENSITY | |
| DEGREE | CANDELA |
| 0 | 1815 |
| 5 | 1783 |
| 15 | 1550 |
| 25 | 1169 |
| 35 | 768 |
| 45 | 432.185 |

HE40
41° HIGH EFFICIENCY DIFFUSED LENS

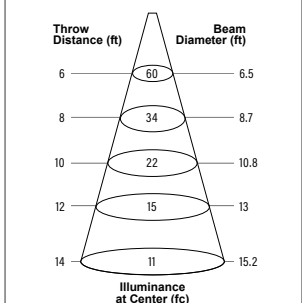

| WATTS: 39.4 | LPW: 60.1 |
|--------------|------------|
| LUMENS: 2366 | CCT: 3000K |
| INTENSITY | |
| DEGREE | CANDELA |
| 0 | 2154 |
| 5 | 2106 |
| 15 | 1775 |
| 25 | 1286 |
| 35 | 658 |
| 45 | 215 |

HE55
58° HIGH EFFICIENCY DIFFUSED LENS

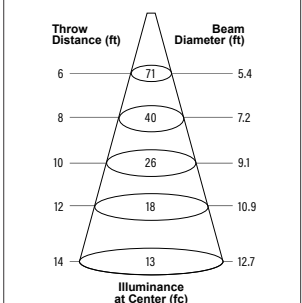

| WATTS: 39.4 | LPW: 60.4 |
|--------------|------------|
| LUMENS: 2379 | CCT: 3000K |
| INTENSITY | |
| DEGREE | CANDELA |
| 0 | 2562 |
| 5 | 2483 |
| 15 | 1948 |
| 25 | 1235 |
| 35 | 671.605 |
| 45 | 324 |

WH80
73° BRILLIANT WHITE WITH CLEAR LENS

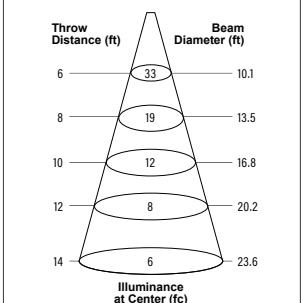

| WATTS: 39.4 | LPW: 60.8 |
|--------------|------------|
| LUMENS: 2394 | CCT: 3000K |
| INTENSITY | |
| DEGREE | CANDELA |
| 0 | 1186 |
| 5 | 1179 |
| 15 | 1093 |
| 25 | 927.3 |
| 35 | 710 |
| 45 | 476 |

alphabet

| PROJECT INFORMATION | | |
|---------------------|--|------|
| JOB NAME | | TYPE |
| ORDERING CODE | | |

MOUNTING OPTIONS

FIXTURE HEIGHT

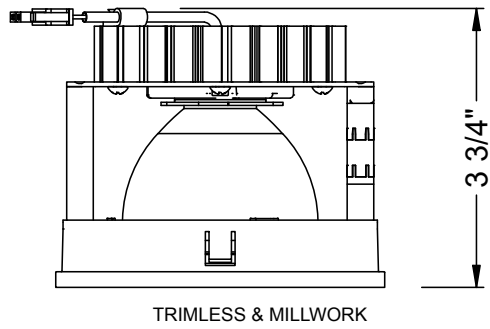
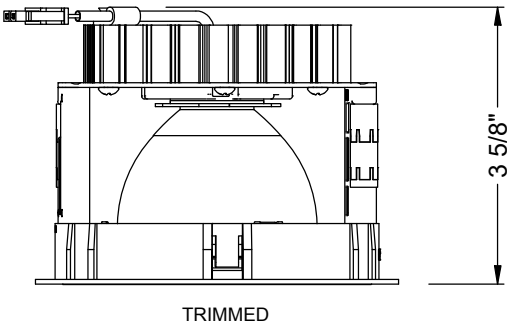

NC - NEW CONSTRUCTION

TRIM

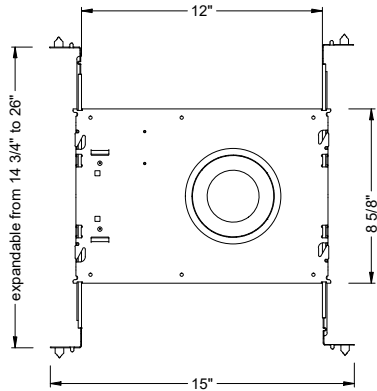
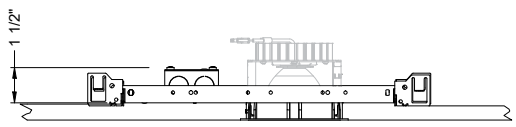

TRIM

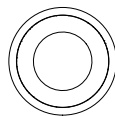

ceiling cutout
4-3/8" diameter
ceiling thickness
1/8" to 1-5/8"

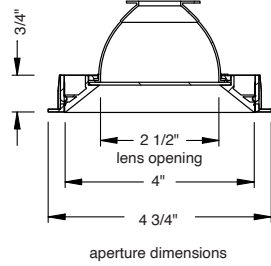

TRIMLESS

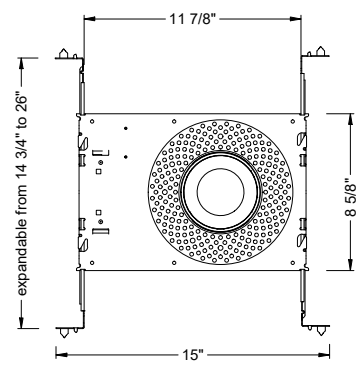
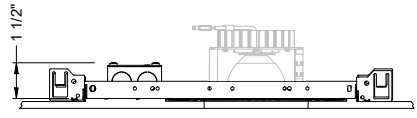

TRIMLESS

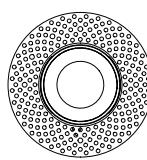

ceiling cutout
4-1/2" diameter
ceiling thickness
3/8" to 1-3/4"

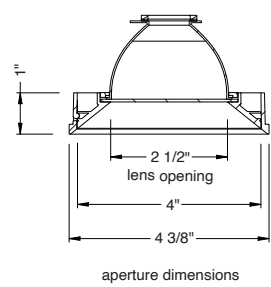

TRIMLESS/MILLWORK

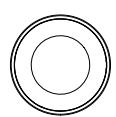

ceiling cutout
4-3/8" diameter
ceiling thickness
1/2" to 1-3/4"

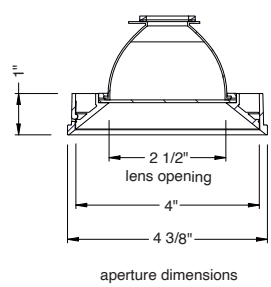

| PROJECT INFORMATION | | |
|---------------------|--|------|
| JOB NAME | | TYPE |
| ORDERING CODE | | |

MOUNTING OPTIONS (CONTINUED)

RET - RETRO TRIM/TRIMLESS

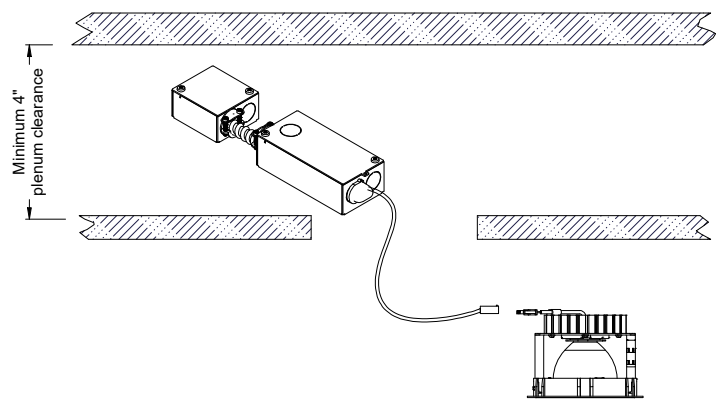

IC - INSULATION CONTACT HOUSING

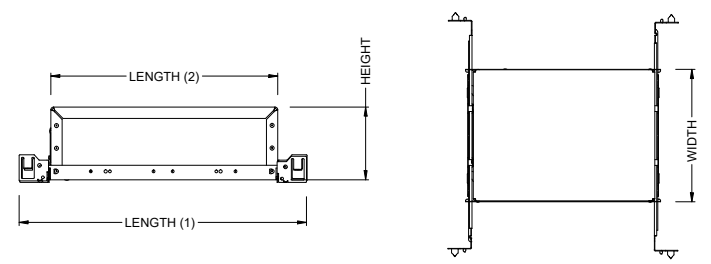

| BOX SIZE | L 1 | L 2 | W | H |
|----------|------------|-----------|----------|----------|
| A | 15 - 7/16" | 11 - 3/4" | 8 - 1/2" | 3 - 3/4" |

| RATINGS / CERTIFICATIONS | NC | RET | IC |
|---------------------------------------|----|-----|----|
| TYPE NON-IC | ✓ | ✓ | |
| TYPE IC | | | ✓ |
| CHICAGO PLENUM (CCEA) | | | |
| SUITABLE FOR AIR HANDLING PLENUMS | ✓ | ✓ | ✓ |
| REDUCED AIRFLOW (WITH LENS) ASTM E283 | ✓ | ✓ | ✓ |

| BOX TYPE / LUMEN OUTPUT - STANDARD BEAMS (25° - 80°) | |
|--|---------|
| LUMEN OUTPUT | BOX - A |
| | IC |
| 10LM | ✓ |
| 13LM | ✓ |
| 20LM | ✓ |
| 30LM | |

| CEILING THICKNESS | |
|---------------------|----------------------------|
| FIXTURE TYPE | MOUNTING TYPE |
| | |
| | STANDARD CEILING THICKNESS |
| TRIM | 1/8" to 1-5/8" |
| TRIMLESS | 3/8" to 1-3/4" |
| MILLWORK (TRIMLESS) | 1/2" to 1-3/4" |

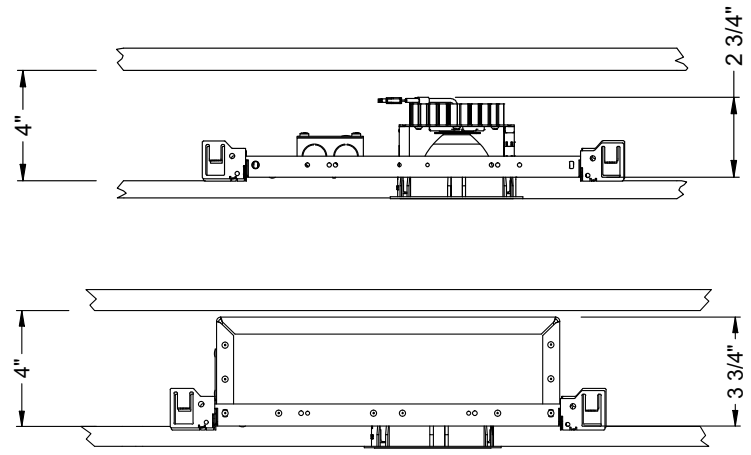

| PROJECT INFORMATION | | |
|---------------------|--|------|
| JOB NAME | | TYPE |
| ORDERING CODE | | |

BATTERY OPTIONS

EMERGENCY BATTERY

IOTA's ILB Battery Backups are UL Listed LED emergency drivers that allow the same LED fixture to be used for both normal and emergency operation. In the event of a power failure, the ILB switches to the emergency mode and operates the existing fixture for 90 minutes. The unit contains a battery, charger, and converter circuit in a single can. The Constant Power design of the ILB maintains the output wattage to the LED array even as the system voltage diminishes. UL 924 Listed for U.S. and Canada. UL 1310 Certified, Output Class 2 Compliant. Includes single-piece TBTS test switch and charge indicator accessory kit. For use with switched and unswitched electric fixtures, and includes Two-wire universal AC input. Meets or exceeds all National Electric Code and Life Safety Code Emergency Lighting Requirements. Rated for use in Plenum, Damp Location, Recessed Type IC, and Enclosed and Gasketed Luminares.

REMOTE TEST SWITCH

The Remote Test Switch may be mounted adjacent to the LED Fixture by others.

EMERGENCY BATTERY ACCESS

Above ceiling access is required for service. An access panel in the ceiling (or other form of access) adjacent to the installation location of the Emergency Battery is required.

REMOTE LOCATION

Maximum remote mounting distance of the emergency driver shall be 50 feet. Remote location wiring provided by others. Follow all Local and National Electric/Building Codes.

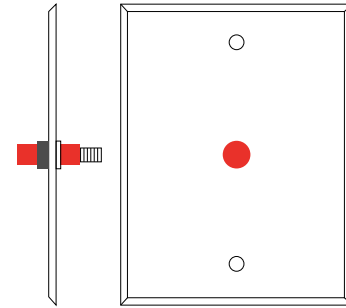

Remote Test Switch

EM MODE OUTPUT (DELIVERED LUMENS)

| LUMEN ORDERING CODE | EM7 | EM10 | EM12 |
|----------------------------|-------|-------|-------|
| ALL OPTIONS (10LM TO 20LM) | 430LM | 611LM | 734LM |

Notes: Based on 30K, 97CRI

NC - NEW CONSTRUCTION WITH EM BATTERY (REMOTE TEST SWITCH)

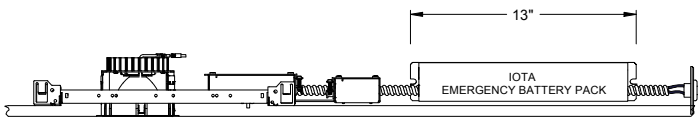

IC / ICAT - INSULATION CONTACT HOUSING WITH EM BATTERY (REMOTE TEST SWITCH)

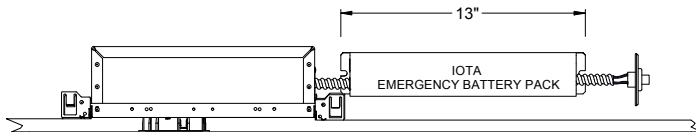

RET - RETROFIT WITH EM BATTERY (REMOTE TEST SWITCH)

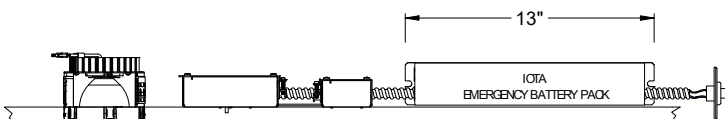

Accessory

76066 Optional T-Grid Mounting Kit²

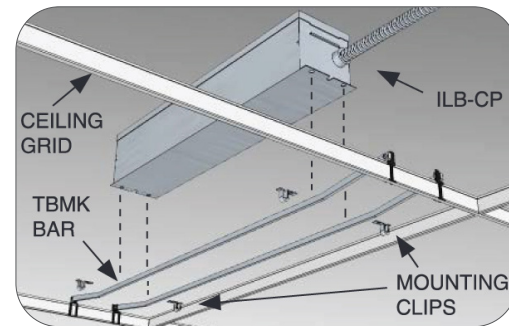

2. Can be used with any of the Emergency Battery Backups. Must be ordered as a separate line item.